



For Lease | Light Industrial Space

# Altamont Business Centre



Contact Brokers

**Michael Carrigg, SIOR**

Executive Managing Director  
CA License No. 01298928  
michael.carrigg@colliers.com  
+1 925 227 6220

**Michael Donnelly, SIOR**

Senior Vice President  
CA License No. 01402626  
michael.donnelly@colliers.com  
+1 925 227 6241

# Features

- A seven-building ±151,139 SF light industrial campus off of Vasco Road
- Easy access to I-580
- Close to retail amenities
- Dock and grade level loading
- Tenant improvement dollars available
- Estimated operating expenses: \$0.364
- Flexible lease terms



Additional Parking Stalls Available for Lease

*\*Ancillary paved parking lot with additional car and truck parking available for rent*

This document has been prepared by Colliers for advertising and general information only. Colliers makes no guarantees, representations or warranties of any kind, expressed or implied, regarding the information including, but not limited to, warranties of content, accuracy and reliability. Any interested party should undertake their own inquiries as to the accuracy of the information. Colliers excludes unequivocally all inferred or implied terms, conditions and warranties arising out of this document and excludes all liability for loss and damages arising there from. This publication is the copyrighted property of Colliers and /or its licensor(s). © 2026. All rights reserved. This communication is not intended to cause or induce breach of an existing listing agreement. June 2026



# Availabilities

Additional Parking Stalls Available for Lease

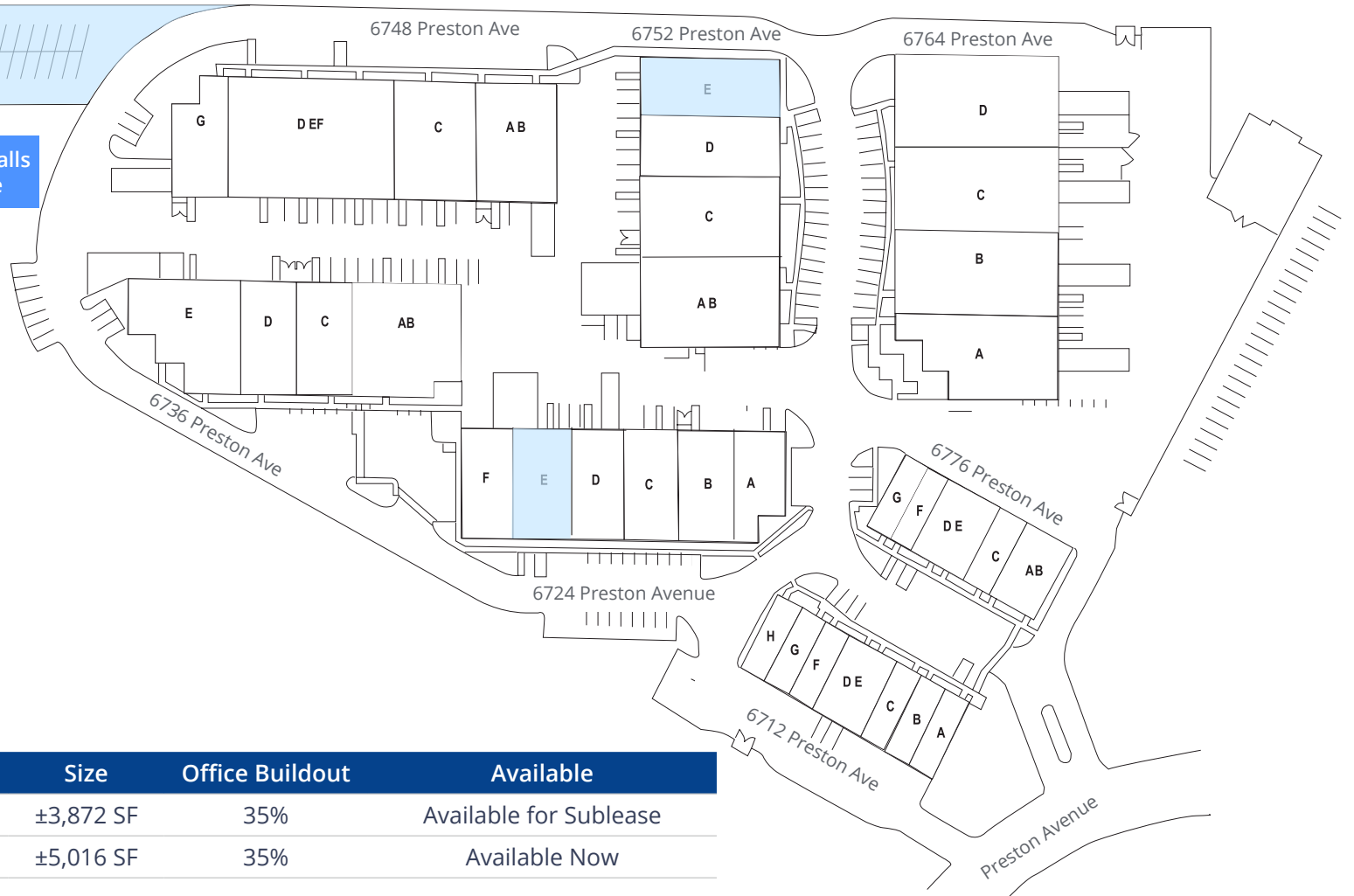

## For Lease

Address	Suite	Size	Office Buildout	Available
6724 Preston Ave.	E	±3,872 SF	35%	Available for Sublease
6752 Preston Ave.	E	±5,016 SF	35%	Available Now

# Floor Plan

6724 Preston Avenue  
Suite E

- ±3,872 SF
- Available Now
- For sublease through 10/31/2028.  
Longer term direct deal may be possible.

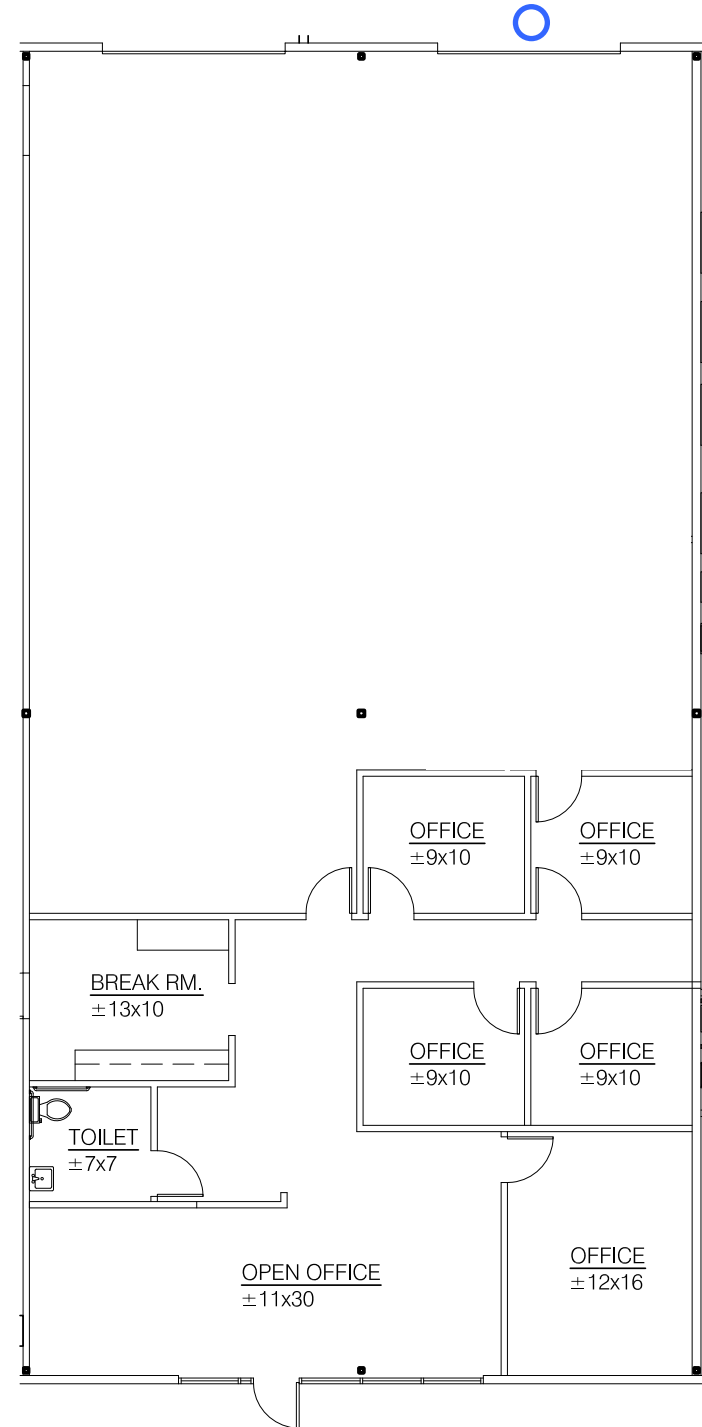

 Grade Level Door

 Dock High Door

# Floor Plan

6752 Preston Avenue  
Suite E

- ±5,016 SF
- Available Now



 Grade Level Door

