

±7,420 SF (DIVISIBLE) FOR LEASE

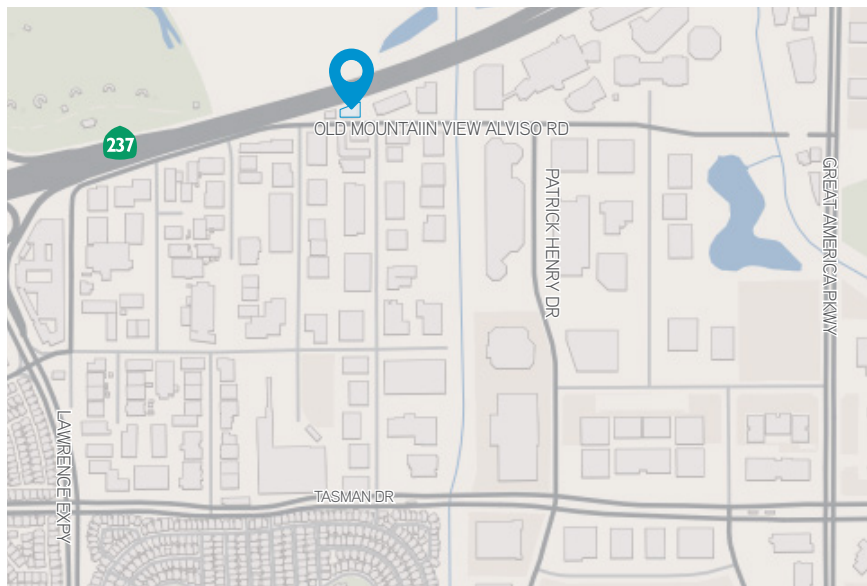

## 1245 Old Mountain View Alviso Rd, Sunnyvale | CA



- 7,420 SF (Divisible to 2,360 SF & 5,060 SF)
- Stand Alone Identity
- 3 Grade Level Doors
- Parking: 2.4/1,000
- 2-400 Amp @ 240 Volt Panels
- Fenced Equipment Pad
- Desirable Sunnyvale Location
- Excellent Access to HWYs 101 & 237
- Call For Pricing & Touring Instruction

### Frank Friedrich

Senior Vice President

+1 408 282 3813

frank.friedrich@colliers.com

Lic. No. CA-01159876

### Mike Covell

Associate

+1 408 282 3917

mike.covell@colliers.com

Lic. No. CA-02040499

**Colliers International**  
450 West Santa Clara Street  
San Jose, CA 95113  
P: +1 408 282 3800



## Site Plan

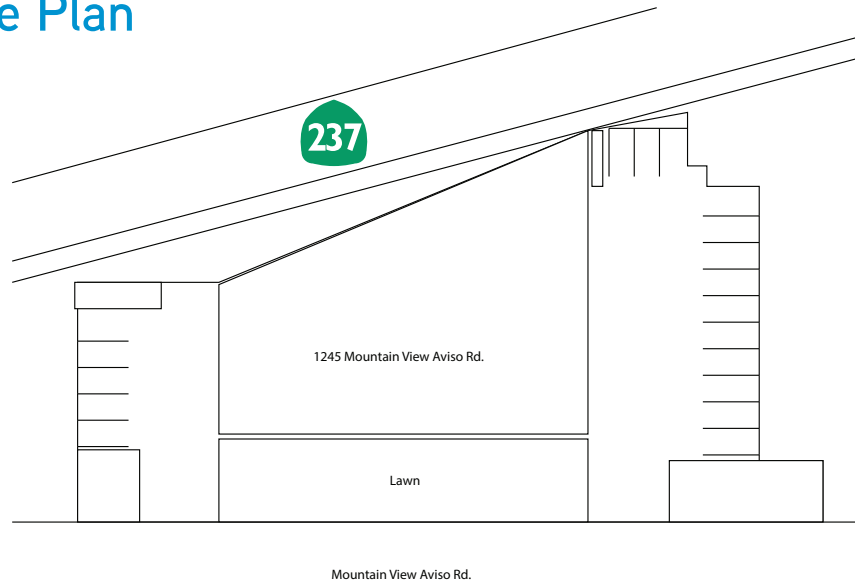

## Floor Plan

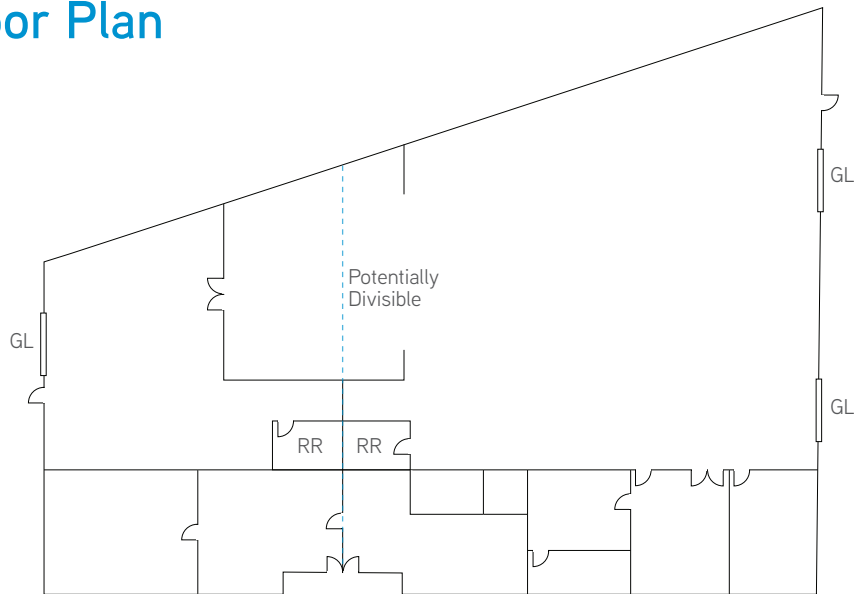

**Frank Friedrich**  
Senior Vice President  
+1 408 282 3813  
frank.friedrich@colliers.com  
Lic. No. CA-01159876

**Mike Covell**  
Associate  
+1 408 282 3917  
mike.covell@colliers.com  
Lic. No. CA-02040499



Colliers International  
450 West Santa Clara Street  
San Jose, CA 95113  
P: +1 408 282 3800

