

CHANDLER MEDICAL BUILDING  
FOR SUBLEASE  
827 - 1,755 SF

485 S Dobson Rd  
CHANDLER, AZ



## Property Features

- Two spaces available: 827 SF and 928 SF, contiguous to 1,755 SF
- Termination date is January 31, 2022
- Must be a medical use

## Amenities Within a 1-Mile Radius

- Chandler Regional Medical Center
- Chandler Fashion Square
- Loop 101 and Loop 202

**\$13.00**  
PER SF NNN



MATT FITZ-GERALD  
602 222 5178  
[matt.fitz-gerald@colliers.com](mailto:matt.fitz-gerald@colliers.com)



COLLIERS INTERNATIONAL  
2390 E. Camelback Rd, Suite 100  
Phoenix, AZ 85016  
[www.colliers.com/greaterphoenix](http://www.colliers.com/greaterphoenix)

# 485 S Dobson Rd

CHANDLER, AZ

SUITE 206: 827 SF  
SUITE 208: 928 SF  
CONTIGUOUS TO 1,755 SF

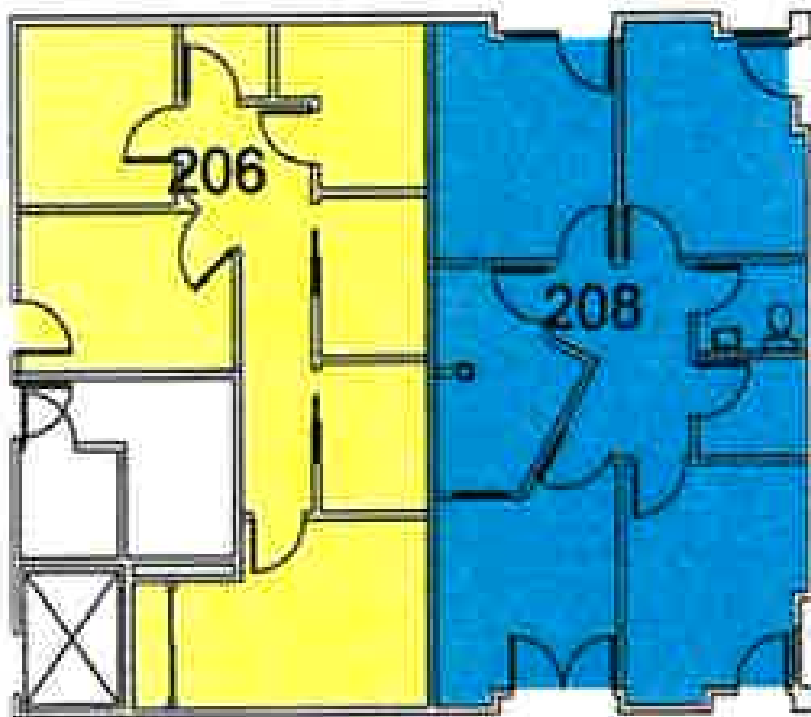

COLLIERS INTERNATIONAL  
2390 E. Camelback Rd, Suite 100  
Phoenix, AZ 85016  
[www.colliers.com/greaterphoenix](http://www.colliers.com/greaterphoenix)







# 485 S Dobson Rd

CHANDLER, AZ

CHANDLER MEDICAL BUILDING  
FOR SUBLEASE  
827 - 1,755 SF

**\$13.00**  
PER SF NNN

MATT FITZ-GERALD  
602 222 5178  
[matt.fitz-gerald@colliers.com](mailto:matt.fitz-gerald@colliers.com)

This document/email has been prepared by Colliers International for advertising and general information only. Colliers International makes no guarantees, representations or warranties of any kind, expressed or implied, regarding the information including, but not limited to, warranties of content, accuracy and reliability. Any interested party should undertake their own inquiries as to the accuracy of the information. Colliers International excludes unequivocally all inferred or implied terms, conditions and warranties arising out of this document and excludes all liability for loss and damages arising there from. This publication is the copyrighted property of Colliers International and /or its licensor(s). © 2018. All rights reserved.

COLLIERS INTERNATIONAL  
2390 E. Camelback Rd, Suite 100  
Phoenix, AZ 85016  
[www.colliers.com/greaterphoenix](http://www.colliers.com/greaterphoenix)

