

Delta Business Park

VERNE ROBERTS CIRCLE AT WEST 10TH STREET, ANTIOCH CA



Only A Few Spaces Remaining!

Freestanding buildings & Commercial Condominiums

- > Turn-Key units available now!
- > Zoned M-I, flexible zoning includes Commercial, Office R&D, Light Industrial, Manufacturing and Warehouse
- > Excellent freeway access to Highway 4
- > Located adjacent to Century Plaza Shopping Center and across the street from Costco
- > Existing companies in the Delta Business Park include Costco, State Farm & Abbey Carpet

Small & Large Buildings For Sale or Lease

The Delta Business Park is a mixed use master planned development located near the intersection of the Highway 4 and Somersville Road in Eastern Contra Costa County. The Park offers an excellent location for light industrial, wholesale, assembly, research & development, back offices, manufacturing and distribution uses. Delta Business Park offers the unique opportunities for small businesses to customize their individual spaces.

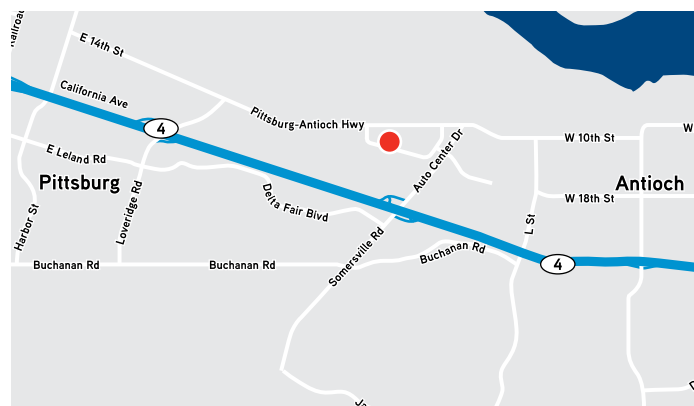

Contact Information

BILL HILLIS SIOR
+1 925 279 5578
bill.hillis@colliers.com
license 01262007

CURT D. SCHEVE SIOR
+1 925 279 5593
curt.scheve@colliers.com
license 00916122



Information contained herein has been obtained from the owners or from other sources deemed reliable. We have no reason to doubt its accuracy but regret we cannot guarantee it. All properties subject to change or withdrawal without notice.

FOR SALE OR LEASE > CUSTOM INTERIOR IMPROVEMENTS TO SUIT

Delta Business Park



VERNE ROBERTS CIRCLE AT WEST 10TH STREET, ANTIOCH CA

WEST TENTH STREET

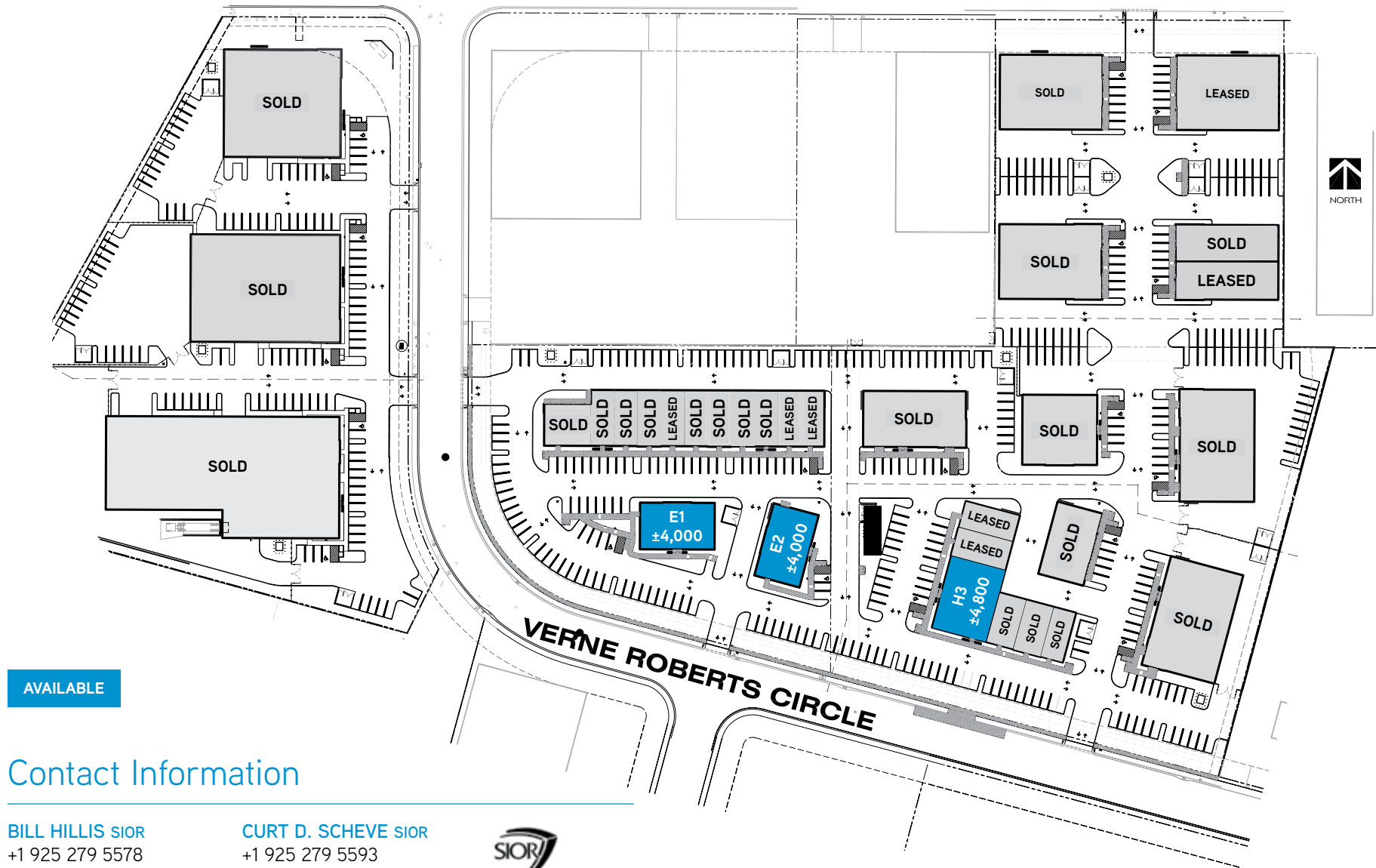

AVAILABLE

Contact Information

BILL HILLIS SIOR
+1 925 279 5578
bill.hillis@colliers.com
license 01262007

CURT D. SCHEVE SIOR
+1 925 279 5593
curt.scheve@colliers.com
license 00916122



FOR SALE OR LEASE > CUSTOM INTERIOR IMPROVEMENTS TO SUIT

Delta Business Park

VERNE ROBERTS CIRCLE AT WEST 10TH STREET, ANTIOCH CA

Building E1 - 2616 Verne Roberts Circle

AVAILABLE FOR IMMEDIATE OCCUPANCY. ADDITIONAL INTERIOR IMPROVEMENTS TO SUIT.

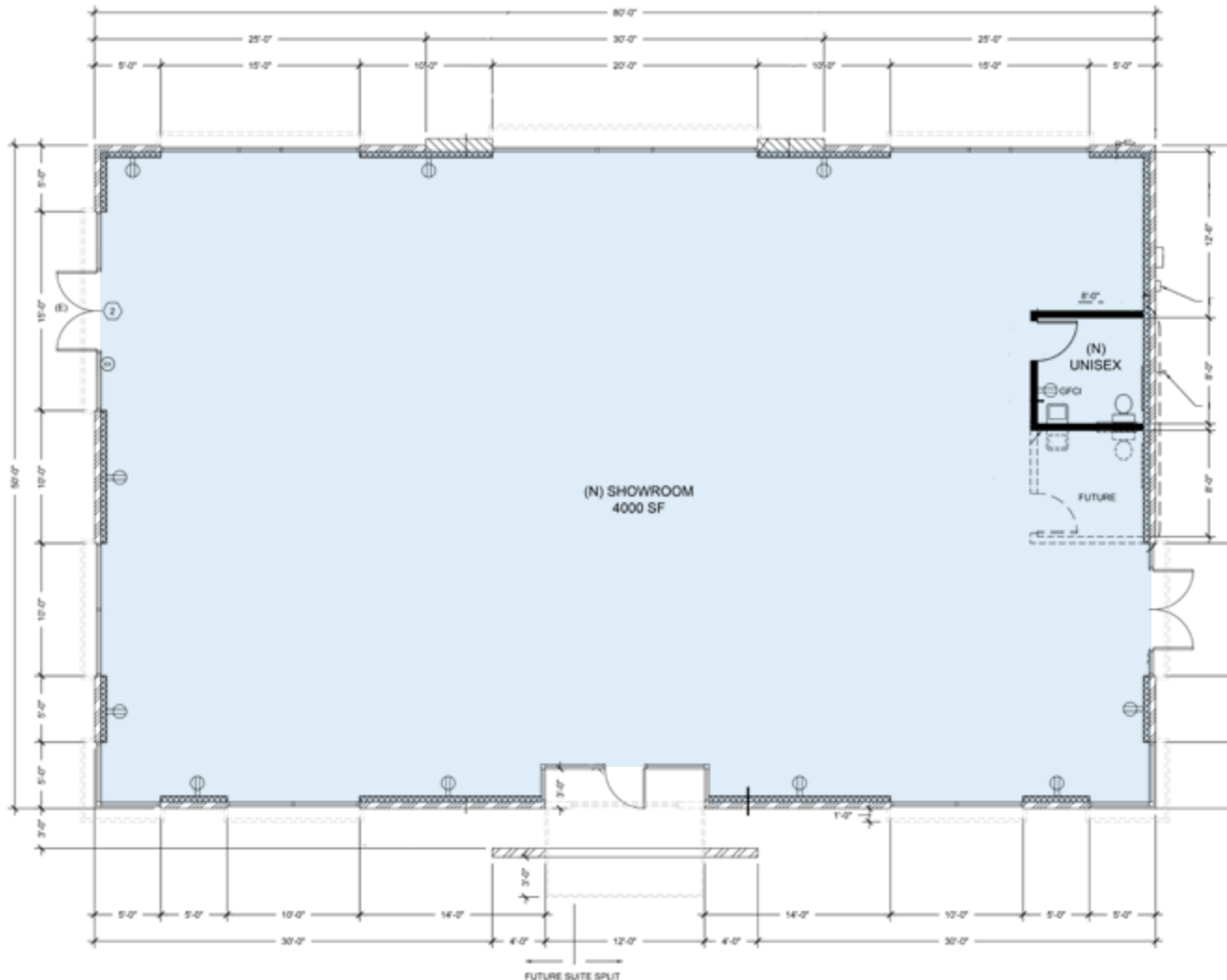

Contact Information

BILL HILLIS SIOR

+1 925 279 5578

bill.hillis@colliers.com

license 01262007

CURT D. SCHEVE SIOR

+1 925 279 5593

curt.scheve@colliers.com

license 00916122



Colliers International
1850 Mt. Diablo Blvd
Suite 200
Walnut Creek, CA 94596
+1 925 279 0120 phone
+1 925 279 0450 fax
www.colliers.com

Delta Business Park

VERNE ROBERTS CIRCLE AT WEST 10TH STREET, ANTIOCH CA



Building H3 - 2516 Verne Roberts Circle

AVAILABLE FOR IMMEDIATE OCCUPANCY. ADDITIONAL INTERIOR IMPROVEMENTS TO SUIT.

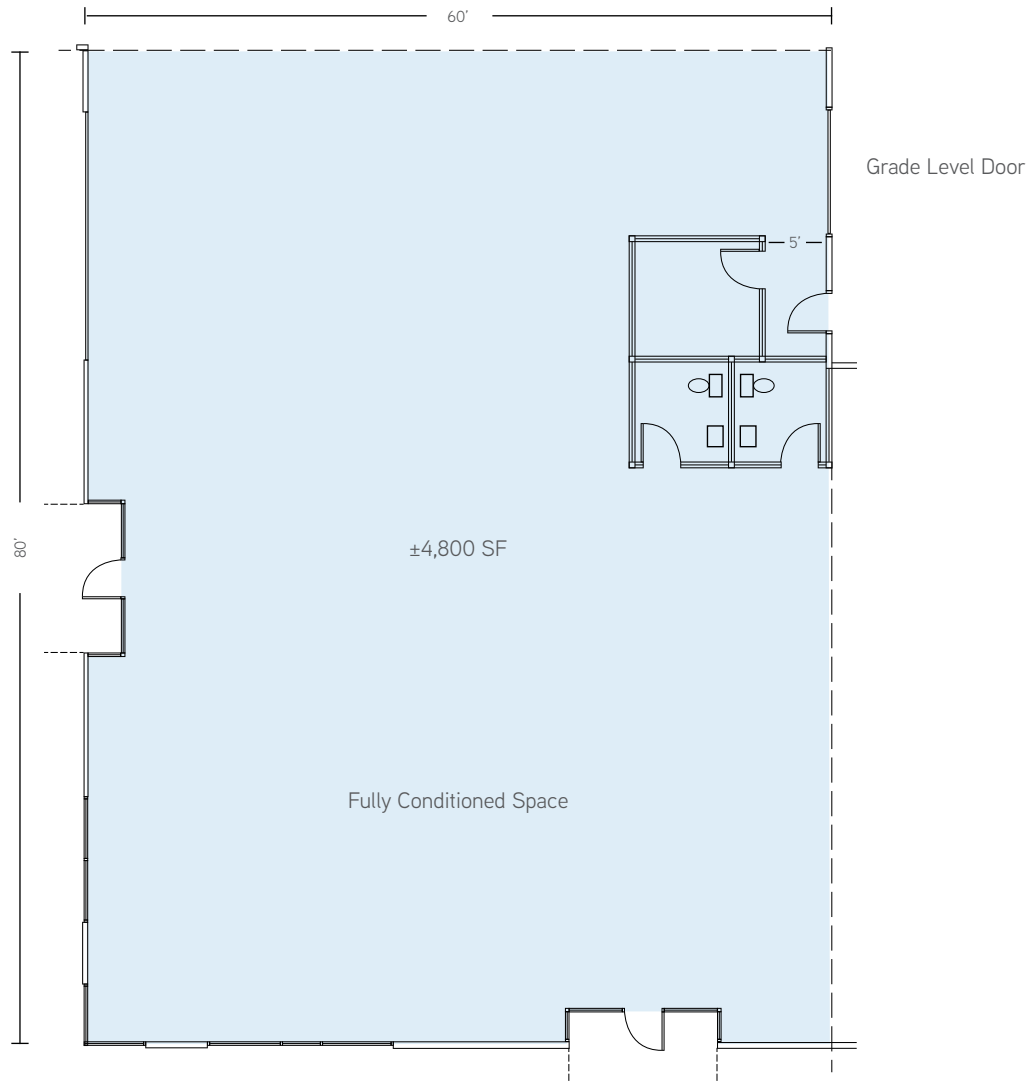

Contact Information

BILL HILLIS SIOR

+1 925 279 5578

bill.hillis@colliers.com

license 01262007

CURT D. SCHEVE SIOR

+1 925 279 5593

curt.scheve@colliers.com

license 00916122



Colliers International
1850 Mt. Diablo Blvd
Suite 200
Walnut Creek, CA 94596
+1 925 279 0120 phone
+1 925 279 0450 fax
www.colliers.com