

FOR LEASE > HILLSBORO OFFICE PARK



# Hawthorn Woods Office Park

5625 NE ELAM YOUNG PARKWAY HILLSBORO, OREGON 97124



## Property Details

- Approximately 12,000 SF free-standing office/flex building situated on 1.02 acres
- 63% leased by 3 tenants, current vacancy is:
  - Suite 400 - 4,465 SF
- Located within walking distance of numerous restaurants and amenities of award-winning Orenco Station
- Located a short walk from MAX light rail at Hawthorn Farm Station
- Station Community Business Park (SCBP) Zoning allows a variety of commercial uses, including:
  - General Office - including medical and dental
  - Light Industrial - including R&D and testing labs
  - Church, Public Assembly, Indoor Recreation
- **Call for Rates**

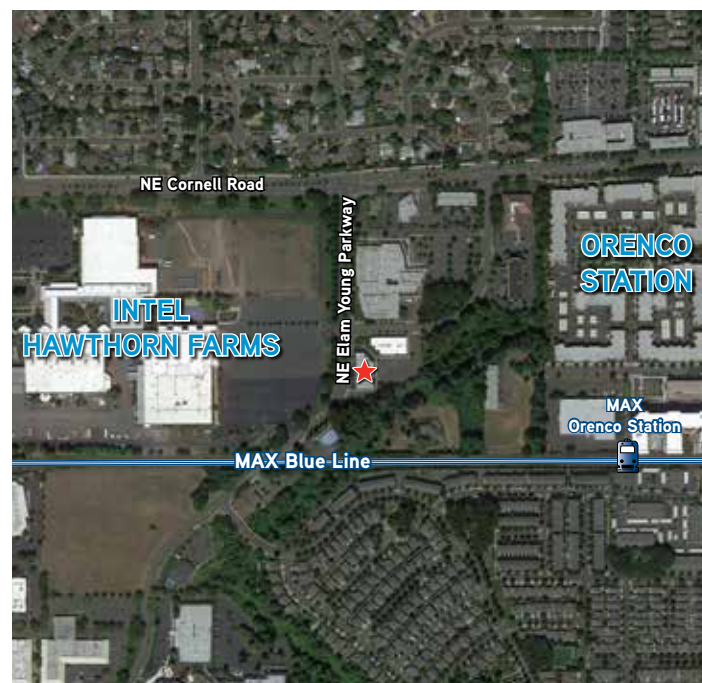

Mike Thomas  
Senior Vice President  
Portland, Oregon  
+1 503 499 0059  
[mike.thomas@colliers.com](mailto:mike.thomas@colliers.com)

COLLIERS INTERNATIONAL  
851 SW Sixth Avenue  
Suite 1200  
Portland, Oregon 97204  
[www.colliers.com/portland](http://www.colliers.com/portland)



FOR LEASE > HILLSBORO OFFICE PARK

# Hawthorn Woods Office Park

5625 NE ELAM YOUNG PARKWAY HILLSBORO, OREGON 97124

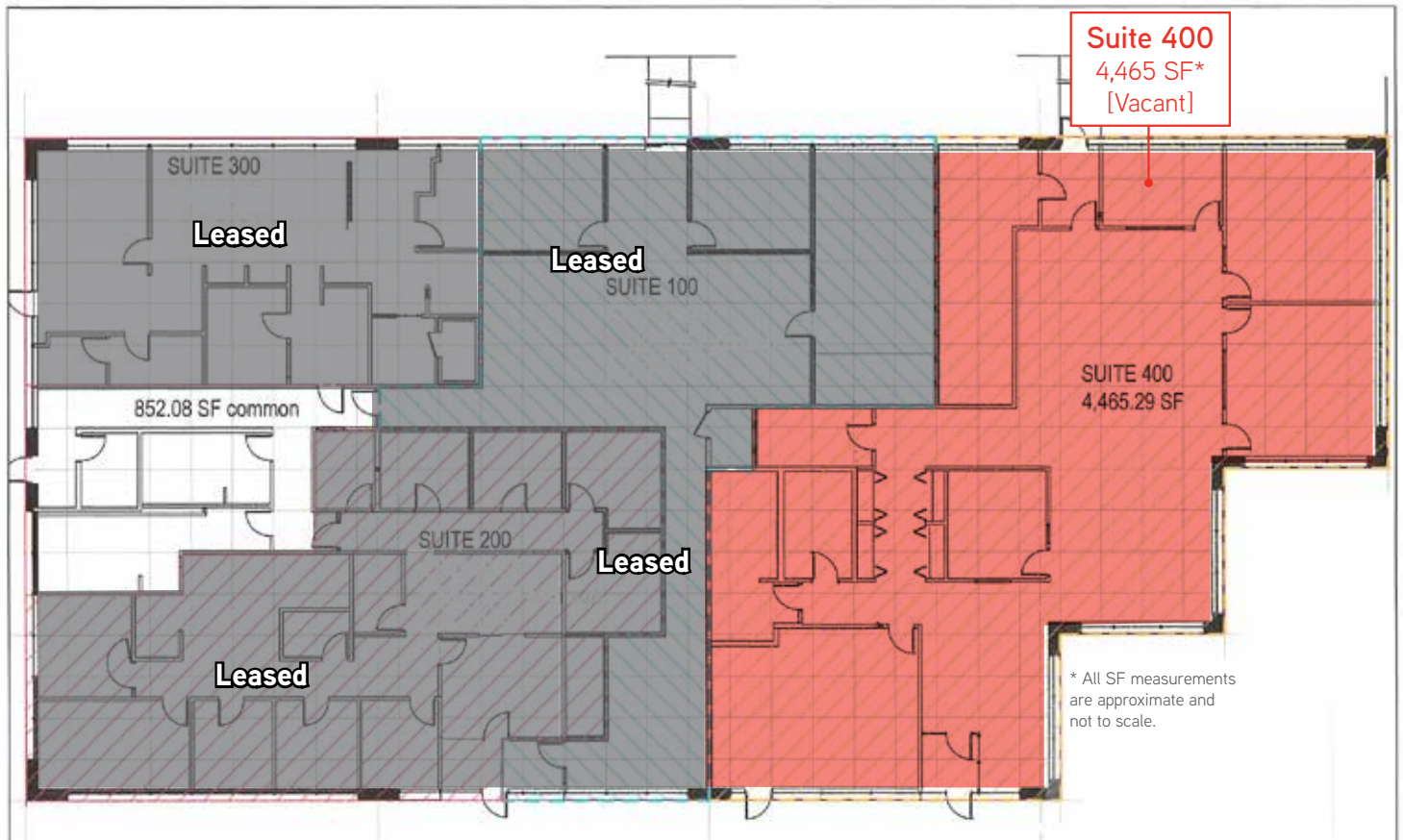

This document has been prepared by Colliers International for advertising and general information only. Colliers International makes no guarantees, representations or warranties of any kind, expressed or implied, regarding the information including, but not limited to, warranties of content, accuracy and reliability. Any interested party should undertake their own inquiries as to the accuracy of the information. Colliers International excludes unequivocally all inferred or implied terms, conditions and warranties arising out of this document and excludes all liability for loss and damages arising there from. This publication is the copyrighted property of Colliers International and/or its licensor(s). ©2017. All rights reserved.

**Colliers**  
INTERNATIONAL