



PAUL HOLLAND  
Vice President  
+1 602 222 5055  
paul.holland@colliers.com

COLLIERS INTERNATIONAL  
2390 E Camelback Road  
Suite 100  
Phoenix, AZ 85016  
www.colliers.com/greaterphoenix

# Denaro Village Shopping Center

20197-20199 N 67TH AVENUE, GLENDALE, AZ

Property Size:	33,186 SF	DEMOGRAPHICS	1 Mile	3 Miles	5 Miles
Available:	1,110 SF & 1,829 SF	2016 Total Population	16,142	94,689	268,962
Zoning:	C-2, City of Glendale	2021 Total Population	17,410	102,438	292,114
Comments:	Located in an affluent north Glendale neighborhood. Strong retail intersection with easy access off the Loop 101.	2016 Median Income	\$82,582	\$74,361	\$67,650
		2021 Median Income	\$86,373	\$78,484	\$71,491



# Denaro Village Shopping Center

20197-20199 N 67TH AVENUE, GLENDALE, AZ

## Denaro Village Shopping Center

6681 Beardsley  
6685 Beardsley, Suites 100-275  
20197-20199 N. 67th Avenue  
Glendale, Az 85308  
GLA: 33,186

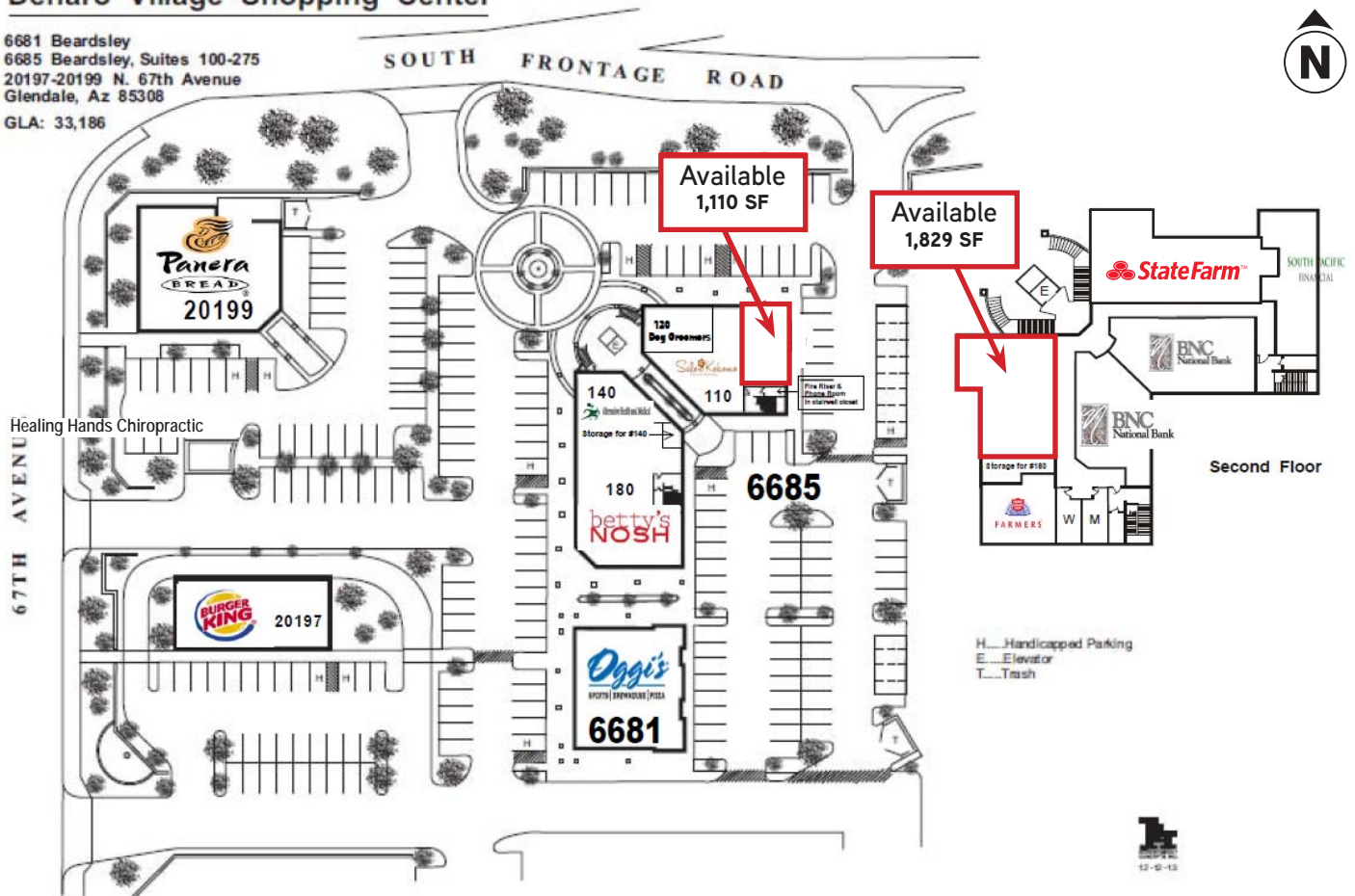

### CONTACT:

PAUL HOLLAND

Vice President

+1 602 222 5055

[paul.holland@colliers.com](mailto:paul.holland@colliers.com)



This document/email has been prepared by Colliers International for advertising and general information only. Colliers International makes no guarantees, representations or warranties of any kind, expressed or implied, regarding the information including, but not limited to, warranties of content, accuracy and reliability. Any interested party should undertake their own inquiries as to the accuracy of the information. Colliers International excludes unequivocally all inferred or implied terms, conditions and warranties arising out of this document and excludes all liability for loss and damages arising there from. This publication is the copyrighted property of Colliers International and/or its licensor(s). © 2017. All rights reserved. This communication is not intended to cause or induce breach of an existing listing agreement.

COLLIERS INTERNATIONAL  
2390 E Camelback Road  
Suite 100  
Phoenix, AZ 85016  
[www.colliers.com/greaterphoenix](http://www.colliers.com/greaterphoenix)