



› FOR LEASE

ALISO VIEJO PROFESSIONAL CENTER

15 Mareblu, Aliso Viejo

FOR MORE DETAILS, CONTACT:

AARON PHILLIPS

949 724 5562

aaron.phillips@colliers.com

JOHN WADSWORTH

949 724 5528

john.wadsworth@colliers.com

15 Mareblu • Aliso Viejo

Three-Story, Elevator-Served, Medical Office Building

PROPERTY HIGHLIGHTS

- › Anchored by Memorial Care Medical Group
- › Established Medical Area
- › Parking Ratio 6:1,000
- › Rental Concessions on New 3 Year Transactions
- › Aggressive Market Lease Rates

Suites Available:

Suite 200	1,790 Sq. Ft.
Suite 250	1,267 Sq. Ft.
Suite 340	1,605 Sq. Ft.

DEMOGRAPHICS

Demographics within a 3 mile radius of 15 Mareblu are favorable for future MOB tenant demand:

- › Population Of Approximately 140,000
- › 12.56% Of Population Older Than 55 Years Of Age
- › Average Household Income Of \$111K

LOCATION

15 Mareblu is situated within a small submarket of medical buildings located in the cities of Aliso Viejo & Laguna Hills.

15 Mareblu is a three story, 33,731 SF multi-tenant medical office building accessible (and visible) from the 73 toll road via La Paz Road and Oso Parkway exits.



15 Mareblu • Aliso Viejo



15 Mareblu • Aliso Viejo

SUITE 200

1,790 Sq. Ft.

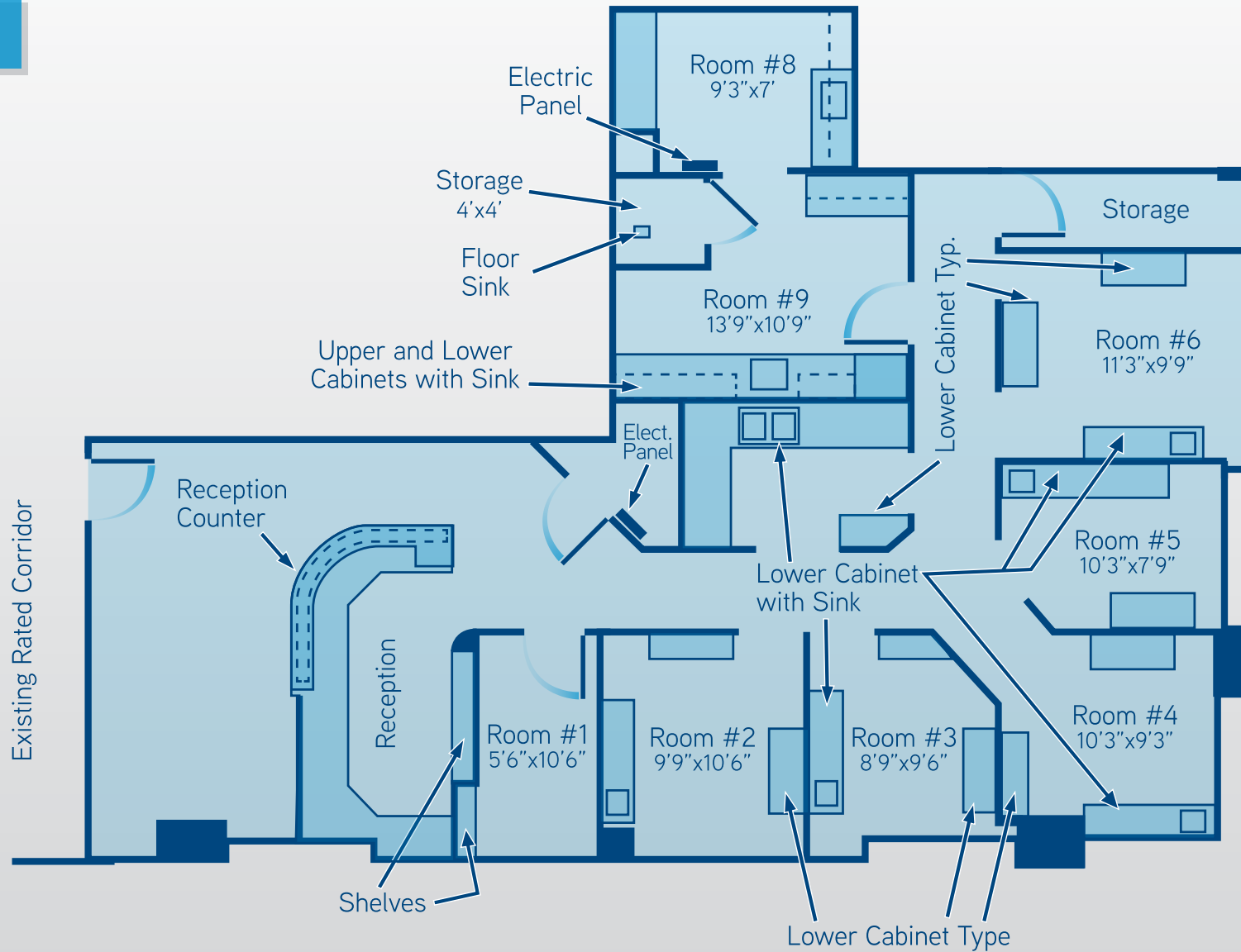

SUITE 250

1,267 Sq. Ft.

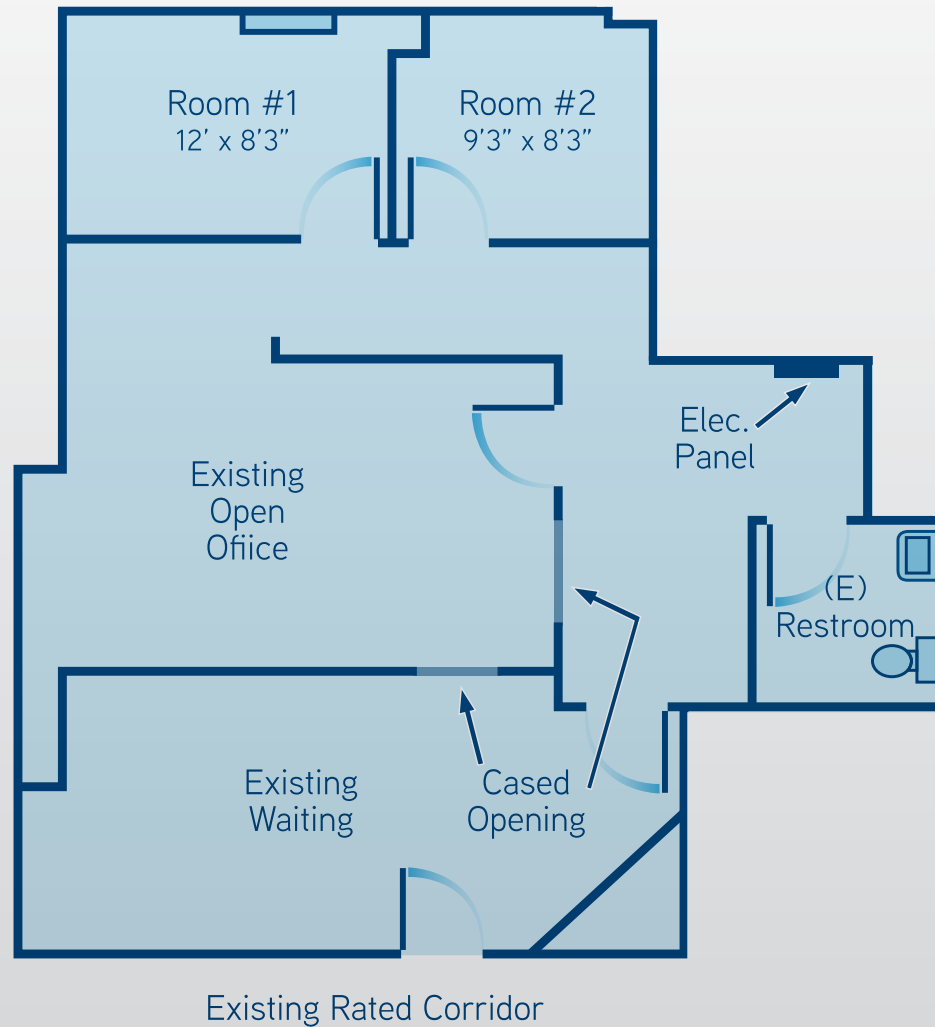

SUITE 340

1,605 Sq. Ft.

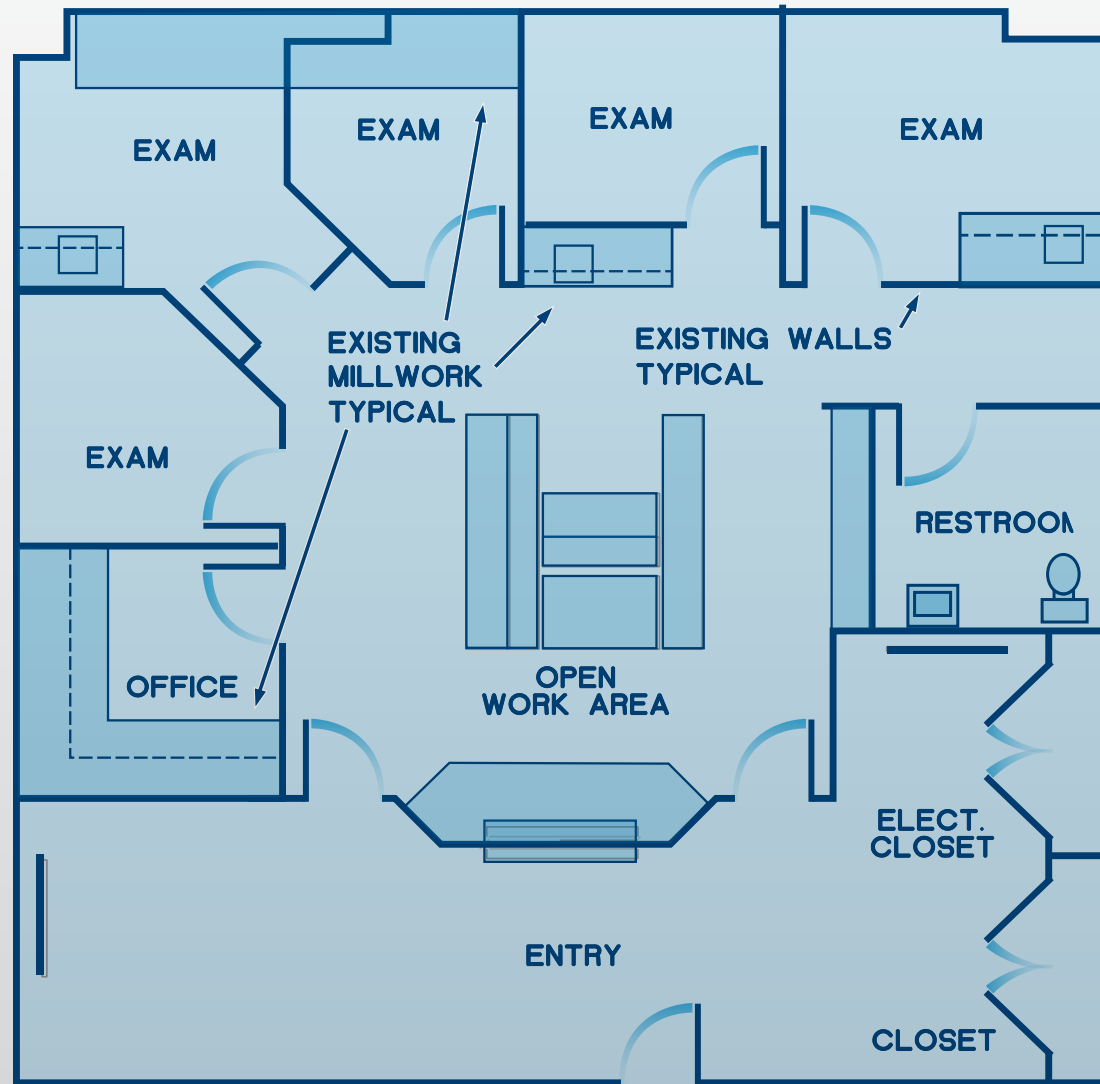



AARON PHILLIPS

949 724 5562

aaron.phillips@colliers.com

JOHN WADSWORTH

949 724 5528

john.wadsworth@colliers.com



Accelerating success.

Colliers International makes no guarantees, representations or warranties of any kind, expressed or implied, regarding the information including, but not limited to, warranties of content, accuracy and reliability.
This publication is the copyrighted property of Colliers International and /or its licensor(s). 2010. All rights reserved.