

# FOR SALE OR LEASE

2627 S 300 W | Salt Lake City, UT 84115



## AVAILABLE

19,210 SF | \$4,295,000 Sale  
\$1.40 PSF Lease

## HIGHLIGHTS

- Office: 3,135 SF
- Showroom: 2,800 SF
- 50 Parking Stalls
- TOD (Transit Oriented Development) Zoning
- 600 Amps, 280v/3-Phase Power
- 12 Grade Level Doors (12'x12')
- Secured Yard
- High Visibility
- LED Lighting
- Updated Insulation
- 1.21 Acres
- **AVAILABLE JULY 1, 2026**

## CONTACT US

### JEREMY TERRY

Vice President

801 671 9349

[jeremy.terry@colliers.com](mailto:jeremy.terry@colliers.com)

### SKYLER SMITH

Senior Associate

801 946 6423

[skylersmith@colliers.com](mailto:skylersmith@colliers.com)



Accelerating success.

**SITE PLAN**

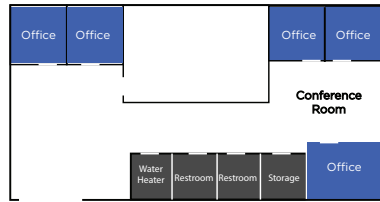
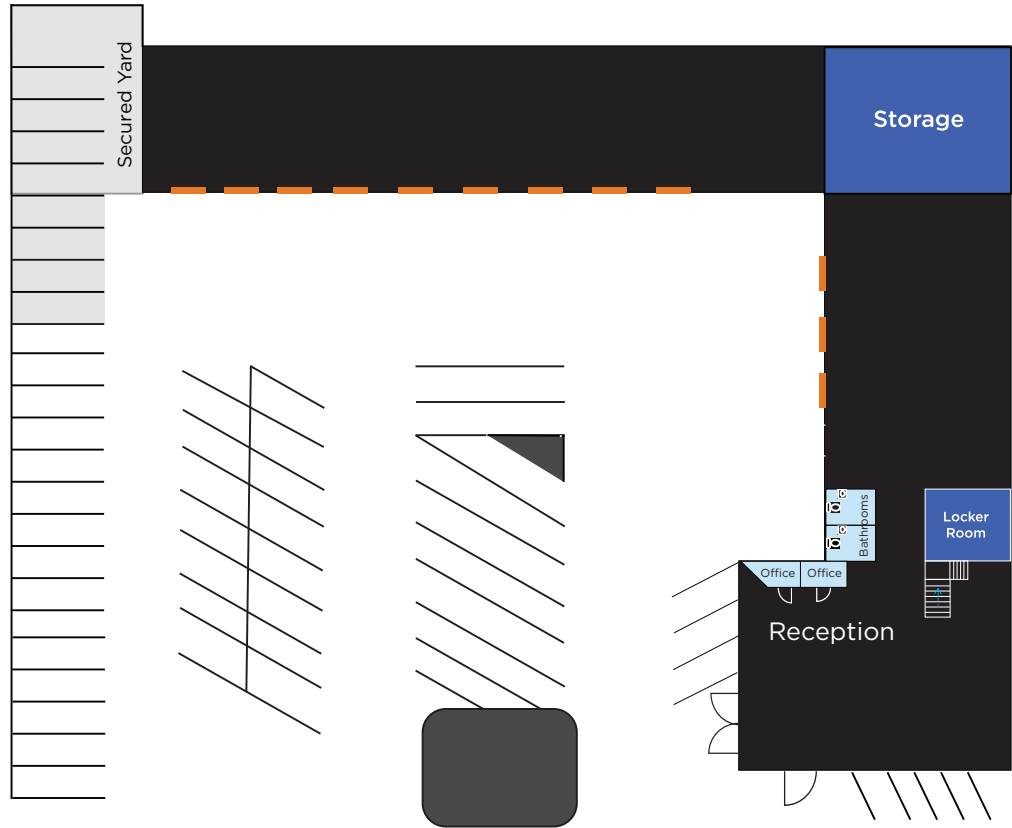

**Grade Level Doors**



300 WEST



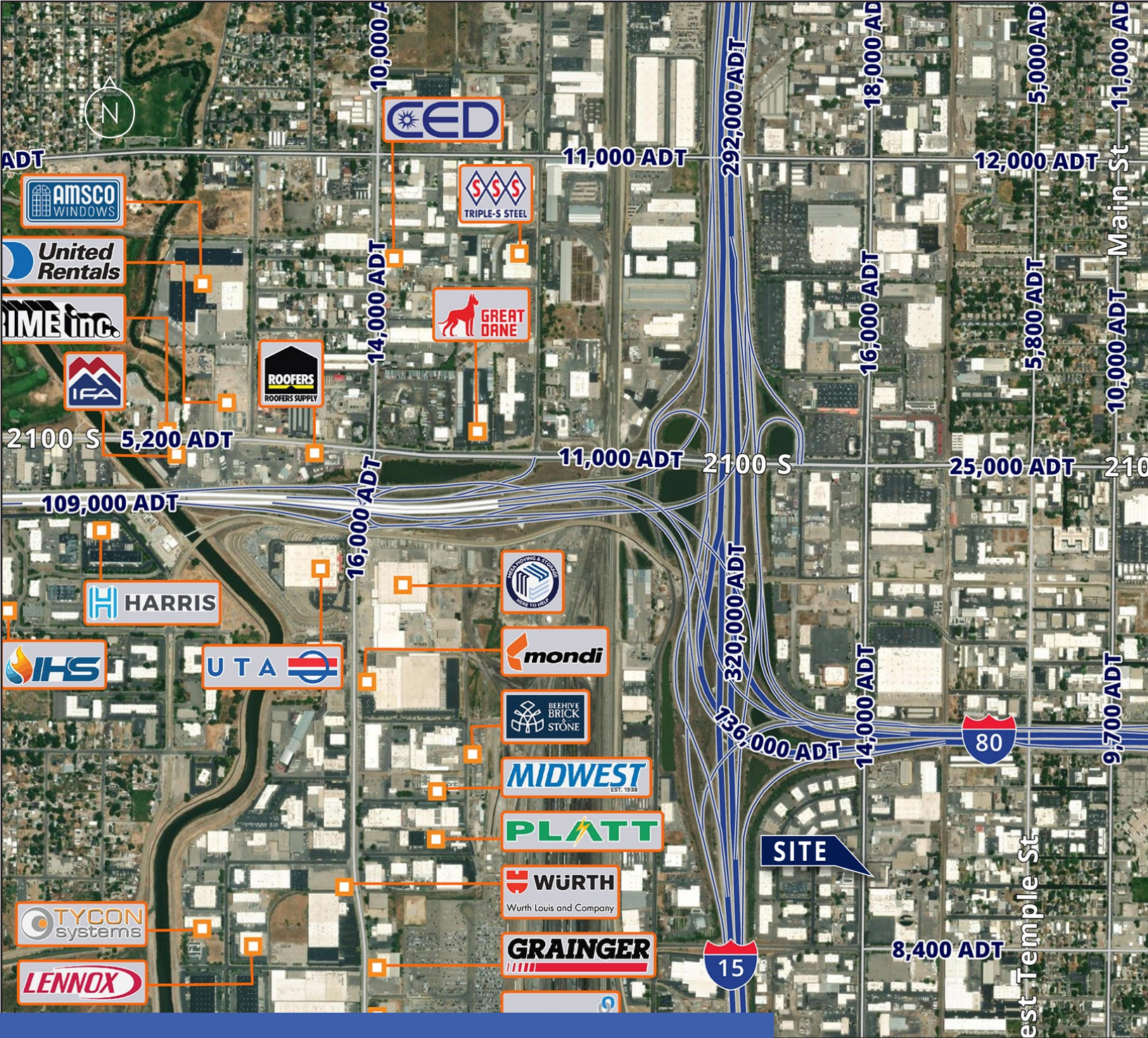

**CONTACT US**

**Jeremy Terry**

Vice President  
801 671 9349  
jeremy.terry@colliers.com

**Skyler Smith**

Senior Associate  
801 946 6423  
skyler.smith@colliers.com

**Colliers**

111 S Main Street, Suite 2200  
Salt Lake City, Utah 84111



This document has been prepared by Colliers International for advertising and general information only. Colliers International makes no guarantees, representations or warranties of any kind, expressed or implied, regarding the information including, but not limited to, warranties of content, accuracy and reliability. Any interested party should undertake their own inquiries as to the accuracy of the information. Colliers International excludes unequivocally all inferred or implied terms, conditions and warranties arising out of this document and excludes all liability for loss and damages arising there from. This publication is the copyrighted property of Colliers International and/or its licensor(s). ©2026. All rights reserved.