

# Clackamas Commons

## For Lease



### Building C | 12430 SE Capps Road | Clackamas, Oregon 97015

Clackamas Commons is a premier business park in the Clackamas/Milwaukie Submarket of the Portland Metropolitan Area. The site features modern high-quality construction and is situated less than 3 miles from Interstate 205, enjoying outstanding access to major distribution networks.

### Contact us:

#### Jon Rubey

Vice President

+1 503 499 0051

jon.rubey@colliers.com

#### Mark McClung

Vice President

+1 503 499 0066

mark.mcclung@colliers.com

# 15,564 SF Call for Rates

Available November 1, 2018



Colliers International  
851 SW Sixth Avenue | Suite 1200  
Portland, Oregon 97204  
P: +1 503 223 3123

This document has been prepared by Colliers International for advertising and general information only. Colliers International makes no guarantees, representations or warranties of any kind, expressed or implied, regarding the information including, but not limited to, warranties of content, accuracy and reliability. Any interested party should undertake their own inquiries as to the accuracy of the information. Colliers International excludes unequivocally all inferred or implied terms, conditions and warranties arising out of this document and excludes all liability for loss and damages arising there from. This publication is the copyrighted property of Colliers International and/or its licensor(s). ©2018. All rights reserved.



Currently Available	15,564 SF
Office	4,085 SF
Clear Height	26'
Sprinklers	ESFR
Loading	6 docks with concrete aprons, 1 grade
Column Spacing	45'x50'
Mezzanine	1,820 SF of functional load-bearing storage
NNN Expenses	Estimated at \$0.185 /SF
Asking Rental Rate	Call for Rates

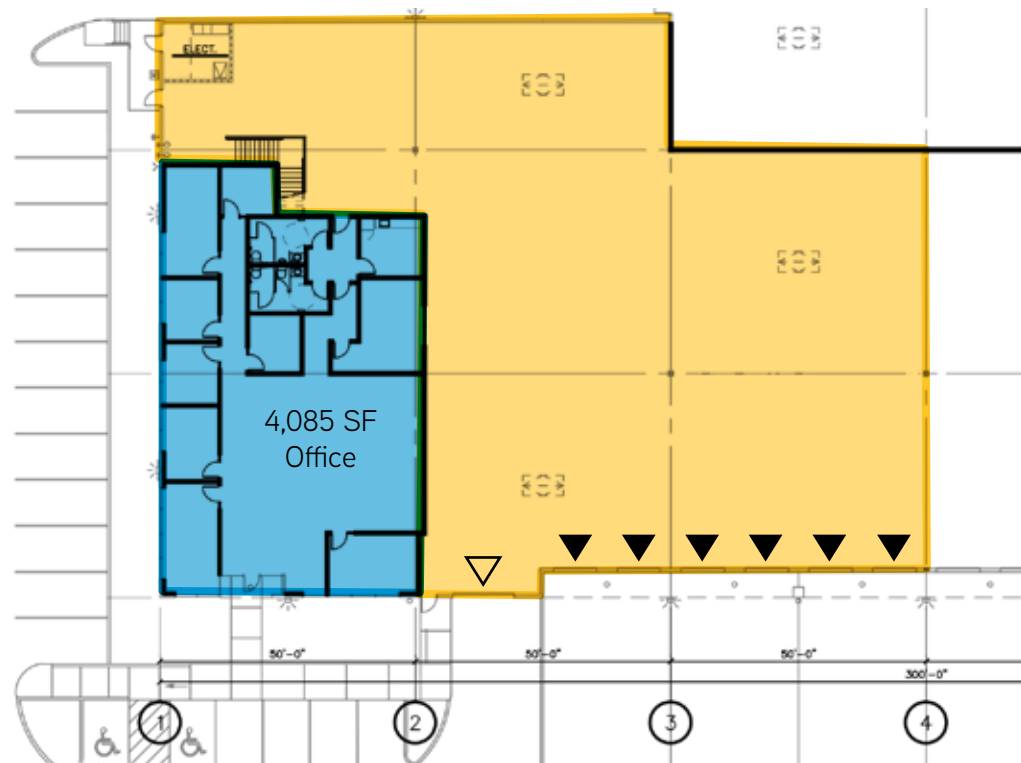

[colliers.com/portland](http://colliers.com/portland)

Contact us:

**Jon Rubey**  
 Vice President  
 +1 503 499 0051  
 jon.rubey@colliers.com

**Mark McClung**  
 Vice President  
 +1 503 499 0066  
 mark.mcclung@colliers.com



Accelerating success.