

FOR SALE › LAND - OFFICE/FLEX USE

ATLEE STATION

HANOVER COUNTY | MECHANICSVILLE, VA 23116



Property Features

- › 7± acres - Studley Road
- › 11± acres (4± usable acres) - Times Dispatch Blvd.
- › 23± acres - Times Dispatch Blvd. (visible from I-295)
- › Excellent access at I-295/U.S. Rt. 301 (Hanover Exit)
- › Zoned M-1 (light industrial)
- › Ideal for office and flex - build to suit
- › Utilities accessible at property lines: water, sewer, gas, electricity, fiber optic and telephone
- › Join Owens & Minor, FedEx, EVB and The Richmond Times Dispatch in this 236 acre corporate community
- › \$125,000 - \$140,000/acre

Contact
Information

KIT TYLER, SIOR
DIRECT +1 804 591 2420
kit.tyler@colliers.com

KEN CAMPBELL
DIRECT +1 804 591 2437
ken.campbell@colliers.com

FOR SALE > LAND - OFFICE/FLEX USE

ATLEE STATION

HANOVER COUNTY | MECHANICSVILLE, VA 23116

Colliers
INTERNATIONAL

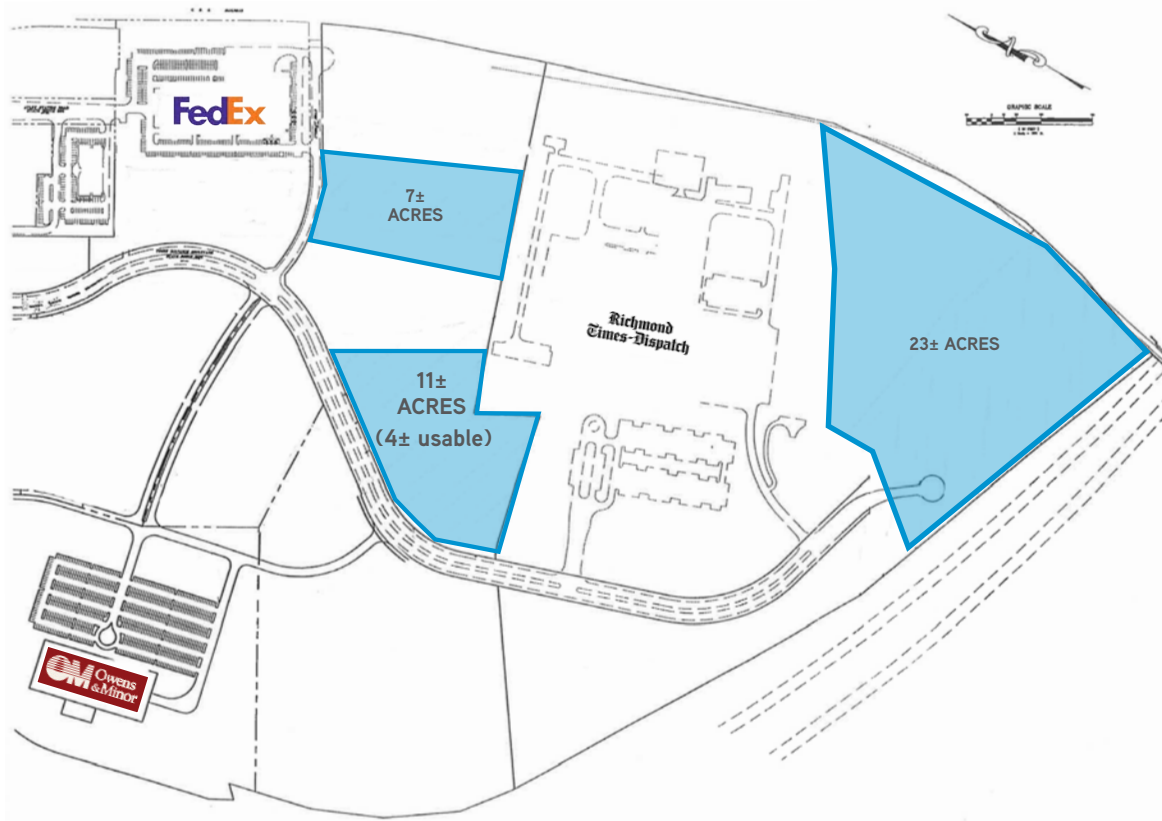
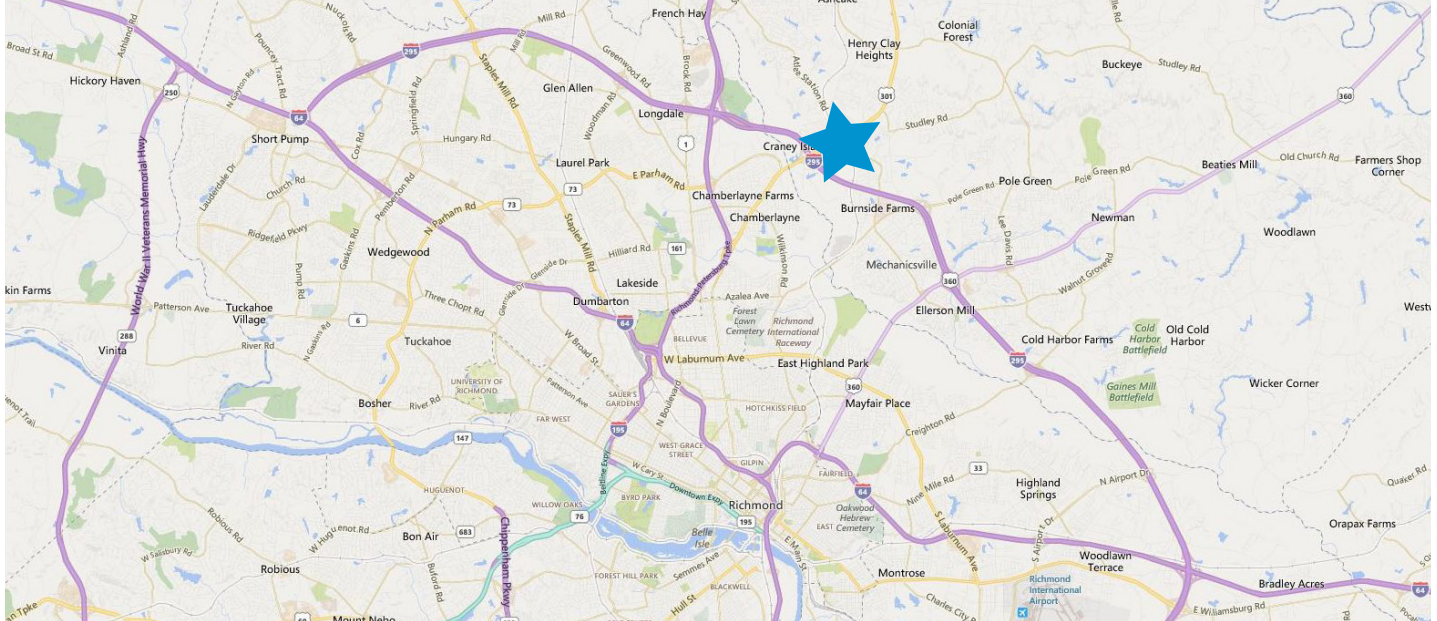

Contact
Information

KIT TYLER, SIOR
DIRECT +1 804 591 2420
kit.tyler@colliers.com

KEN CAMPBELL
DIRECT +1 804 591 2437
ken.campbell@colliers.com

The information contained herein was obtained from sources, believed reliable, however, Colliers International makes no guarantees, warranties or representations as to the completeness or accuracy thereof. The presentation of this property is submitted subject to errors, omissions, change of price or conditions prior to sale or lease, or withdrawal without notice. File Name: AtleeStation_Land_Sale rev 12-8-15