

SUBLEASE > OFFICE SPACE

251 Rhode Island St.

SAN FRANCISCO, CA

GREAT
SHOWPLACE
SQUARE
SUBLEASE

NOW
\$29 PSF

AVAILABLE SPACE

- » 1st Floor | Suite 103
- » 1,522 square feet
- » Term through June 30, 2018

FEATURES

- » Open plan with conference room
- » Concrete floors and high ceilings throughout
- » Abundant neighborhood parking
- » Great access to Highway 101 & 280
- » Great neighborhood amenities including Whole Foods & Philz Coffee
- » 24/7 access w/ building reception & security



COLLIERS INTERNATIONAL
101 Second Street, 11th Floor
San Francisco, CA 94105
www.colliers.com/sanfrancisco

KELLAM NELSON
LIC. 01903896
415 288 7886
kellam.nelson@colliers.com

MIKE DAVIS
LIC. 01315877
650 486 2219
mike.davis@colliers.com

No representation is made as to the accuracy of the information furnished herein and same is submitted subject to errors, omissions, change of prices, rental, or other conditions, prior sale, lease, sublease, and/or withdrawal without notice. The furnishing of this information shall not be deemed a hiring. A commission in accordance with our principal's schedule of rates and conditions will be paid to the procuring Broker who executes our or our principal's brokerage agreement, subject to a fully consummated transaction upon terms and conditions acceptable to our principal.

SUBLEASE > OFFICE SPACE

251 Rhode Island St.

SAN FRANCISCO, CA

GREAT
SHOWPLACE
SQUARE
SUBLEASE

NOW
\$29 PSF

FLOOR PLAN

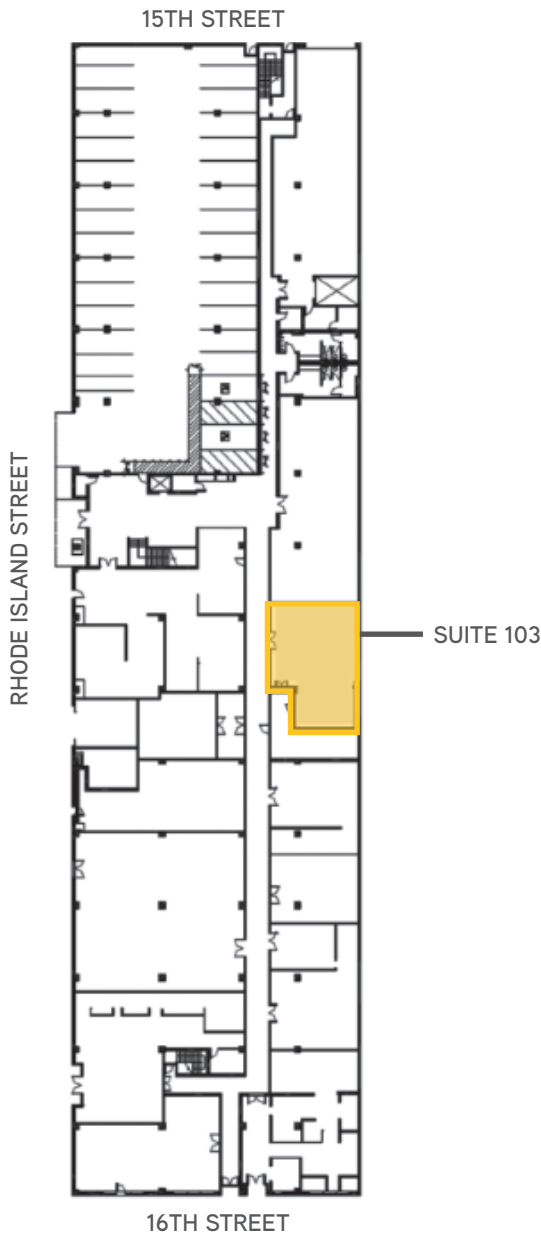

COLLIERS INTERNATIONAL
101 Second Street, 11th Floor
San Francisco, CA 94105
www.colliers.com/sanfrancisco

KELLAM NELSON
LIC. 01903896
415 288 7886
kellam.nelson@colliers.com

MIKE DAVIS
LIC. 01315877
650 486 2219
mike.davis@colliers.com

No representation is made as to the accuracy of the information furnished herein and same is submitted subject to errors, omissions, change of prices, rental, or other conditions, prior sale, lease, sublease, and/or withdrawal without notice. The furnishing of this information shall not be deemed a hiring. A commission in accordance with our principal's schedule of rates and conditions will be paid to the procuring Broker who executes our or our principal's brokerage agreement, subject to a fully consummated transaction upon terms and conditions acceptable to our principal.