

AVAILABLE FOR SUBLEASE > 2,436–30,415 SF

Prime East Memphis Office Space

855 RIDGE LAKE BLVD, MEMPHIS TN 38120



Property Features

- > Move-in ready office space available
- > Located in desirable East Memphis Submarket
- > Up to 30,415 SF available
- > Space divisible: 2,436–30,415 SF
- > Office furniture available
- > Sublease through 12/31/19

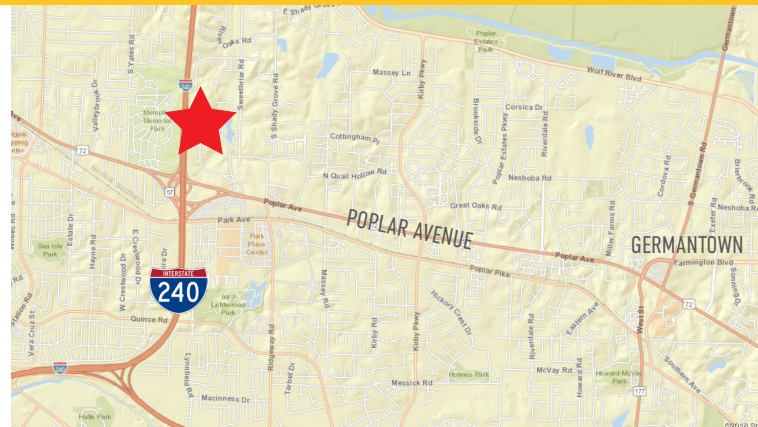

AGENT: BRAD MURCHISON
901 375 4800 | EXT. 4917
MEMPHIS, TN
brad.murchison@colliers.com

AGENT: ALEX STRINGFELLOW
901 375 4800 | EXT. 4920
MEMPHIS, TN
alex.stringfellow@colliers.com

COLLIERS INTERNATIONAL
6363 Poplar Avenue, Suite 220
Memphis, TN 38119
www.colliers.com/memphis

855 Ridge Lake Boulevard > Floor Plans

1st Floor

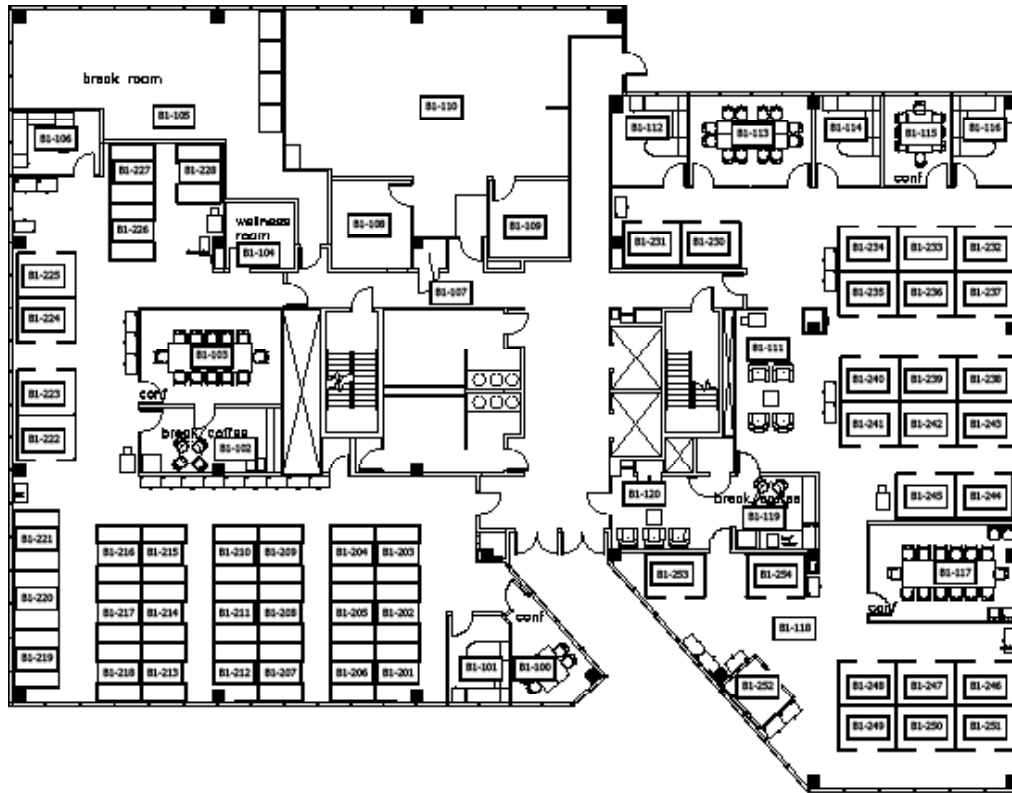

2nd Floor

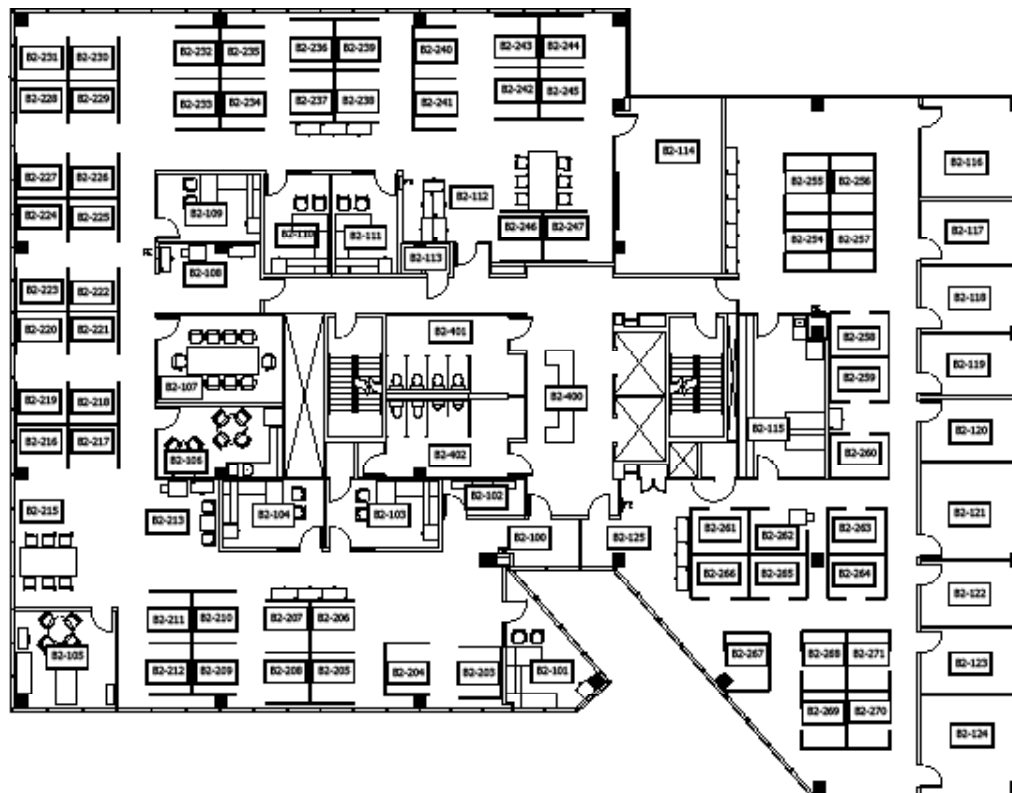

AGENT: BRAD MURCHISON
901 375 4800 | EXT. 4917
MEMPHIS, TN
brad.murchison@colliers.com

AGENT: ALEX STRINGFELLOW
901 375 4800 | EXT. 4920
MEMPHIS, TN
alex.stringfellow@colliers.com

