

FOR LEASE > MEDICAL OFFICE SPACE



SIXTH ST & BIXEL ST

1106 W 6TH STREET, LOS ANGELES, CA 90017



1106 W 6th Street > Medical Office Space

AVAILABLE SPACES

Suite A	±2,338 SF
Suite B	±1,374 SF
Suite F	±1,170 - 4,755 SF
Suite G	±985 SF

GENERAL PRICING

Asking Rent	\$3.00 NNN
TI Allowance	Negotiable

PARKING

Parking	Up to 60 spaces available on-site
Garage	Secure, Direct Access
Covered	Yes

This cohesive medical epicenter boasts Good Samaritan Hospital, Samaritan Medical Tower, City of Hope medical offices, the California CardioVascular Institute, Urgent Care Medical Pharmacy, Esthetic Dentistry, and several medical/office buildings.

The property is within two blocks of eight (8) existing residential projects totaling 2,261 residential units including GLO luxury apartment community with 201 units and Starbucks, Chase Bank, Subway, and Plan Check. There are seven (7) additional residential developments in some stage of development that may bring an additional 2,899 households to the immediate area.

ANGIE WEBER
VICE PRESIDENT
818 325 4114
angie.weber@colliers.com

DANA NIALIS
ASSOCIATE
818 325 4107
dana.nialis@colliers.com

COLLIERS INTERNATIONAL
16830 Ventura Blvd., Suite J
Encino, CA 90017
www.colliers.com

1106 W. 6th Street > Floor Plan

Suite A ±2,338 SF

Suite B ±1,374 SF

Suite F ±1,170 - 4,755 SF

Suite G ±985 SF

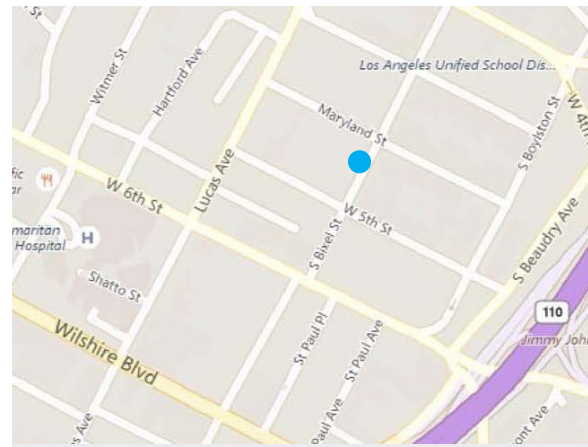
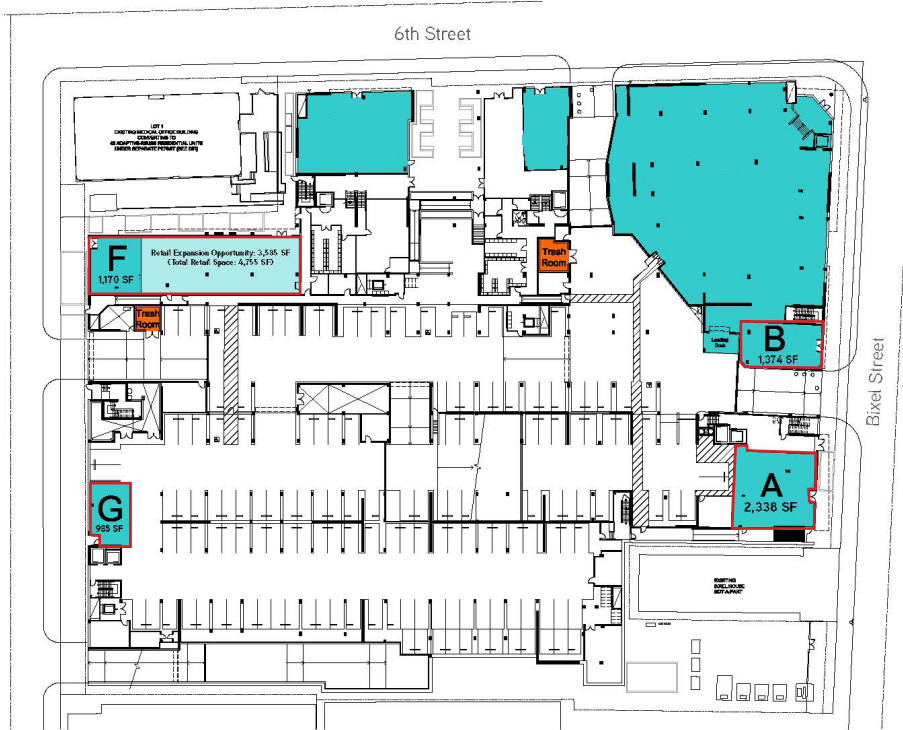

Contact Us

ANGIE WEBER
VICE PRESIDENT

818 325 4114

angie.weber@colliers.com

DANA NIALIS
ASSOCIATE

818 325 4107

dana.nialis@colliers.com



COLLIERS INTERNATIONAL
16830 Ventura Blvd. Suite J
Encino, CA 91436

www.colliers.com