

FOR LEASE > MEDICAL OFFICE

# ORCHARD VIEW MEDICAL COMPLEX

12150 30 MILE ROAD | WASHINGTON TOWNSHIP, MI



## CLASS A MEDICAL BUILDING

### > PROPERTY HIGHLIGHTS

- Up To 9,461 SF Available
- Ownership Will Finish Space to Suit
- Storage Space Also Available
- Immediately Off of M-53
- Join the Existing Strong Tenant Base of:
  - Henry Ford Radiology
  - Henry Ford Orthopedic Surgery
  - Henry Ford Physical Therapy
  - Village Health Urgent Care
  - Keystone Oral Surgery
  - Orchard View Pharmacy

DEMOGRAPHICS	1 MILE	3 MILE	5 MILE
POPULATION	3,942	23,122	64,695
HISTORICAL ANNUAL POPULATION GROWTH	5.0%	3.7%	3.1%
AVERAGE INCOME	\$109,841	\$99,953	\$103,553
PROJECTED (2016-2021) ANNUAL INCOME INCREASE	3.4%	3.6%	4.1%
HOUSEHOLDS	1,458	8,755	24,032
HISTORICAL ANNUAL HOUSEHOLD INCREASE	5.2%	3.4%	2.9%

**COLLIERS INTERNATIONAL**  
2 Corporate Drive | Suite 300  
Southfield, Michigan 48076

**GARY P. GROCHOWSKI, SIOR**

PHONE 248 540 1000 EXT 1856  
gary.grochowski@colliers.com



**JUSTIN FRANCEK**

PHONE 248 540 1000 EXT 1652  
justin.francek@colliers.com



colliers.com/detroit

FOR LEASE > MEDICAL OFFICE

# ORCHARD VIEW MEDICAL COMPLEX

12150 30 MILE ROAD | WASHINGTON TOWNSHIP, MI



## > PROPERTY PHOTOS



**GARY P. GROCHOWSKI, SIOR**  
PHONE 248 540 1000 EXT 1856  
[gary.grochowski@colliers.com](mailto:gary.grochowski@colliers.com)



**JUSTIN FRANCEK**  
PHONE 248 540 1000 EXT 1652  
[justin.francek@colliers.com](mailto:justin.francek@colliers.com)



FOR LEASE > MEDICAL OFFICE

# ORCHARD VIEW MEDICAL COMPLEX

12150 30 MILE ROAD | WASHINGTON TOWNSHIP, MI



## > SECOND FLOOR

SUITE	AVAILABLE SF	LEASE RATE (\$/SF)
203	2,985	\$19.50 NNN
204	6,476	\$19.50 NNN
203/204	9,461	\$19.50 NNN

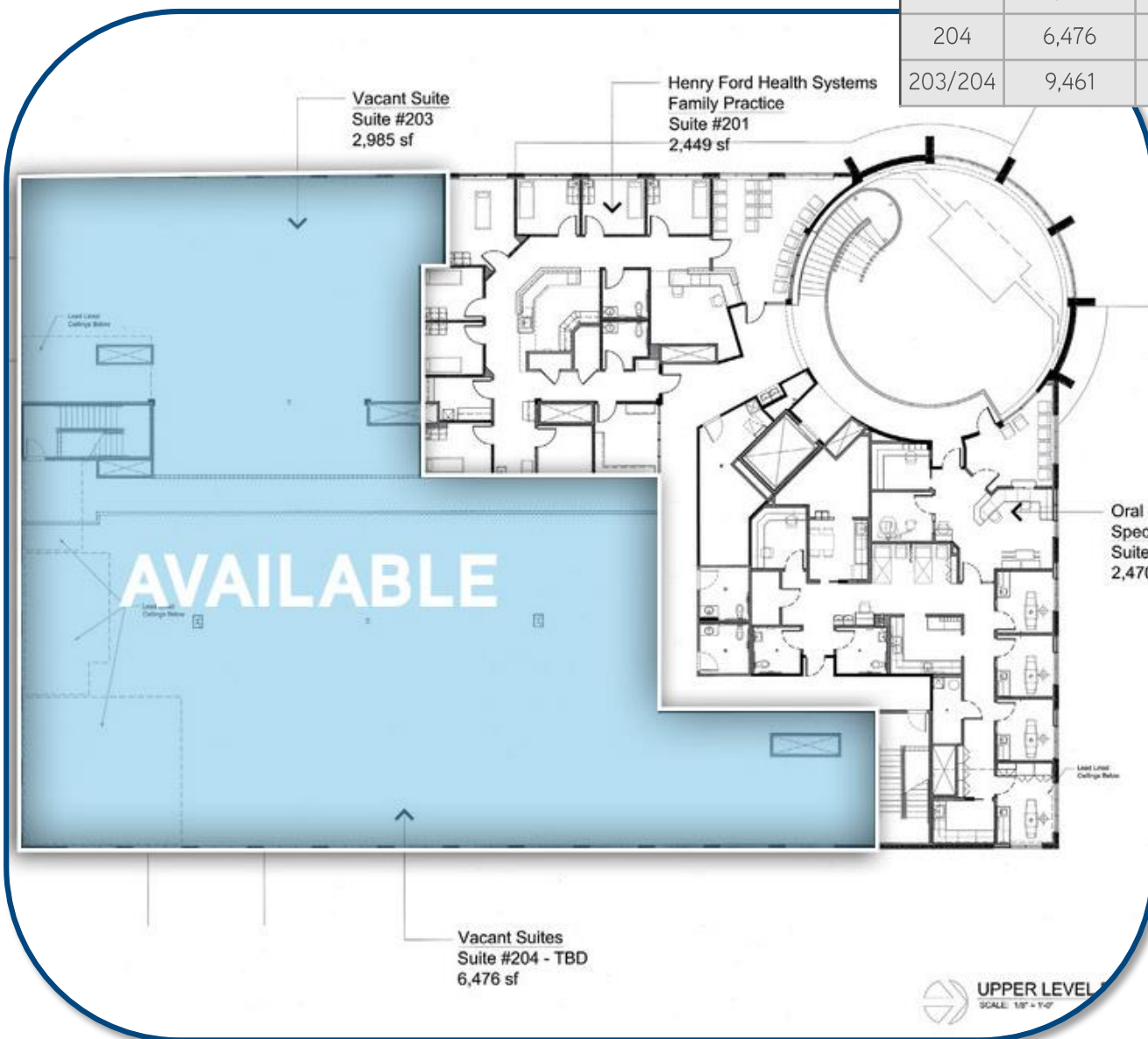

**GARY P. GROCHOWSKI, SIOR**  
PHONE 248 540 1000 EXT 1856  
gary.grochowski@colliers.com



**JUSTIN FRANCEK**  
PHONE 248 540 1000 EXT 1652  
justin.francek@colliers.com

FOR LEASE > MEDICAL OFFICE

# ORCHARD VIEW MEDICAL COMPLEX

12150 30 MILE ROAD | WASHINGTON TOWNSHIP, MI



## > LOCATION MAP

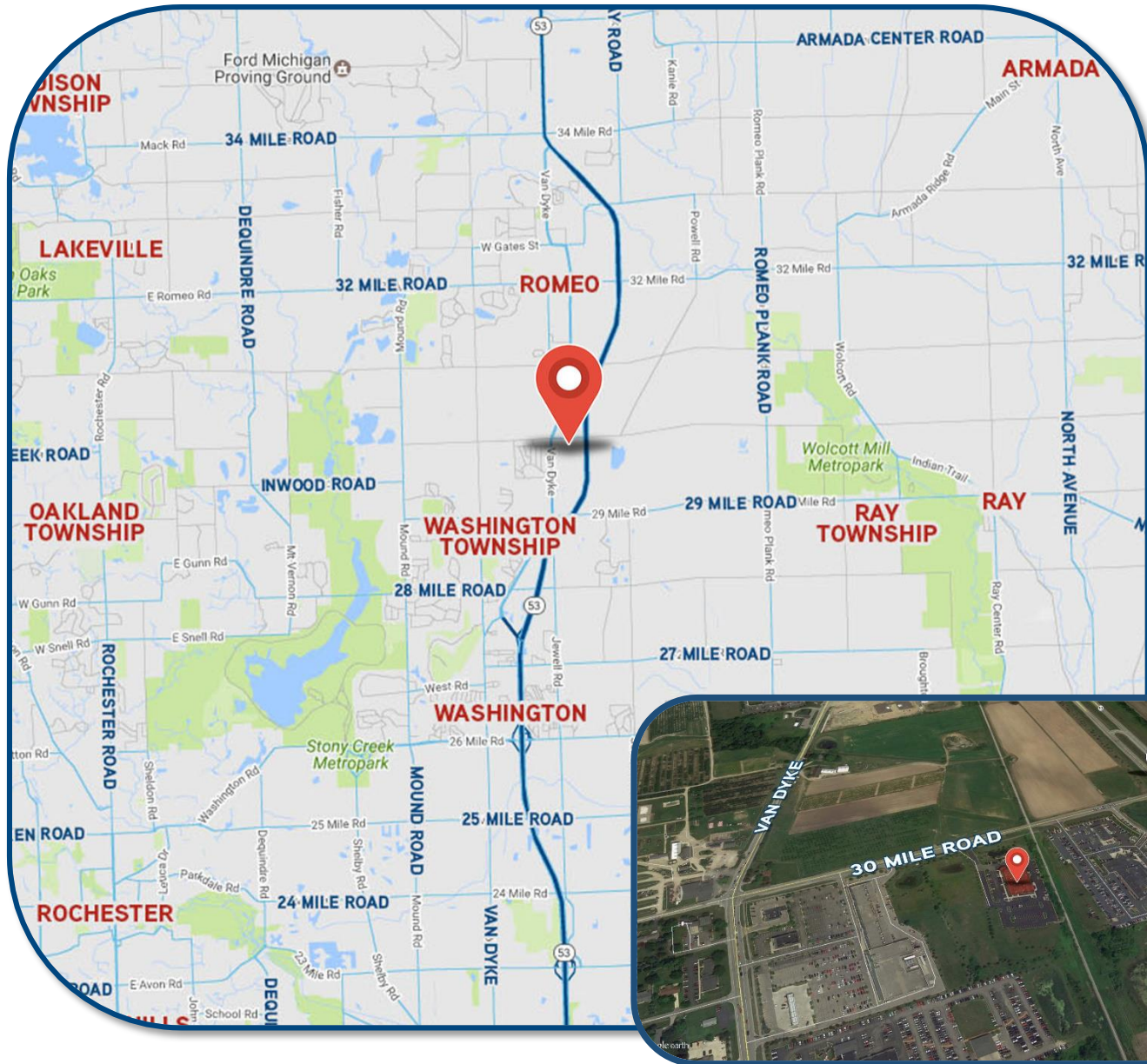

**GARY P. GROCHOWSKI, SIOR**  
PHONE 248 540 1000 EXT 1856  
[gary.grochowski@colliers.com](mailto:gary.grochowski@colliers.com)



**JUSTIN FRANCEK**  
PHONE 248 540 1000 EXT 1652  
[justin.francek@colliers.com](mailto:justin.francek@colliers.com)

## For Lease

## Orchard View Medical Complex

12150 30 Mile Road

Washington Township, MI 48095



Sale Price:		
Lease Rate :	\$19.50	NNN
Gross Sq Ft:	35,935	
Vacant Sq Ft:	9,461	
Min Available Sq Ft:	2,985	
Max Contiguous Sq Ft:	9,461	
% Occupied:	74%	
Date Built/Rehab:	2007	/
T I Allowance:	TBD	
Pass Thrus:	TBD	
Property Taxes/Year:	2.32	
Parking:	155 Spaces	

County: Macomb  
Crossroads: 1/4 Mile West of M-53

- Class A Medical Building
- Up to 9,461 Square Feet Available
- Excellent, High Growth Area
- Immediately Off of M-53
- Ownership Will Finish Space to Suit
- Storage Available
- Available Immediately

**For more information, contact:**



**Gary P. Grochowski, SIOR**

[gary.grochowski@colliers.com](mailto:gary.grochowski@colliers.com)

## Justin Francek

justin.francek@colliers.com

Site Status:	Existing
Acres:	5.57
Zoning:	GC - General Commercial
Sub-Type:	
Floors:	2
Basement:	Yes
Class:	A

**(248) 540-1000**

2 Corporate Drive  
Suite 300  
Southfield, MI 48076  
248 540 1000

400 E. Washington St.  
Ann Arbor, MI 48104  
734 994 3100

[www.colliers.com](http://www.colliers.com)

Colliers International has prepared this document/email for advertising or general information only. Information contained herein has been obtained from the owners or from other sources deemed reliable. We have no reason to doubt its accuracy but regret we cannot guarantee it. All properties subject to change or withdrawal without notice.