



# Restaurant Space For Lease

**RIVERPLACE**  
**43 Main Street SE**  
**Minneapolis, MN 55414**

MOLLY TOWNSEND  
952 897 7825  
molly.townsend@colliers.com



COLLIERS INTERNATIONAL  
Minneapolis-St. Paul  
4350 Baker Road, Suite 400  
Minnetonka, MN 55343  
[www.colliers.com/msp](http://www.colliers.com/msp)

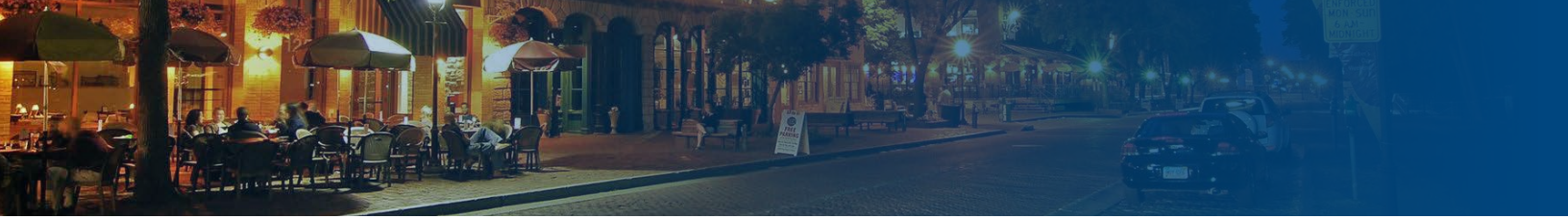

## Site Information

- > **Location** 43 Main Street SE | Minneapolis, MN 55414
- > **Description** Former Restaurant Space (equipment in place)
- > **Total Building Size** 248,672 SF
- > **Exposition Hall** 101,747 SF
- > **Year Built** 1985

## Available

- > Suite 141: 5,860 SF (Restaurant Space)

## Asking Rents

- > \$20.00 - \$22.00 psf

## Traffic Counts

- > E Hennepin Ave: 16,800 vpd
- > Central Ave SE: 17,600 vpd
- > Main Street SE: 6,200 vpd

\* Source: Minnesota Department of Transportation 2015 Study Averages are per day total cars.

## 2016 Est. CAM & Taxes

- > \$9.25 psf

## Area Tenants

- > Wilde Roast Cafe
- > Punch Pizza
- > Aster Cafe
- > New Bohemia
- > Lunds & Byerly's
- > Tuggs Tavern
- > Surdyk's
- > Honey Pacifier

## Comments

Former restaurant space available on historic Main Street in NE Minneapolis on the Mississippi River. All the FF&E is available. Patio seating available. Located next to Wilde Roast Café, Aster Café, Nicollet Island Inn and Tugg's Tavern. Great daytime population and excellent foot traffic.

## AERIAL



## SUITE 141 | FLOOR PLAN - 5,680 SF

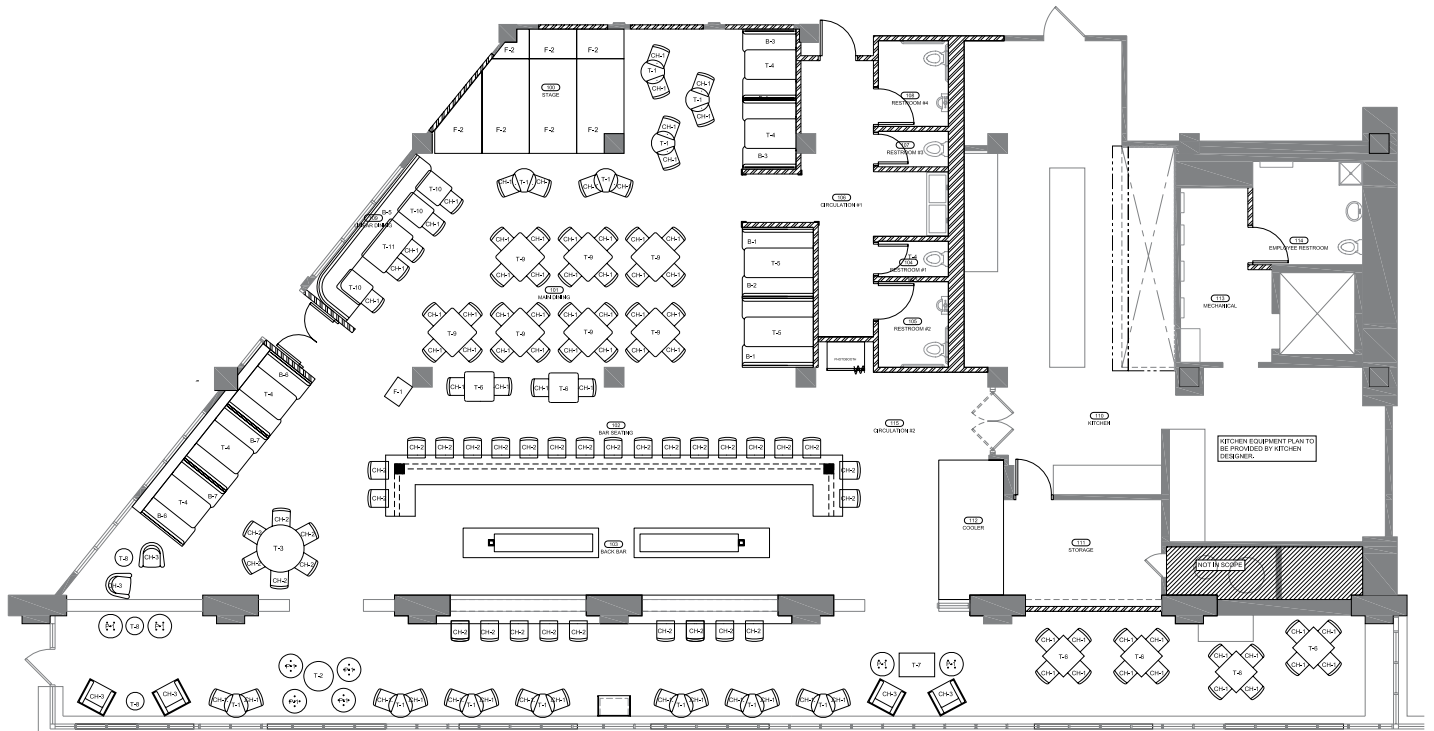



## CONTACT

MOLLY TOWNSEND  
 952 897 7825  
[molly.townsend@colliers.com](mailto:molly.townsend@colliers.com)

COLLIERS INTERNATIONAL  
 4350 Baker Road, Suite 400  
 Minneapolis, MN 55343  
[www.colliers.com/msp](http://www.colliers.com/msp)



Accelerating success.

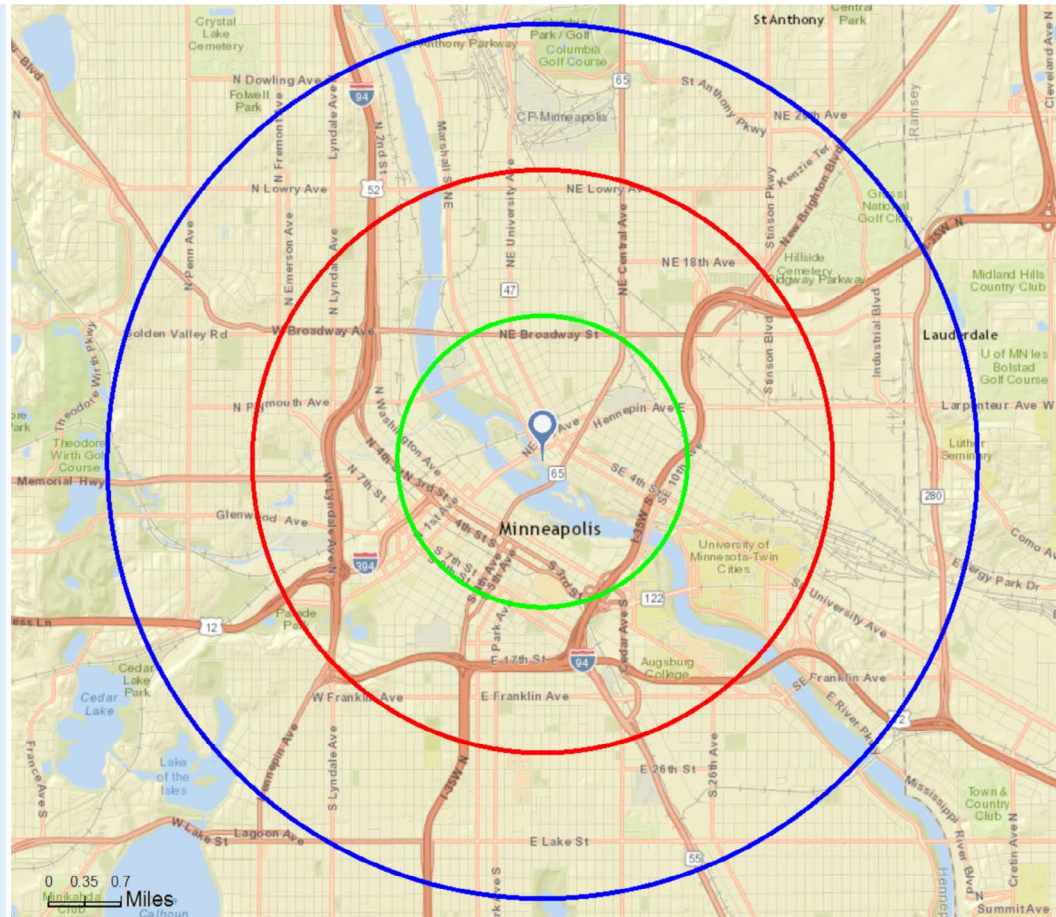

Demographics	1 Mile	2 Mile	3 Mile
Total Population	27,576	111,864	224,306
Daytime Population	125,503	269,224	331,968
Average Household Income	\$89,295	\$60,938	\$61,356
Median Household Income	\$55,756	\$35,589	\$37,706