

AVAILABLE > 3,500+/- SF



# 1868 First Commercial Drive

SOUTHAVEN, MISSISSIPPI 38671



## Property Features

- > 3,500+/- square foot building
- > Showroom/warehouse
- > 0.85 acre site
- > Zoned Light Industrial
- > Former Fastenal location
- > One 10' x 10' drive-in door to dock platform
- > One 1/2 dock position
- > One full dock position
- > Building depth 50' x 70'
- > Outside storage
- > Fluorescent lighting
- > 100% HVAC with a 10 ton unit
- > Brick exterior on metal frame construction

AGENT: HUNTER ADAMS  
901 375 4800 | EXT. 4915  
MEMPHIS, TN  
[hunter.adams@colliers.com](mailto:hunter.adams@colliers.com)

COLLIERS INTERNATIONAL  
6363 Poplar Avenue, Suite 220  
Memphis, TN 38119

[www.Colliers.com/memphis](http://www.Colliers.com/memphis)



## 1868 First Commercial Drive > Location Map

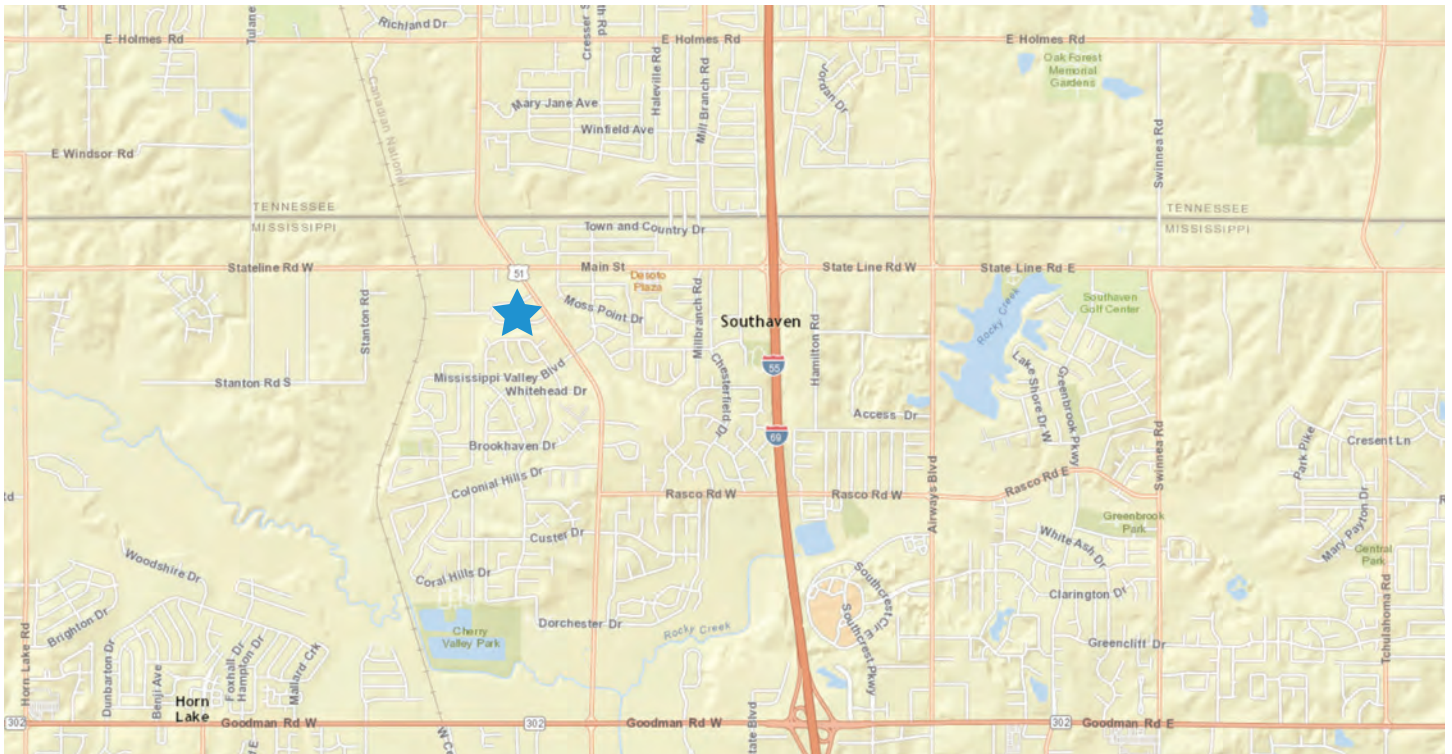

## 1868 First Commercial Drive > Aerial



AGENT: HUNTER ADAMS  
901 375 4800 | EXT. 4915  
MEMPHIS, TN  
hunter.adams@colliers.com

Copyright © 2018 Colliers International.  
Information herein has been obtained from sources deemed reliable, however its accuracy cannot be guaranteed. The user is required to conduct their own due diligence and verification.

