

FOR LEASE > INDUSTRIAL SPACE



Coffey Creek Business Park

1110 CENTER PARK DRIVE, SUITE E, CHARLOTTE, NC



Coffey Creek Business Park >

Excellent industrial facility in great condition with $\pm 15,000$ square feet of availability. Situated on ± 4.5 acres, this facility is located in Airport/West Charlotte Submarket in Coffey Creek Business Park with immediate access to I-485.

Located ± 3.4 miles west of I-77, ± 3.9 miles east of I-485, ± 6.4 miles south of Charlotte Douglas International Airport, ± 9 miles from Charlotte's Central Business District.

Building Amenities >

- > $\pm 15,000$ SF available
- > 100' x 150' space dimensions
- > $\pm 1,000$ SF office space
- > (2) offices
- > (2) bathrooms
- > Open meeting area
- > Break room
- > TICAM \$1.50 PSF
- > Lease Rate \$7.00 PSF (NNN)
- > (3) 9' x 10' dock high doors
- > (2) 12' x 14' drive in doors
- > 18' clear height
- > T-5 lighting in warehouse
- > Electrical hook-up for shore power
 - > (1) 50 amp
 - > (1) 30 amp
- > 110 vol quad outlets located in warehouse on columns



JUSTIN SMITH
704 409 2379
CHARLOTTE, NC
justin.smith@colliers.com

ROB SPEIR, SIOR
704 409 2370
CHARLOTTE, NC
rob.speir@colliers.com

COLLIERS INTERNATIONAL
301 S. College St, Suite 3350
Charlotte, NC 28202
www.colliers.com

Suite E Floor Plan >

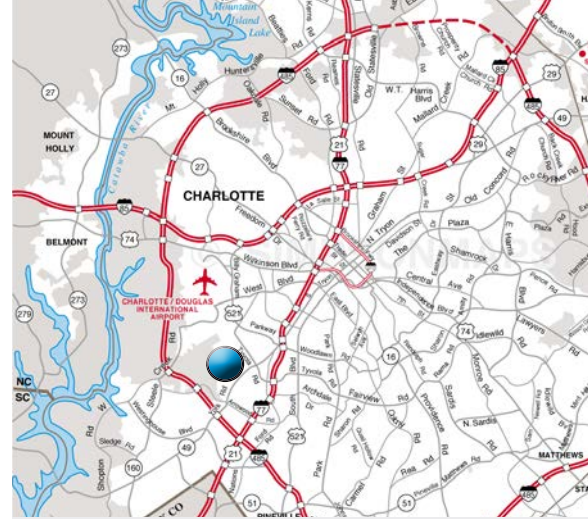
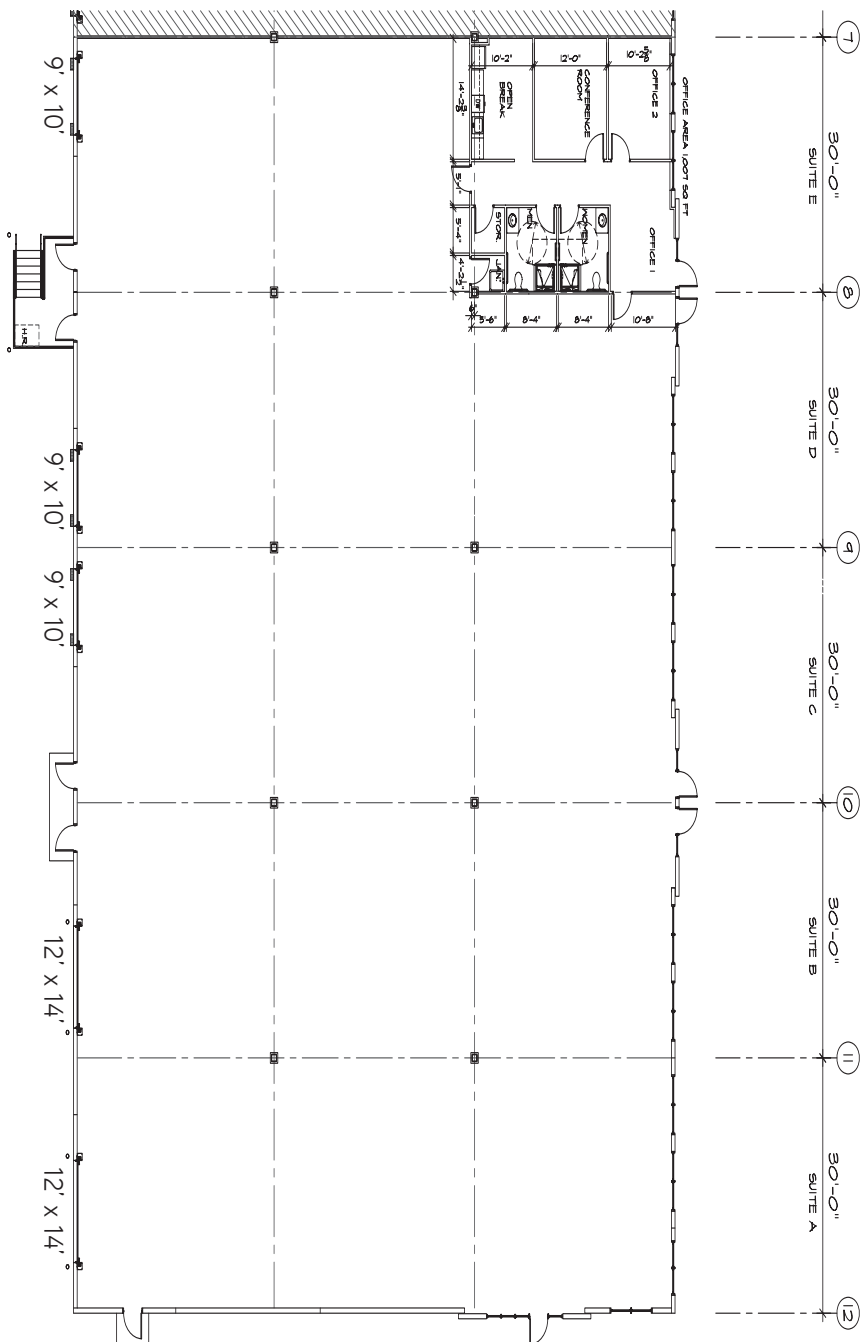

Contact Us

JUSTIN SMITH
704 409 2379
charlotte, nc
justin.smith@colliers.com

ROB SPEIR, SIOR
704 409 2370
CHARLOTTE, NC
rob.speir@colliers.com

COLLIERS INTERNATIONAL
301 S. College St, Suite 3350
Charlotte, NC 28202
www.colliers.com