

OFFICE/WAREHOUSE
FOR LEASE

Briarwood Revere Business Park

12508-12650 EAST BRIARWOOD AVENUE, SUITE 106 | CENTENNIAL, CO 80112

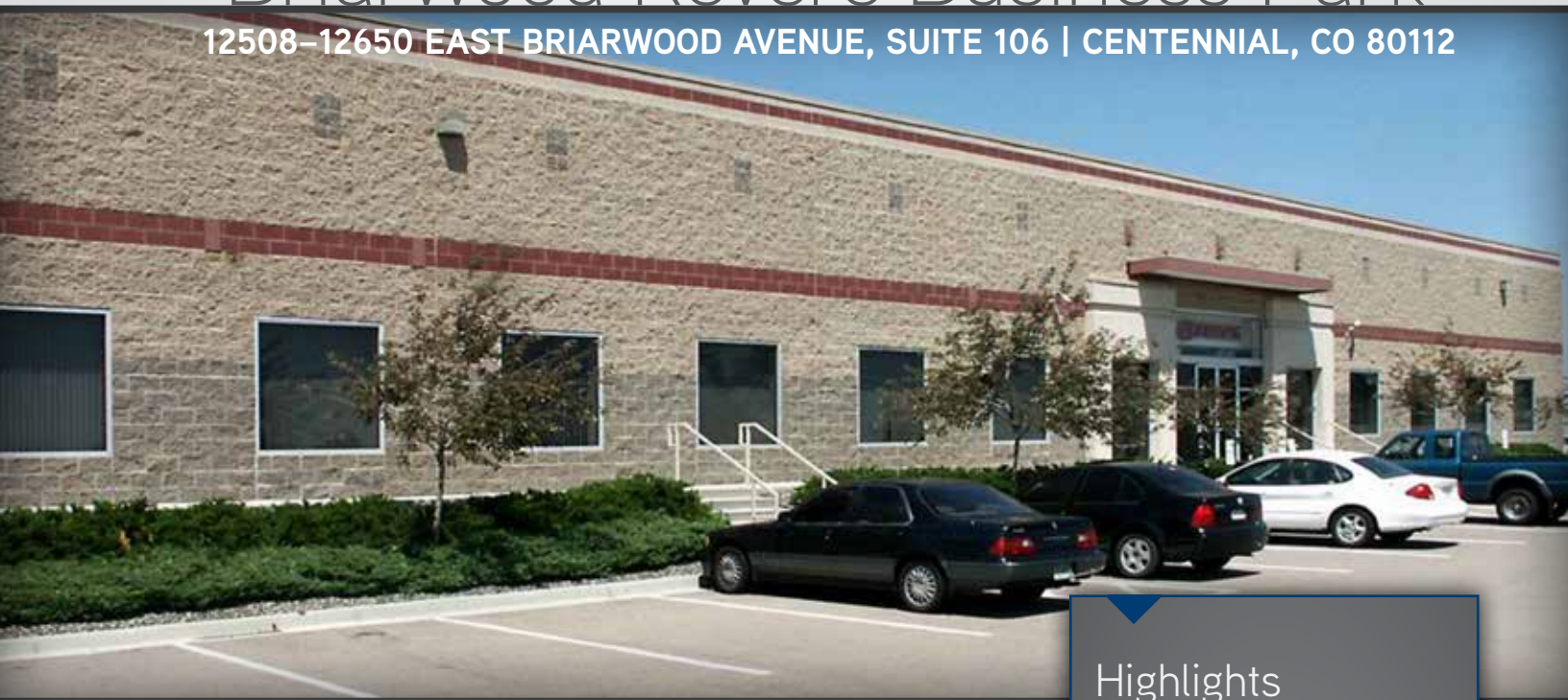

Building Information

- › Building Size: 107,071 SF
- › Available: 15,000 SF
- › Truck Doors: Two (2) Dock High Doors
- › Clear Height: 15'
- › Parking: 3.5:1,000
- › Sprinkler: .30GPM/SF over 2,000 SF
- › Rental Rate: \$12.50/SF NNN
- › 2019 Expenses: \$5.54/SF
- › Available: Immediately

Highlights

- › Single-Story Office/ Warehouse Complex Located in the Heart of Centennial Airport
- › 30% to 80% Office
- › Convenient Access to I-25 via Arapahoe Road
- › Individual Tenant Identification Signage
- › Showers

T.J. SMITH, SIOR
303 283 4576
tj.smith@colliers.com

DAVID HAZLETT
303 283 4573
david.hazlett@colliers.com

Accelerating success.

SUITE 106 > 15,000 SF

Briarwood Revere Business Park
12508-12650 E. Briarwood Avenue
Centennial, CO 80112

Site Plan

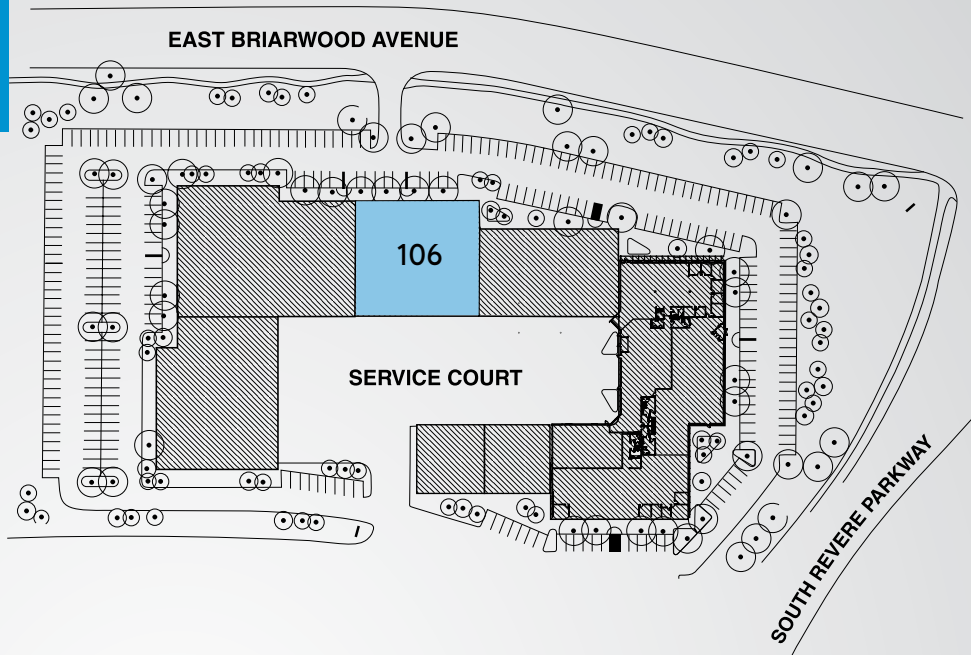

Contact Us

4643 South Ulster Street
Suite 1000
Denver, CO 80237
MAIN +1 303 745 5800
FAX +1 303 745 5888
www.colliers.com/denver

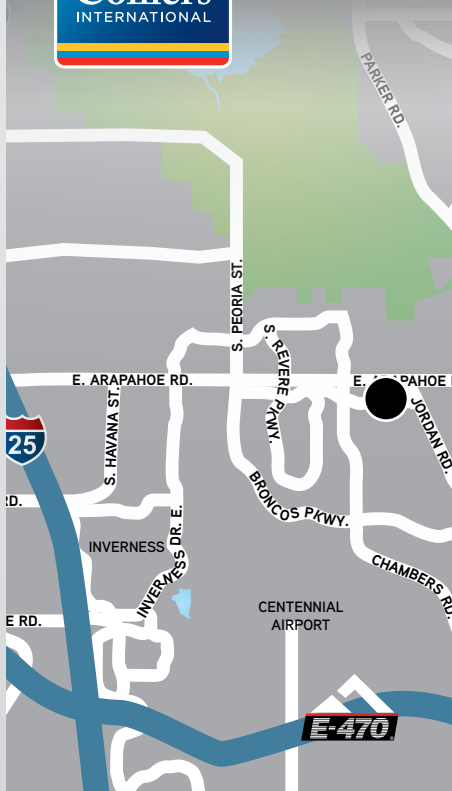

Current Plan

