

FOR SUBLEASE > OFFICE SPACE

4121 W 83rd Street, Suite 155

PRAIRIE VILLAGE, KS



PROPERTY FEATURES

- > Approximately 571 SF available
- > \$20.00 PSF
- > One private office
- > Furniture is negotiable
- > Sublease expires 11/30/2021
- > Directly across from Corinth Square
- > Plenty of parking

ELLEN FISHER
+1 816 589 0012
KANSAS CITY, MO
ellen.fisher@colliers.com

COLLIERS INTERNATIONAL
4520 Main Street, Suite 1000
Kansas City, MO 64111
www.colliers.com

FOR SUBLEASE > OFFICE SPACE

4121 W 83rd Street, Suite 155

PRAIRIE VILLAGE, KS

FLOOR PLAN:

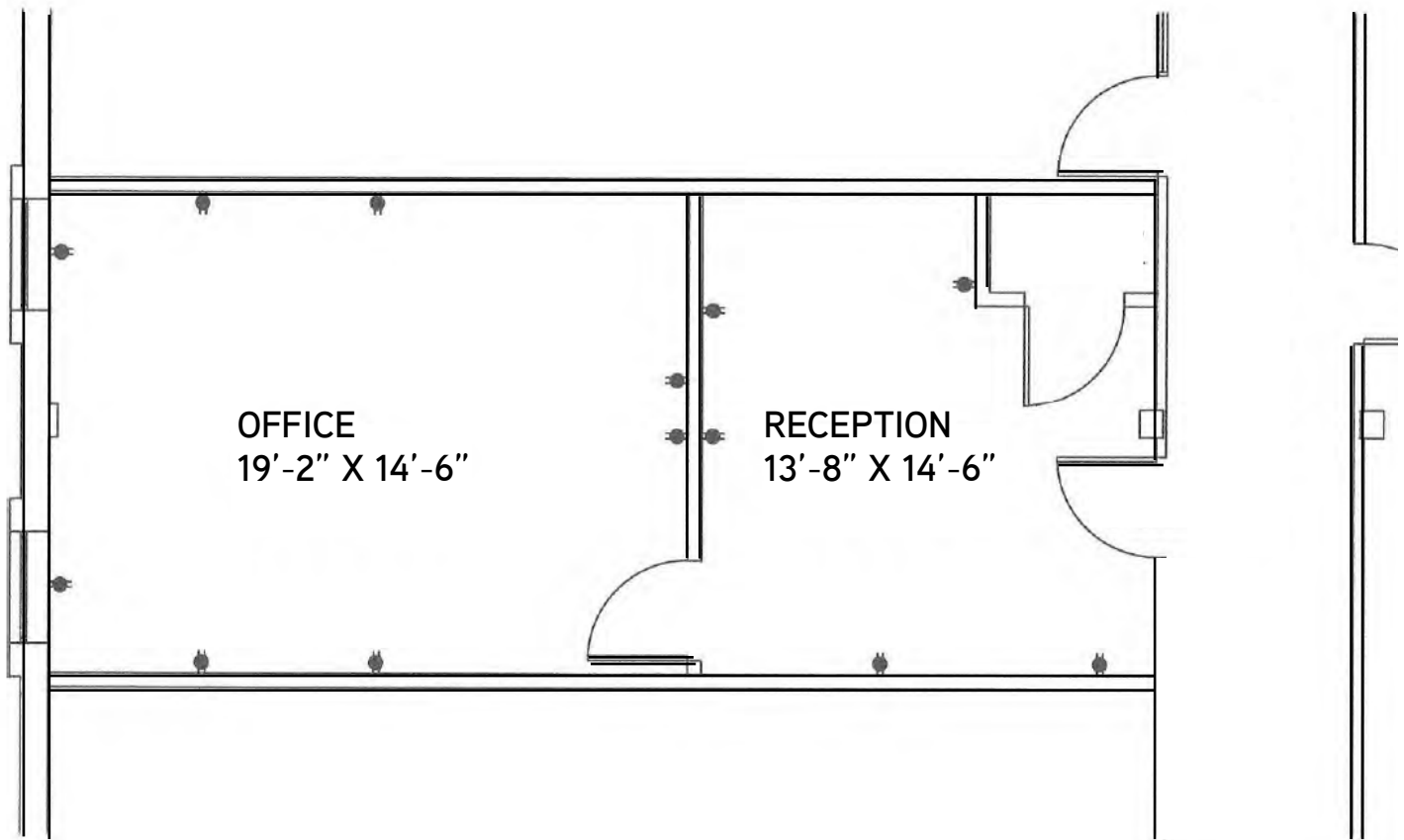

This document has been prepared by Colliers International for advertising and general information only. Colliers International makes no guarantees, representations or warranties of any kind, expressed or implied, regarding the information including, but not limited to, warranties of content, accuracy and reliability. Any interested party should undertake their own inquiries as to the accuracy of the information. Colliers International excludes unequivocally all inferred or implied terms, conditions and warranties arising out of this document and excludes all liability for loss and damages arising there from. This publication is the copyrighted property of Colliers International and/or its licensor(s). ©2017. All rights reserved.

COLLIERS INTERNATIONAL
4520 Main Street, Suite 1000
Kansas City, MO 64111
www.colliers.com

FOR SUBLEASE > OFFICE SPACE

4121 W 83rd Street, Suite 155

PRAIRIE VILLAGE, KS



ELLEN FISHER
+1 816 589 0012
KANSAS CITY, MO
ellen.fisher@colliers.com



COLLIERS INTERNATIONAL
4520 Main Street, Suite 1000
Kansas City, MO 64111
www.colliers.com