

FOR LEASE > OFFICE BUILDING



Lakewood Plaza Business Center

817 NE ANDERSON WAY, LEE'S SUMMIT, MISSOURI



Property Features

- > Close to M-291 Highway and retail establishments
- > Located within Lakewood subdivision
- > Local ownership of property
- > Parking: 4 / 1,000 RSF
- > Lease price: \$12.00-14.00 NNN
- > 1,910 - 4,070 SF available
- > Flexible term
- > Retail / office space available

Demographics

	1-Mile	3-Mile	5-Mile
Average HHI	\$140,064	\$90,126	\$85,239
Median Age	41.2	40.8	40.2
Total Population	4,724	30,251	110,692

JIM GATES
+1 816 556 1138
KANSAS CITY, MO
jim.gates@colliers.com

ELLEN FISHER
+1 816 589 0012
KANSAS CITY, MO
ellen.fisher@colliers.com

COLLIERS INTERNATIONAL
4520 Main Street, Suite 1000
Kansas City, MO 64111
www.colliers.com

Lakewood Plaza Business Center > Floor Plan



Contact Us

JIM GATES

+1 816 556 1138

KANSAS CITY, MO

jim.gates@colliers.com

ELLEN FISHER

+1 816 589 0012

KANSAS CITY, MO

ellen.fisher@colliers.com

COLLIERS INTERNATIONAL
4520 Main Street, Suite 1000
Kansas City, MO 64111

www.colliers.com

Aerial

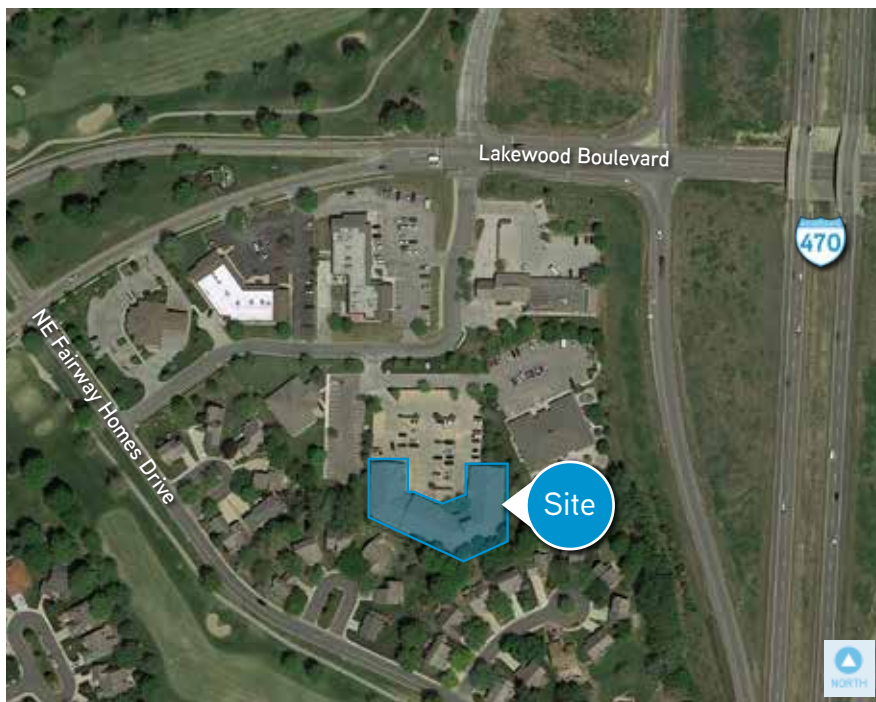

This document has been prepared by Colliers International for advertising and general information only. Colliers International makes no guarantees, representations or warranties of any kind, expressed or implied, regarding the information including, but not limited to, warranties of content, accuracy and reliability. Any interested party should undertake their own inquiries as to the accuracy of the information. Colliers International excludes unequivocally all inferred or implied terms, conditions and warranties arising out of this document and excludes all liability for loss and damages arising there from. This publication is the copyrighted property of Colliers International and/or its licensor(s). ©2018. All rights reserved.

