

FOR LEASE



**Contact:**

**Justin Irvine**

Vice President  
+1 801 400 4260  
justin.irvine@colliers.com

**James Yeates**

Vice President  
+1 801 995 0049  
james.yeates@colliers.com



**Colliers**

2100 Pleasant Grove Blvd., Suite 200  
Pleasant Grove, UT 84062  
Main: +1 801 947 8300  
colliers.com

# Industrial/Flex Units

500 W Gold Key Lane | Orem, UT 84057

## PROPERTY INFORMATION

- 2,468 SF Total Available
- Unit 1: 1,428 SF (Office: 392 SF, Warehouse: 1,036 SF)  
**Lease Rate: \$2,030/Month MG**
- Unit 3: 1,040 SF - Warehouse only  
**Lease Rate: \$1,450/Month MG**
- 220V | Single phase power
- Flexible term
- Available immediately
- Contact agents for more information

# FLOORPLANS

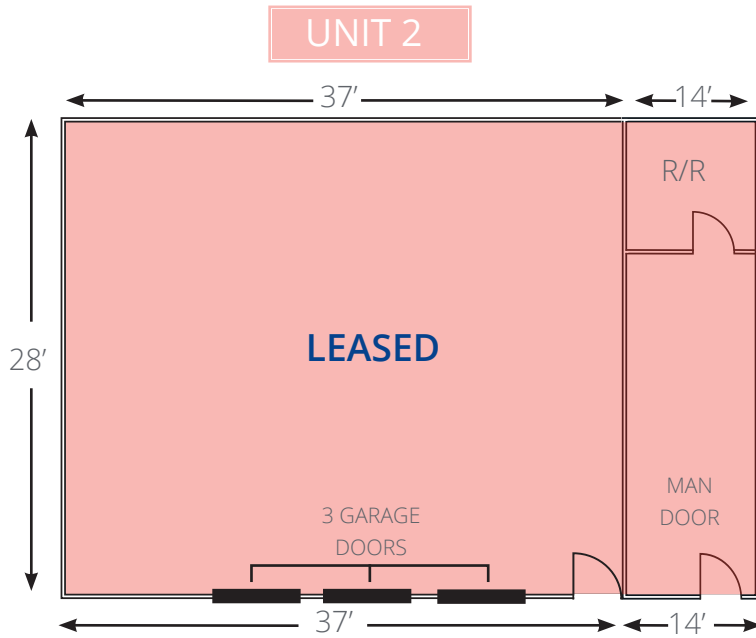
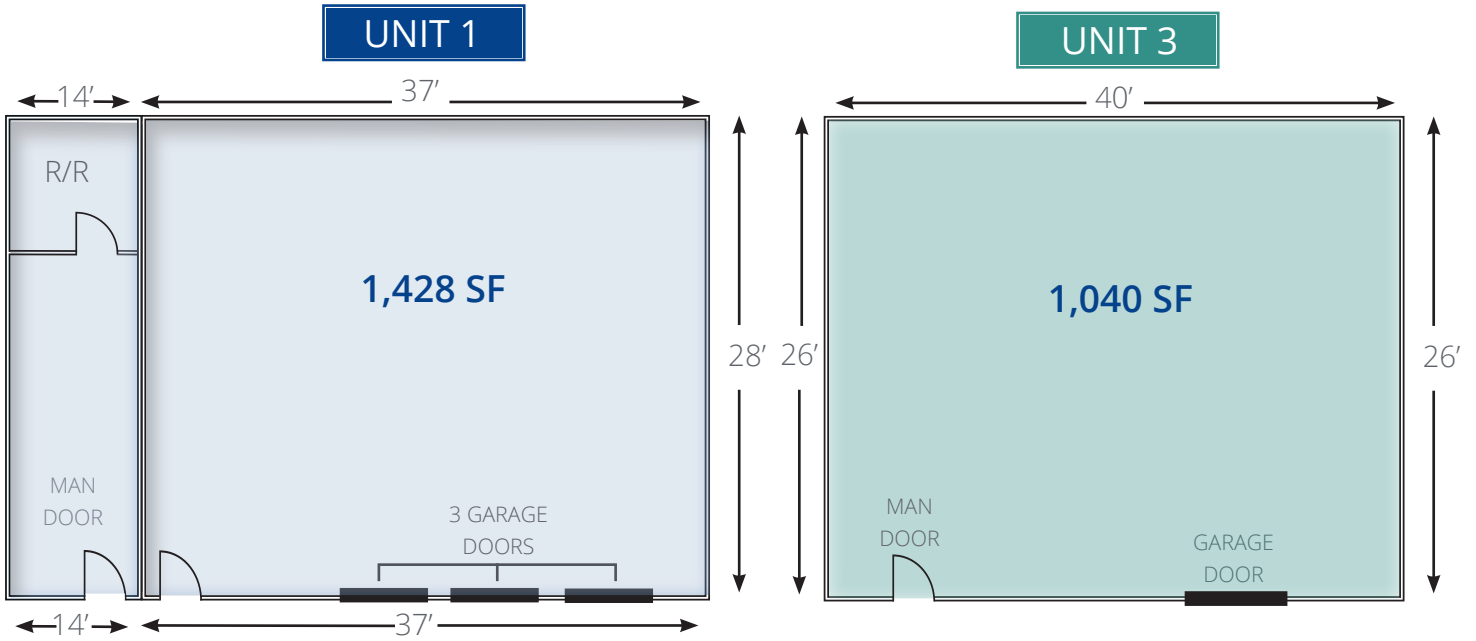



**Colliers**  
 2100 Pleasant Grove Blvd., Suite 200  
 Pleasant Grove, UT 84062  
 Main: +1 801 947 8300  
 colliers.com

**Justin Irvine**  
 Vice President  
 +1 801 400 4260  
 justin.irvine@colliers.com

**James Yeates**  
 Vice President  
 +1 801 995 0049  
 james.yeates@colliers.com

This document has been prepared by Colliers International for advertising and general information only. Colliers International makes no guarantees, representations or warranties of any kind, expressed or implied, regarding the information including, but not limited to, warranties of content, accuracy and reliability. Any interested party should undertake their own inquiries as to the accuracy of the information. Colliers International excludes unequivocally all inferred or implied terms, conditions and warranties arising out of this document and excludes all liability for loss and damages arising therefrom. This publication is the copyrighted property of Colliers International and/or its licensor(s). ©2026. All rights reserved.