

AVAILABLE > INDUSTRIAL SPACE > ±180,000 SF

100 Perfection Way

TIMMONSVILLE, SOUTH CAROLINA 29161



Property Information

Location:	100 Perfection Way Timmons ville, SC 29161	Interstate Access:	I-20: ±0.5 Miles I-95: ±11 Miles
Year Built:	1997	Airport:	Florence Regional: 18 Miles
Site:	±19.5 acres	Lighting:	Metal Halide
Building Area:	Office: ±11,600 SF Mfg/Whse: ±168,400 SF Total: ±180,000 SF	Utilities:	Electricity: Pee Dee Electric Gas: SCE&G Water/Sewer: Darlington County
Parking	±44 paved spaces (additional unpaved space available)	HVAC:	Office only
County:	Darlington County	Sprinkler:	100% wet
Ceiling Heights:	18'-32'	Truck Docks:	Dock high: 4 covered & 2 uncovered Drive-in: (1) 10'x12' & (1) 10'x15'
Constuction:	Floor: Concrete ±6" Walls: Metal with Partial Masonry Facade Roof: Standing Seam Metal Columns: 30' x 50'	Lease Rate:	\$3.25 PSF NNN
		Sales Price:	Please call for pricing

CHUCK W. SALLEY, SIOR
803 401 4266 DIRECT
chuck.salley@colliers.com

DAVE MATHEWS, SIOR
803 401 4293 DIRECT
dave.mathews@colliers.com

THOMAS BEARD
803 401 4247 DIRECT
thomas.beard@colliers.com

COLLIERS INTERNATIONAL
1301 Gervais Street, Suite 600
Columbia, South Carolina 29201
colliers.com

Perfection Way > Aerial and Floor Plan

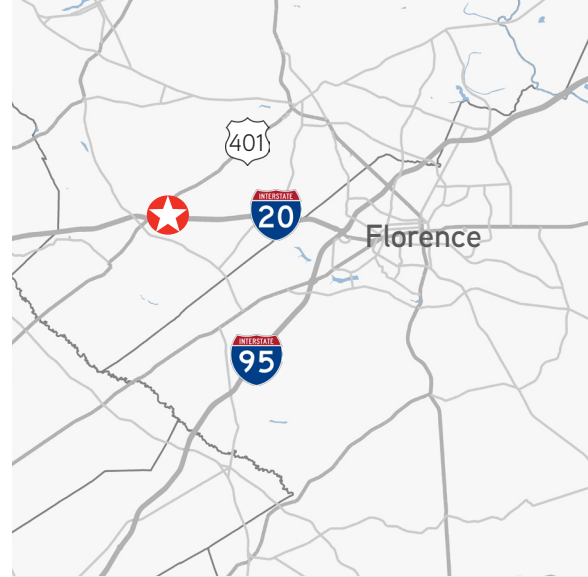

Contact Us

CHUCK W. SALLEY, SIOR

803 401 4266 DIRECT

chuck.salley@colliers.com

DAVE MATHEWS, SIOR

803 401 4293 DIRECT

dave.mathews@colliers.com

THOMAS BEARD

803 401 4247 DIRECT

thomas.beard@colliers.com

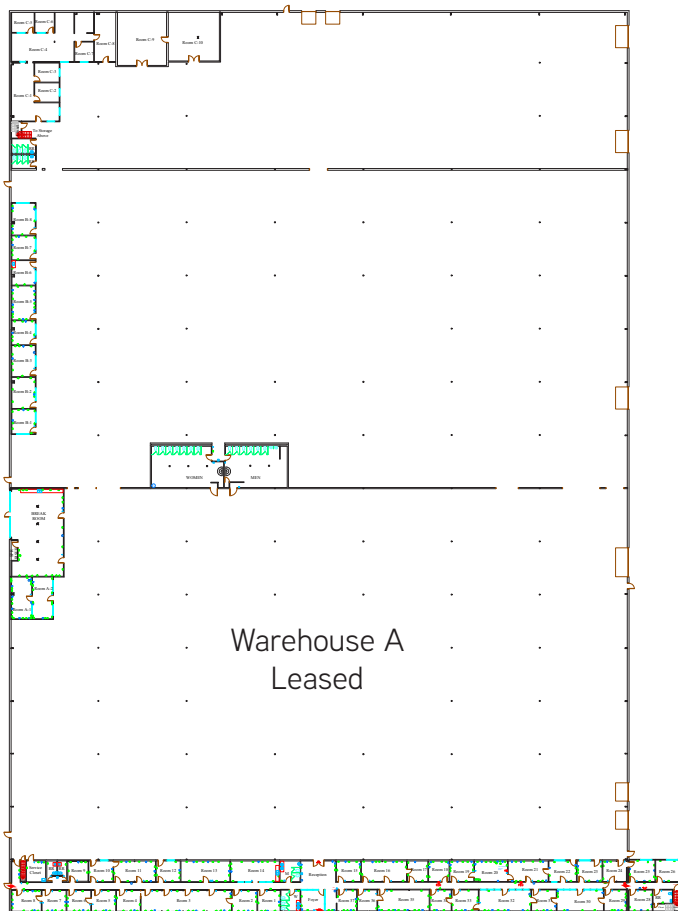

COLLIERS INTERNATIONAL
1301 Gervais Street, Suite 600
Columbia, South Carolina 29201
colliers.com