

FOR SUBLEASE > OFFICE SPACE

Lynnfield Office Park

1555 LYNNFIELD ROAD - BLDG C, MEMPHIS, TN 38119



3,000 SF - 49,377 SF SUBLEASE AVAILABLE



Space Amenities

- > 35,000 SF available on 1st floor; 14,377 SF available on 2nd floor; smallest divisible 3,000 SF
- > Sublease through 7/31/18
- > \$13.00/SF gross rate
- > Steelcase system furniture / plug & play options
- > Generator served
- > Executive board conference room wired for audio visual

Park Amenities

- > Situated in a tranquil park-like setting with manicured interior courtyards
- > Card key building access & roving security

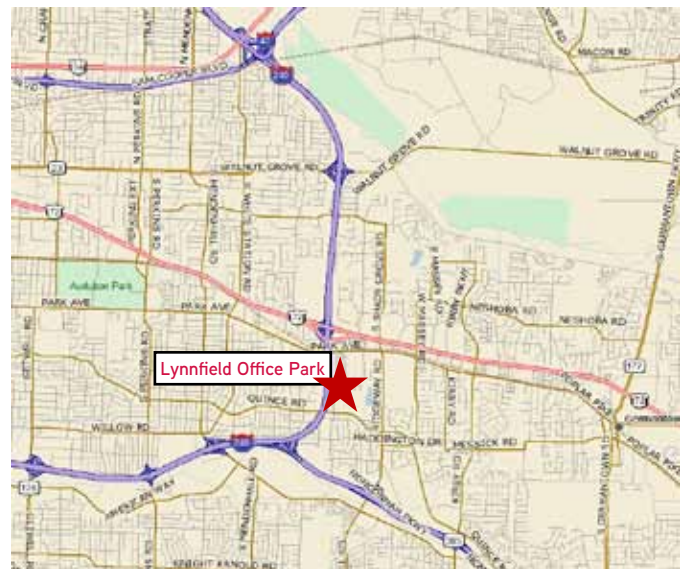

*Located at 1555 Lynnfield Road
just off Park Avenue near Poplar & I-240*

AGENT: LAURA P. TAYLOR
+1 901 312 5772
MEMPHIS, TN
laura.taylor@colliers.com

AGENT: RON RILEY
+1 901 312 5787
MEMPHIS, TN
ron.riley@colliers.com

COLLIERS INTERNATIONAL
6363 Poplar Avenue, Suite 400
Memphis, TN 38119
www.colliers.com

Lynnfield Office Park > Bldg C

Floor Plans

3,000 SF - 49,377 SF Total Sublease Available

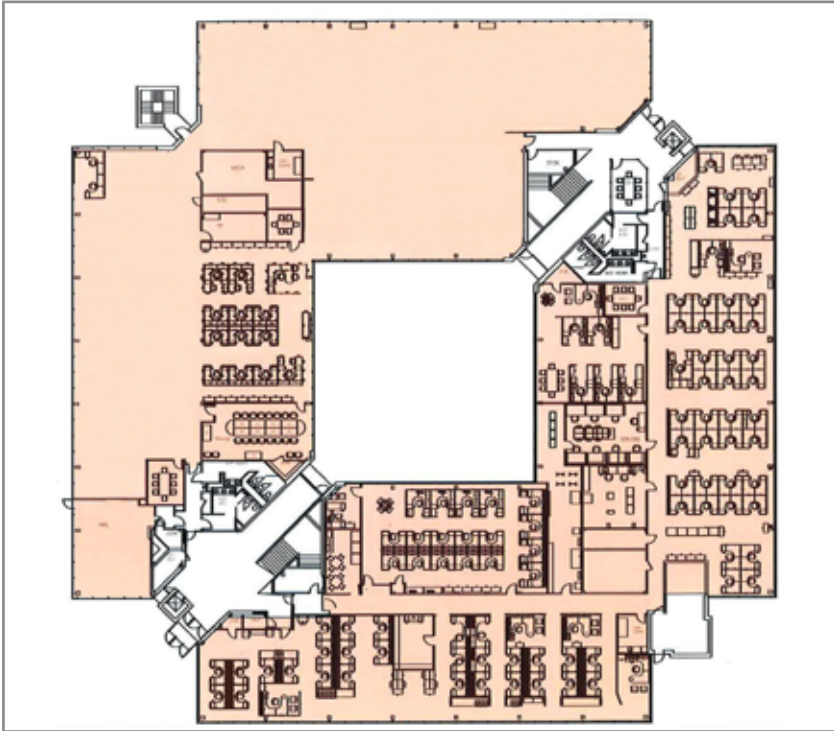

First Floor - 35,000 SF



Second Floor - 14,377 SF



Contact Us

AGENT: LAURA P. TAYLOR

+1 901 312 5772

MEMPHIS, TN

laura.taylor@colliers.com

AGENT: RON RILEY

+1 901 312 5787

MEMPHIS, TN

ron.riley@colliers.com

COLLIERS INTERNATIONAL
6363 Poplar Avenue, Suite 400
Memphis, TN 38119
+1 901 375 4800

www.colliers.com

This document has been prepared by Colliers International for advertising and general information only. Colliers International makes no guarantees, representations or warranties of any kind, expressed or implied, regarding the information including, but not limited to, warranties of content, accuracy and reliability. Any interested party should undertake their own inquiries as to the accuracy of the information. Colliers International excludes unequivocally all inferred or implied terms, conditions and warranties arising out of this document and excludes all liability for loss and damages arising there from. This publication is the copyrighted property of Colliers International and/or its licensor(s). ©2015. All rights reserved.

