



HAWAII KAI TOWNE CENTER

Hawaii Kai Executive Plaza &
Hawaii Kai Corporate Plaza
Suite 217

333 Keahole Street
Honolulu, Hawaii 96825



DEMOGRAPHICS (2017)

	1 Mile	3 Mile	5 Mile
Population	15,264	41,285	69,716
Average Household Income	\$132,265	\$140,329	\$139,304
Median Age	45.6 yrs	45.2 yrs	44.5 yrs
Bachelor Degree or Higher	55.3%	52.2%	48.7%

PROPERTY DETAILS

LOCATION	333 Keahole Street Honolulu, Hawaii 96825
BASE RENT	Negotiable
CAM	\$1.74 PSF/Month((estimated)
AVAILABLE SPACE	Suite 217 - 3,095 SF
TERM	Flexible
LAND AREA	20+ Acres

** Electricity and water charges separately metered*



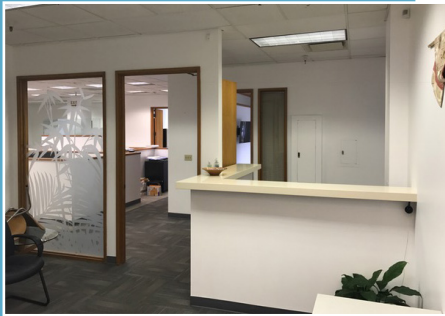

PROPERTY DESCRIPTION

- Hawaii Kai Towne Center is located in one of the most upscale areas in the State
- Beautiful office along Kalanianaʻole Highway, with spectacular ocean views
- Ocean facing offices and conference rooms
- Kitchenette and break room
- Large reception/waiting area
- Ample customer parking
- 24/7 security services

SUITE 217

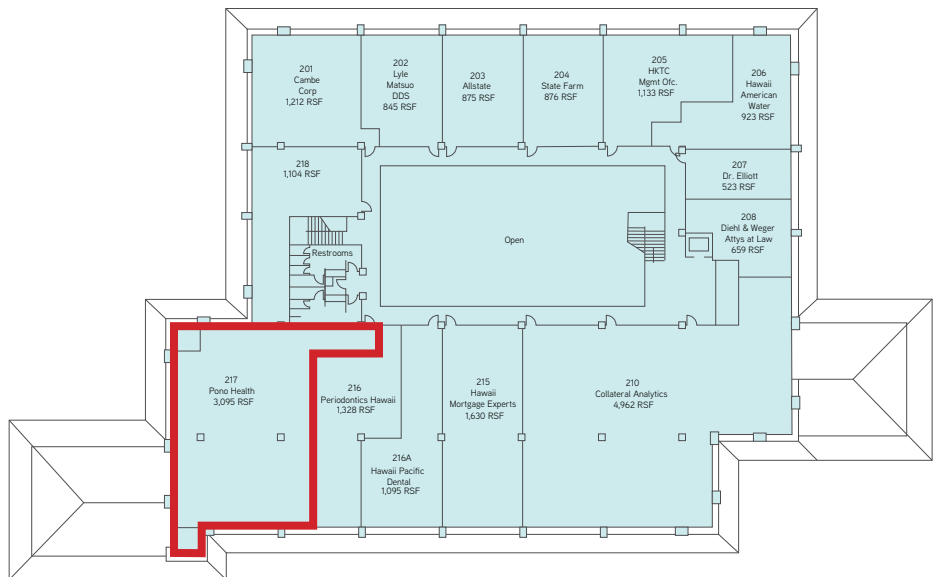

SECOND FLOOR PLAN

BRANDON BERA (S)
Vice President
808.523.8309
brandon.bera@colliers.com

ALEXANDER PEACH (S)
Associate
808.349.6538
alexander.peach@colliers.com

COLLIERS INTERNATIONAL
220 South King Street, Suite 1800
Honolulu, Hawaii 96813
www.colliers.com/hawaii

