

RETAIL / OFFICE SPACE

4060 INDIAN CREEK PARKWAY, OVERLAND PARK, KS

- 1,793 SF retail/office for lease
- Exterior signage facing Indian Creek Parkway
- Drive-up parking in front of building
- Mixed-use building with retail and multifamily units
- Join tenants: Eye Style Optics, Randy Neal Floral Design, inc., Gallery V Fine Arts, and Martin City Brewing Company Pub

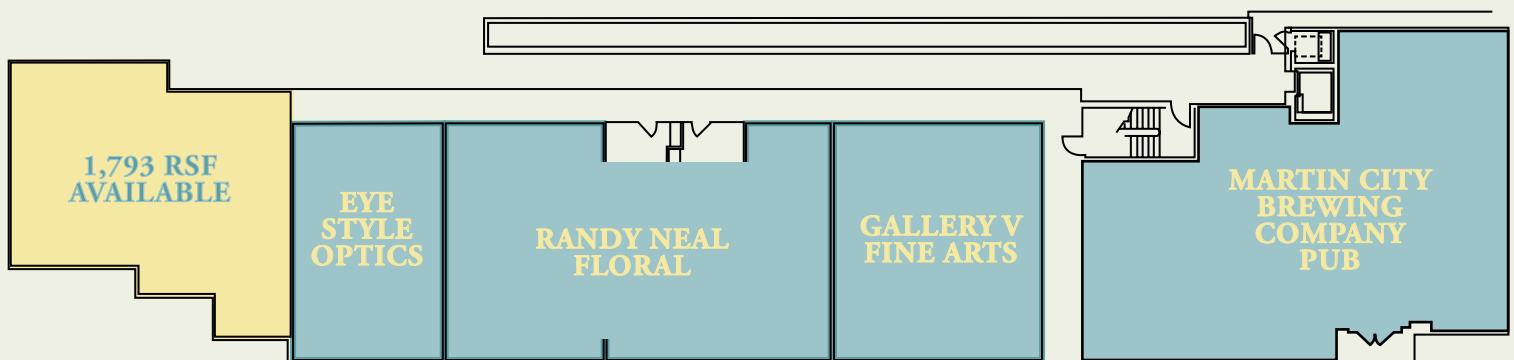

RETAIL / OFFICE SPACE

4060 INDIAN CREEK PARKWAY, OVERLAND PARK, KS



| Demographics | 1-mile | 3-mile | 5-mile |
|-----------------------------|-----------|-----------|-----------|
| Population | 5,879 | 76,229 | 230,342 |
| Daytime Population | 8,134 | 108,439 | 184,881 |
| Population Change 2017-2022 | 0.9% | 0.9% | 0.9% |
| Average HH Income | \$200,278 | \$134,341 | \$107,457 |
| Median HH Income | \$120,285 | \$93,566 | \$82,697 |

RETAIL / OFFICE SPACE

4060 INDIAN CREEK PARKWAY, OVERLAND PARK, KS

