



# WAI'ANAE MALL

86-120 Farrington Hwy, Waianae, HI 96792



**FOR LEASE**  
RETAIL AND OFFICE SPACE



ALEXANDER & BALDWIN  
PARTNERS FOR HAWAII





## PROPERTY DESCRIPTION

Waianae Mall is the heart of retail on the West coast of Oahu. Drugstore anchored with excellent visibility, Waianae Mall boasts great frontage along Farrington Highway. It is a high traffic center with strong community ties and strong sales. National and local tenants include: Long's Drugs, City Mill, Starbucks, Jamba Juice, Pizza Hut, Burger King, Goodyear Tires, American Savings Bank, and Bank of Hawaii.



## 2017 DEMOGRAPHICS

	1 Mile	3 Miles	5 Miles
<b>Population</b>	9,427	34,678	51,738
<b>Average Household Income</b>	\$79,248	\$74,367	\$72,788
<b>Median Age</b>	32.4 yrs	31.2 yrs	31.3 yrs
<b>Bachelor Degree or Higher</b>	741	2,587	4,052



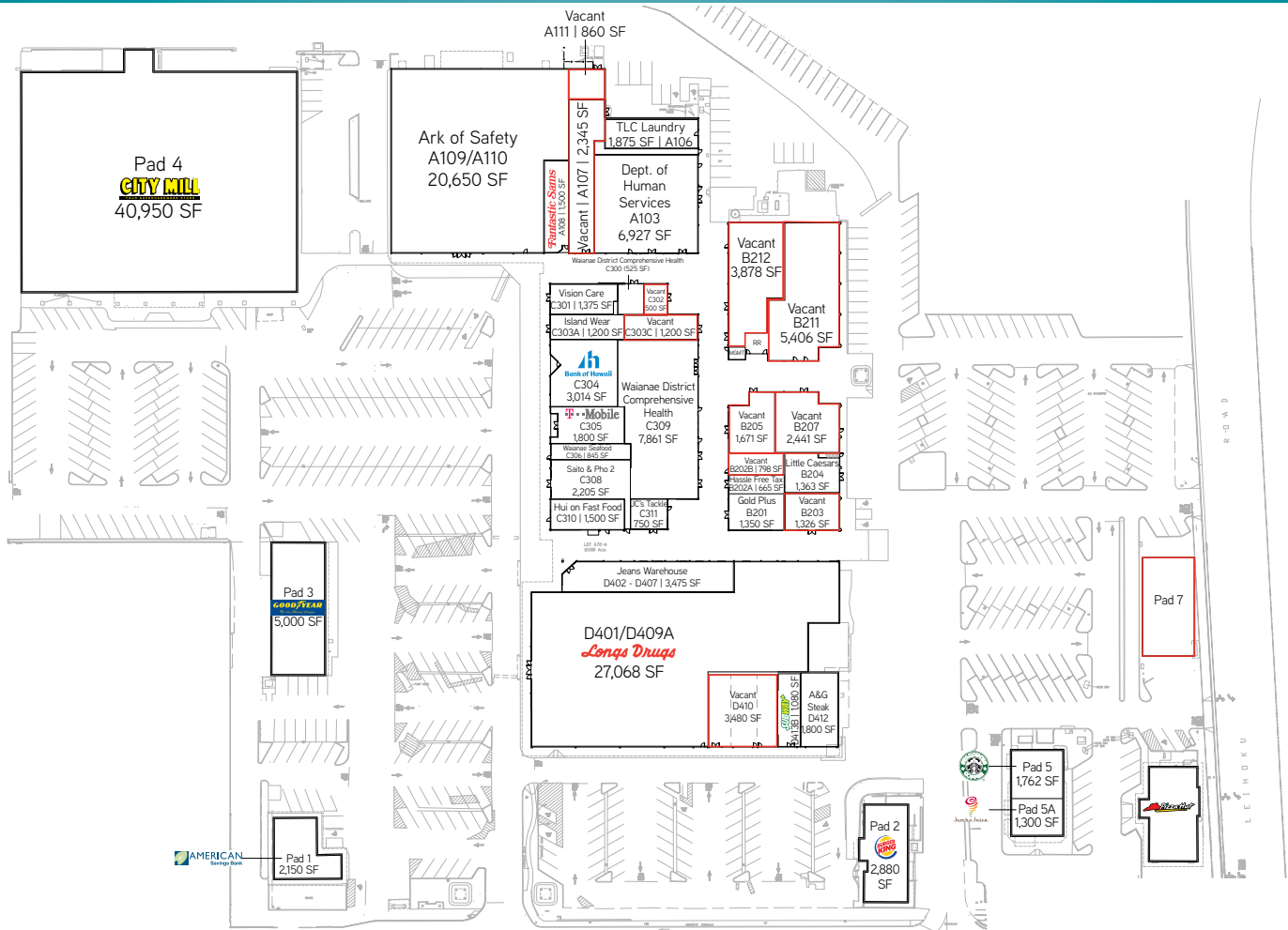

## PROPERTY HIGHLIGHTS

Size Available:	500 - 5,406 sf
Base Rent:	Negotiable
CAM:	\$0.80 psf/month (estimated)
Percentage Rent:	8%
Promotion Fund:	\$0.10 psf/month
Term:	3-5 years





ALEXANDER & BALDWIN  
PARTNERS FOR HAWAII

Alexander & Baldwin, Inc. is a premier Hawaii land company, with interests in real estate development, commercial real estate and agriculture. With ownership of approximately 88,000 acres in Hawaii, A&B is the State's fourth largest private landowner, and is one of the State's most active real estate investors. A&B has a diverse portfolio of real estate development projects throughout Hawaii, and a commercial property portfolio comprising eight million square feet of leasable space in Hawaii and on the U.S. Mainland. It is also the owner and operator of the Hawaiian Commercial & Sugar plantation on Maui, and a significant provider of renewable energy on the islands of Maui and Kauai. Additional information about A&B may be found at <http://www.abprop.com>.



Kaneohe Bay Shopping Center



Kuni Shopping Center



Lanikai Center



Maui Mall



Waipio Shopping Center



The Shops at Kukui Ula

**CATHY G. KONG (S) JD**  
Associate  
Retail Services Group &  
Shopping Center Division  
808 541 7392  
[cathy.kong@colliers.com](mailto:cathy.kong@colliers.com)

**NATHAN A. FONG (B)**  
Senior Vice President  
Retail Services Group &  
Shopping Center Division  
808 295 2582  
[nathan.fong@colliers.com](mailto:nathan.fong@colliers.com)

COLLIERS INTERNATIONAL  
220 South King Street, Suite 1800  
Honolulu, Hawaii 96813  
[www.colliershawaii.com](http://www.colliershawaii.com)



This document has been prepared by Colliers International for advertising and general information only. Colliers International makes no guarantees, representations or warranties of any kind, expressed or implied, regarding the information including, but not limited to, warranties of content, accuracy and reliability. Any interested party should undertake their own inquiries as to the accuracy of the information. Colliers International excludes unequivocally all inferred or implied terms, conditions and warranties arising out of this document and excludes all liability for loss and damages arising there from. This publication is the copyrighted property of Colliers International and/or its licensor(s). ©2015. All rights reserved.