

FOR LEASE > RETAIL

# 1675 Washington Road

PITTSBURGH, PA 15228



## Property Highlights

- > 2,000-8,000 SF Available
- > Prime South Hills location in Mt. Lebanon
- > \$15.00/SF - Well below market rate
- > Up to 52 parking spaces available
- > Near Trader Joes, Pazzo, The Galleria and Fresh Market
- > 35,000 average daily traffic

## Demographics

	<u>1 Mile</u>	<u>3 Miles</u>	<u>5 Miles</u>
Population	12,262	101,954	244,679
Households	5,409	44,888	109,173
Avg. Household Income	\$113,633	\$97,250	\$84,997
Daytime Demographics	12,382	12,382	169,742

MARK ANDERSON  
VICE PRESIDENT | PITTSBURGH  
RETAIL SERVICES  
412 321 4200 | EXT. 222  
marke.anderson@colliers.com

COLLIERS INTERNATIONAL | PITTSBURGH  
Two Gateway Center  
603 Stanwix Street, Suite 125  
Pittsburgh, PA 15222  
www.colliers.com/pittsburgh



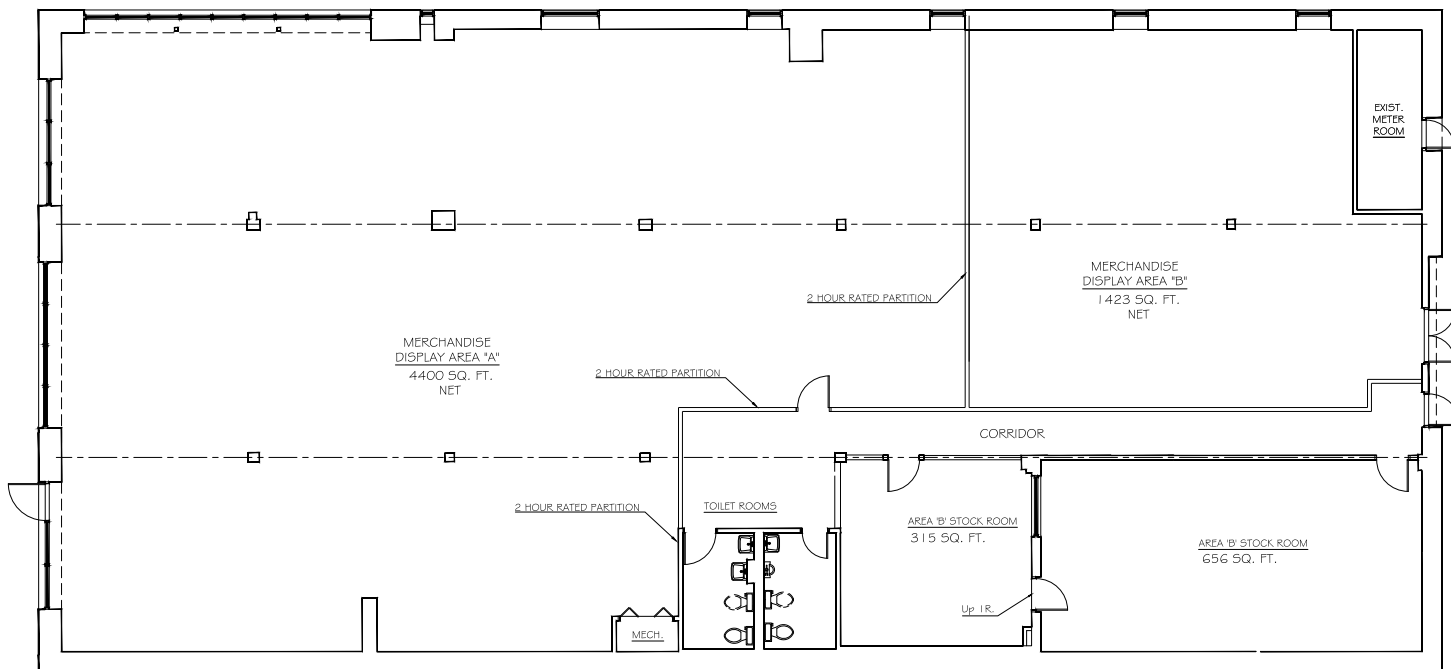

## Contact Us

MARK ANDERSON  
VICE PRESIDENT | PITTSBURGH  
RETAIL SERVICES  
412 321 4200 | EXT. 222  
[marke.anderson@colliers.com](mailto:marke.anderson@colliers.com)

COLLIERS INTERNATIONAL | PITTSBURGH  
Two Gateway Center  
603 Stanwix Street, Suite 125  
Pittsburgh, PA 15222  
[www.colliers.com/pittsburgh](http://www.colliers.com/pittsburgh)

The information contained herein has been given to us by the owner of the property or other sources we deem reliable. We have no reason to doubt its accuracy, but we do not guarantee it. All information should be verified prior to purchase or lease.

