



897 12TH STREET, HAMMONTON, NJ

Proposed Floor Plan

Option One

TENANT A

Warehouse	7607.9 SF
Office	921.6 SF
Total	8,529.5 SF

TENANT B

Warehouse	5,315.1 SF
Office	589 SF
Total	5,904.1 SF

TENANT C

Warehouse	14222.0 SF
Office	1728.9 SF
Total	15,950.9 SF

- WAREHOUSE
- OFFICE
- BATHROOM
- LD** LOADING DOCK

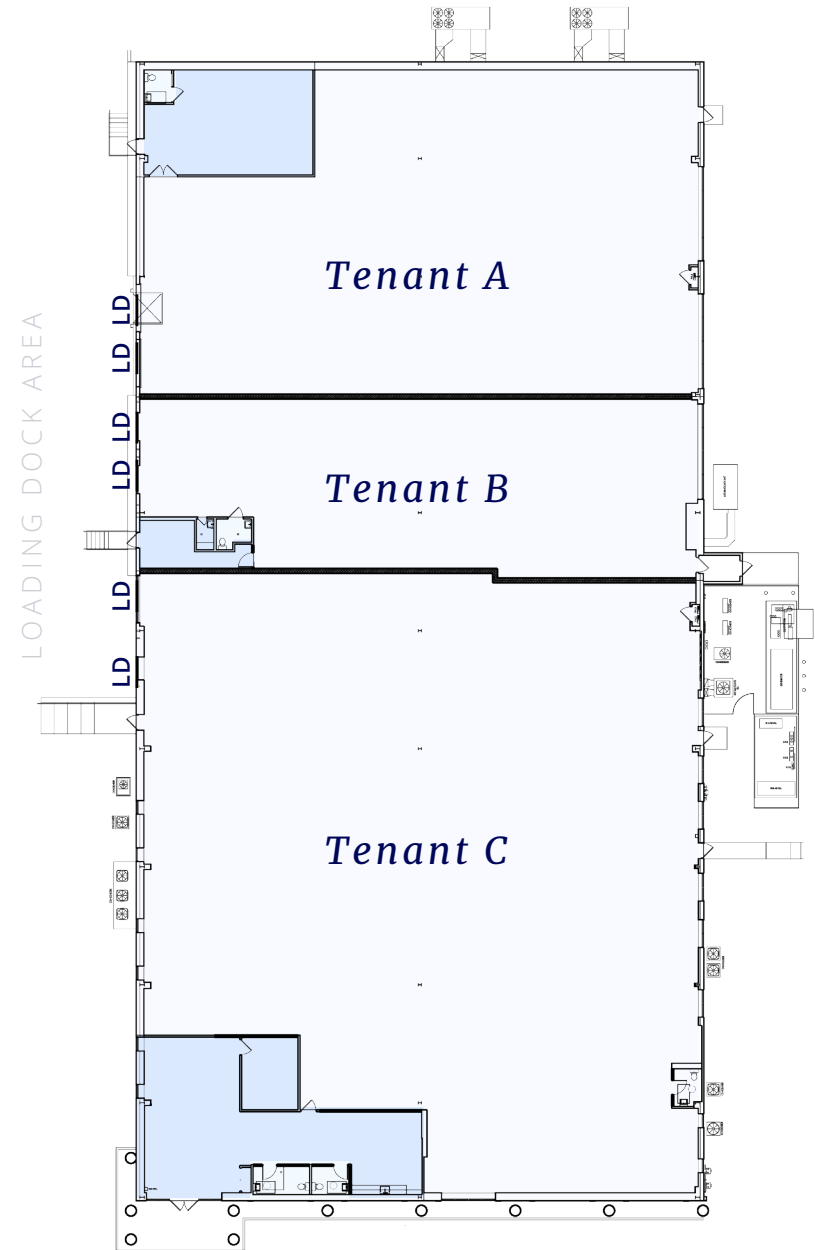

12TH STREET

Ross Abramsohn
 Vice President
 +1 609 760 6139
ross.abramsohn@colliers.com

Colliers
 250 Century Parkway, Suite 100
 Mount Laurel, NJ 08054
colliers.com



897 12TH STREET, HAMMONTON, NJ

Proposed Floor Plan

Option Two

TENANT A	
Warehouse	12,838.1 SF
Office	921.8 SF
Total	13,759.9 SF

TENANT B	
Warehouse	12,602.0 SF
Office	2703.4 SF
Total	15,305.4 SF

WAREHOUSE

OFFICE

BATHROOM

LD LOADING DOCK

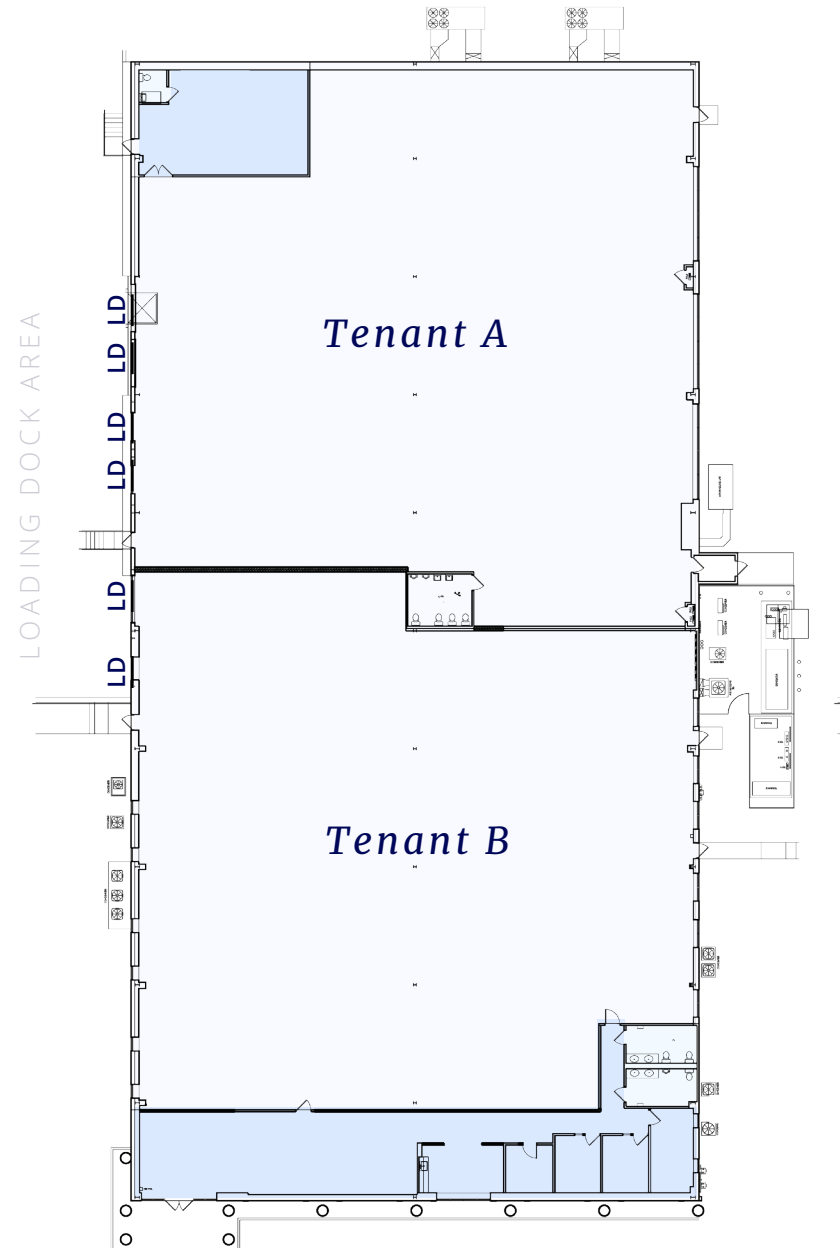

Ross Abramsohn
 Vice President
 +1 609 760 6139
ross.abramsohn@colliers.com

Colliers
 250 Century Parkway, Suite 100
 Mount Laurel, NJ 08054
colliers.com

12TH STREET



897 12TH STREET, HAMMONTON, NJ

Proposed Floor Plan

Option Three

TENANT A	
Warehouse	26,330.8 SF
Office	2,734.5 SF
Total	29,065.3 SF

WAREHOUSE

OFFICE

BATHROOM

LD LOADING DOCK

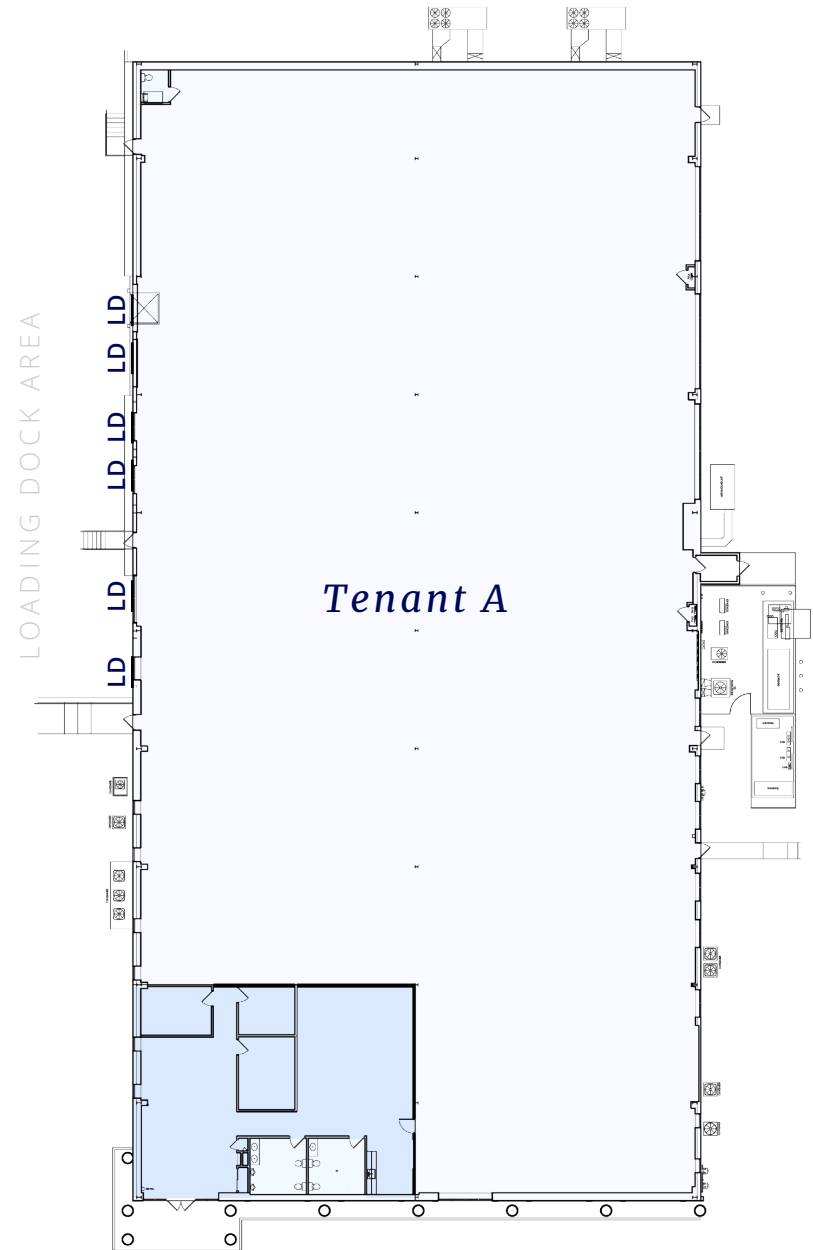

Ross Abramsohn
 Vice President
 +1 609 760 6139
ross.abramsohn@colliers.com

Colliers
 250 Century Parkway, Suite 100
 Mount Laurel, NJ 08054
colliers.com

12TH STREET