

RETAIL SPACE AVAILABLE FOR ASSIGNMENT/SUBLEASE

KANEOHE BAY SHOPPING CENTER

46-047 Kamehameha Hwy, Kaneohe, HI 96744



PLEASE DO NOT DISTURB EXISTING TENANT

Property Description

Excellent and rare opportunity to take over a highly visible restaurant in Kaneohe Bay Shopping Center. This space is located along the retail corridor which is right across from the Windward Mall in Kaneohe, fronting on busy Kamehameha Highway across from schools and the residential population.

Anchored by Safeway and Long's Drugs, and a variety of eateries, including Brick Oven Pizza and Panda Express, this center provides customers with a neighborhood destination for their daily needs.



ANDY KAZAMA (S)
Retail Services Division
808 523 9755
andy.kazama@colliers.com

CATHY G. KONG (S) JD
Retail Division
808 541 7392
cathy.kong@colliers.com

COLLIERS INTERNATIONAL | HAWAII 220
S. King Street, Suite 1800
Honolulu, Hawaii 96813
colliers.com/hawaii



RETAIL SPACE AVAILABLE FOR ASSIGNMENT/SUBLEASE

KANEOHE BAY SHOPPING CENTER

46-047 Kamehameha Hwy, Kaneohe, HI 96744



Property Highlights

Area	Kaneohe
TMK No	1-4-6-2-14 (portion of)
Zoning	B-2
Size Available	3,660 SF
Base Rent	\$11,328.25* (through 10/14/2018) <i>*Increasing Annually By 3%</i>
Operating Expenses	\$2,444.00 (estimated)
Premiums	\$175,000.00
Term	Until 10/14/2020

Features & Benefits

- Turn key restaurant opportunity
- Includes cooking exhaust and grease trap
- Great visibility along Kamehameha Hwy, across from Windward Mall
- Convenient and ample parking
- Located within major anchors such as: Safeway, Longs Drugs/CVS and O'Reilly Auto Parts



ANDY KAZAMA (S)
Retail Services Division
808 523 9755
andy.kazama@colliers.com

CATHY G. KONG (S) JD
Retail Services Division
808 541 7392
cathy.kong@colliers.com

COLLIERS INTERNATIONAL | HAWAII 220
S. King Street, Suite 1800
Honolulu,, Hawaii 96813
colliers.com/hawaii





KANEOHE BAY SHOPPING CENTER

RETAIL SPACE AVAILABLE FOR ASSIGNMENT/SUBLEASE

KANEOHE BAY SHOPPING CENTER

46-047 Kamehameha Hwy, Kaneohe, HI 96744

Location Description

This is a one of a kind opportunity to be a part of the Kaneohe Bay Shopping Center, anchored by Safeway, Long's/CVS, and O'Reilly Auto Parts, Goodyear Tire, and the community's favorite restaurants and banks.

2017 Demographics

	1 Mile	3 Mile	5 Mile
Population	15,380	50,682	88,082
Average Household Income	\$103,430	\$109,371	\$112,948
Median Age	38.6 yrs	40.3 yrs	37.8 yrs
Bachelor Degree or Higher	3,863	3,285	22,375

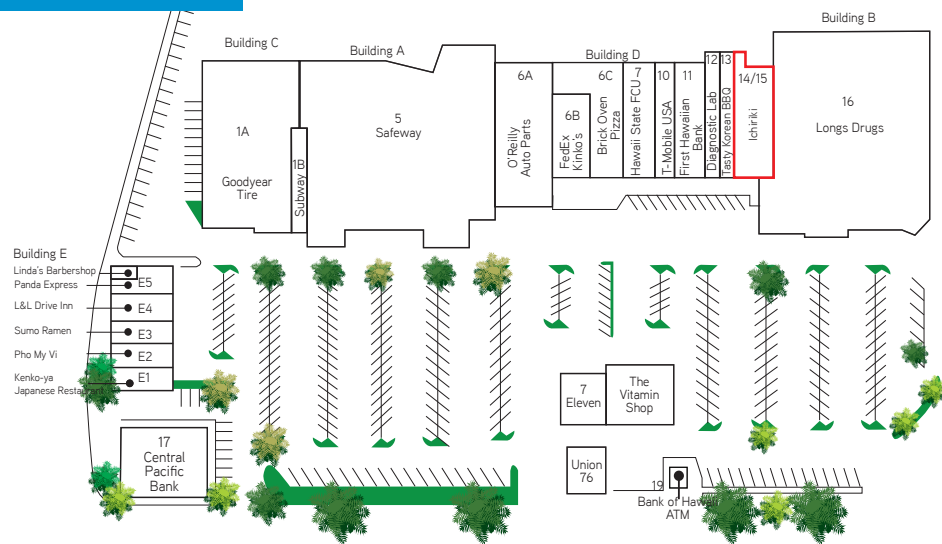

KAMEHAMEHA HIGHWAY

ANDY KAZAMA (S)
Retail Services Division
808 523 9755
andy.kazama@colliers.com

CATHY G. KONG (S) JD
Retail Services Division
808 541 7392
cathy.kong@colliers.com

COLLIERS INTERNATIONAL | HAWAII 220
S. King Street, Suite 1800
Honolulu, Hawaii 96813
colliers.com/hawaii



RETAIL SPACE AVAILABLE FOR ASSIGNMENT/SUBLEASE

KANEOHE BAY SHOPPING CENTER

46-047 Kamehameha Hwy, Kaneohe, HI 96744



Contact Us

ANDY KAZAMA (S)
Retail Services Division
808 523 9755
andy.kazama@colliers.com

CATHY G. KONG (S) JD
Retail Services Division
808 541 7392
cathy.kong@colliers.com

COLLIERS INTERNATIONAL
220 S. King Street, Suite 1800
Honolulu, HI 96813
www.colliers.com/hawaii



Copyright © 2017 Colliers International

This document has been prepared by Colliers International for advertising and general information only. Colliers International makes no guarantees, representations or warranties of any kind, expressed or implied, regarding the information including, but not limited to, warranties of content, accuracy and reliability. Any interested party should undertake their own inquiries as to the accuracy of the information. Colliers International excludes unequivocally all inferred or implied terms, conditions and warranties arising out of this document and excludes all liability for loss and damages arising there from. This publication is the copyrighted property of Colliers International and/or its licensor(s). All rights reserved.