

Simmons Bank Plaza

Simmons Plaza

4220 N RODNEY PARHAM,
LITTLE ROCK, AR 72212
Sublease Opportunity

Dickson Flake, CRE, CCIM, SIOR
Broker
501.372.6161 | 706
dickson.flake@colliers.com

Lee Strother, CCIM
Principal & VP of Brokerage
501.372.6161 | 703
lee.strother@colliers.com



Newly Constructed Large Office Space Availability

Property Description

Conveniently situated on Cantrell Road and Rodney Parham Road, the subject property offers 7,976 square feet in one of the city's most desired locations. Newly renovated in 2016, this class "A+" space is outfitted for general office use without interior improvements.

Property Information

- Sublease rate: \$21.50/SF, FSG
- Suite size: 7,976 SF
- Excellent access to I-430
- Close proximity to a variety of retailers and restaurants
- Signalized access at Cantrell Road and Rodney Parham Road



Current Floor Plan

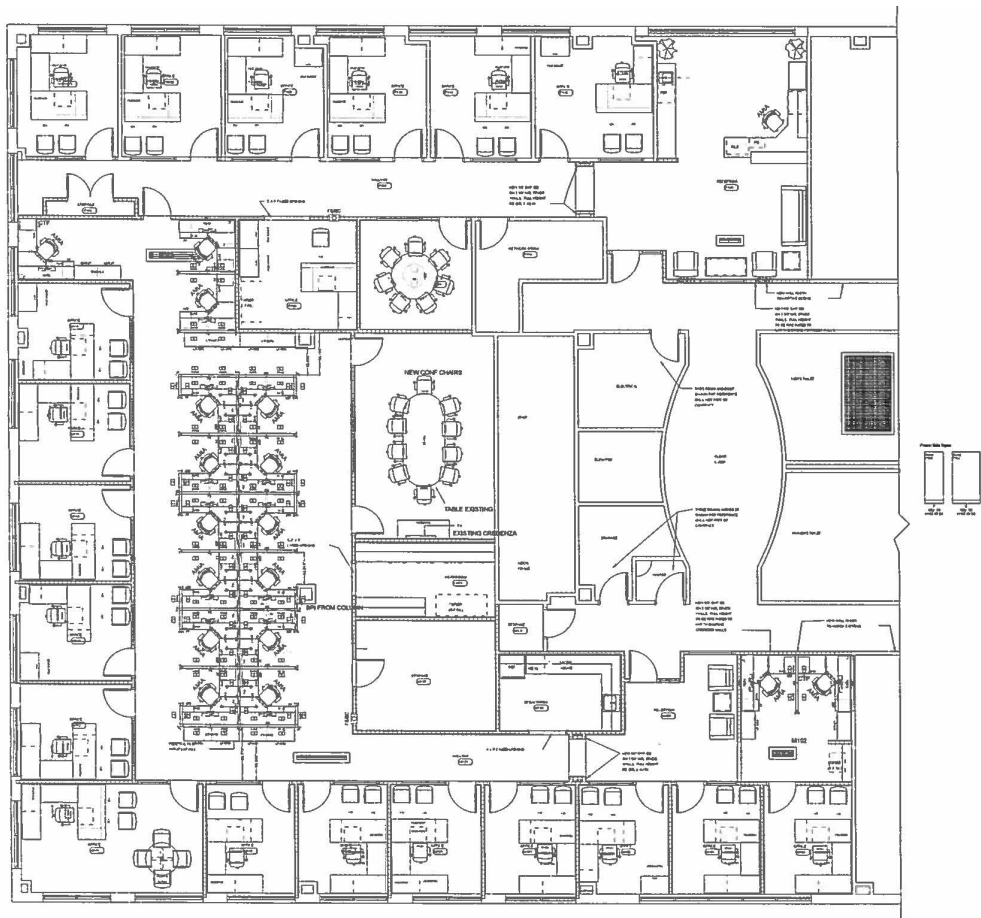

Interior/Exterior Photos



North Lobby



Existing Conference Room



South Lobby



Building Exterior



1 Allied Drive,
Suite 1500
Little Rock, AR 72202
501.372.6161
colliers.com/arkansas

