



St. Pete Pier™

St. Petersburg, Florida

Stephanie Addis
Director, Retail Services
813 222 0484
Stephanie.Addis@Colliers.com



St. Pete Pier™

Available Space:

Main Pier Building:

6,920 SF Main restaurant
5,388 SF Roof deck restaurant seating
available

792 SF Patio Level Cafe
2,853 SF outdoor seating area

Pier Plaza:

740 SF Pavilion Cafe
2,130 SF outdoor covered area

Term: Up to 10 years

Rental rates: Call for details



Property Highlights

The restaurant at the main Pier building will offer a unique opportunity for a premier waterfront dining experience with unparalleled views of Tampa Bay. Tapping into an already robust restaurant market along Beach Drive and greater downtown St Petersburg, the St. Pete Pier™ is projected to generate approximately \$30 million in food and beverage expenditures both within and beyond the subject property. An estimated 1.7 million annual visitors are expected to take in the sights, tastes and sounds of the The Pier District, which is comprised of the Pier approach and the Pier head. The Pier approach encompasses the portion of the project from Bayshore Boulevard to Spa Beach, including the Pelican Lot, with the area stretching from Spa Beach to the main Pier building referred to as the Pier head. The property will be 3,065 feet in length over 26 acres of prime waterfront land.

Features include:

- ◇ complimentary pedestrian tram running the entire length of the Pier
- ◇ fishing deck and bait shop
- ◇ lawn bowl and event plaza
- ◇ education center and wet classroom
- ◇ family park
- ◇ walking waterfront
- ◇ public courtesy boat slips for easy public access via boat

For more information, please visit:
www.newstpetepier.com



NOW PRE-LEASING
RESTAURANT/ CAFE SUITES





MAIN PIER BUILDING

792 SF Patio Level Cafe
2,853 SF outdoor seating area (patio level)





MAIN PIER BUILDING

6,920 SF Main Restaurant
5,388 SF Roof Deck

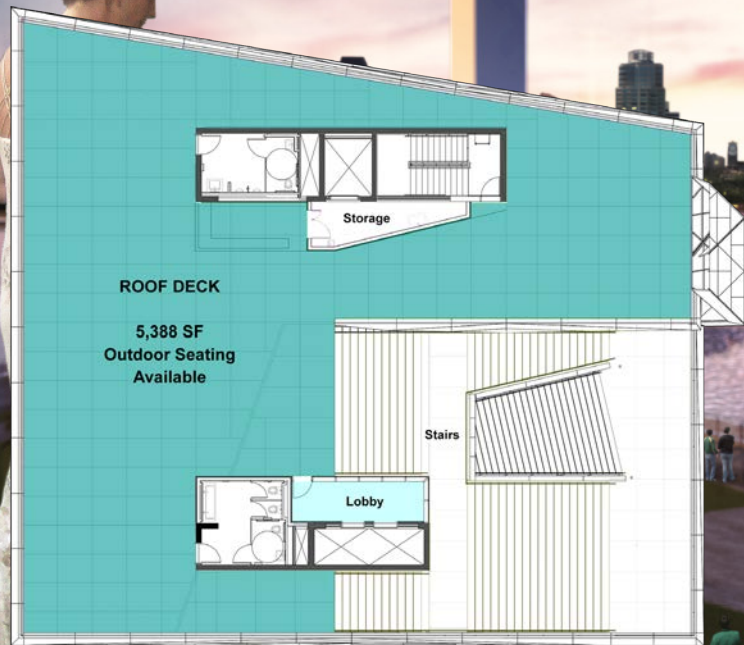



PAVILION CAFE - Pier Approach

740 SF Cafe/Restaurant available
2,130 SF outdoor covered area

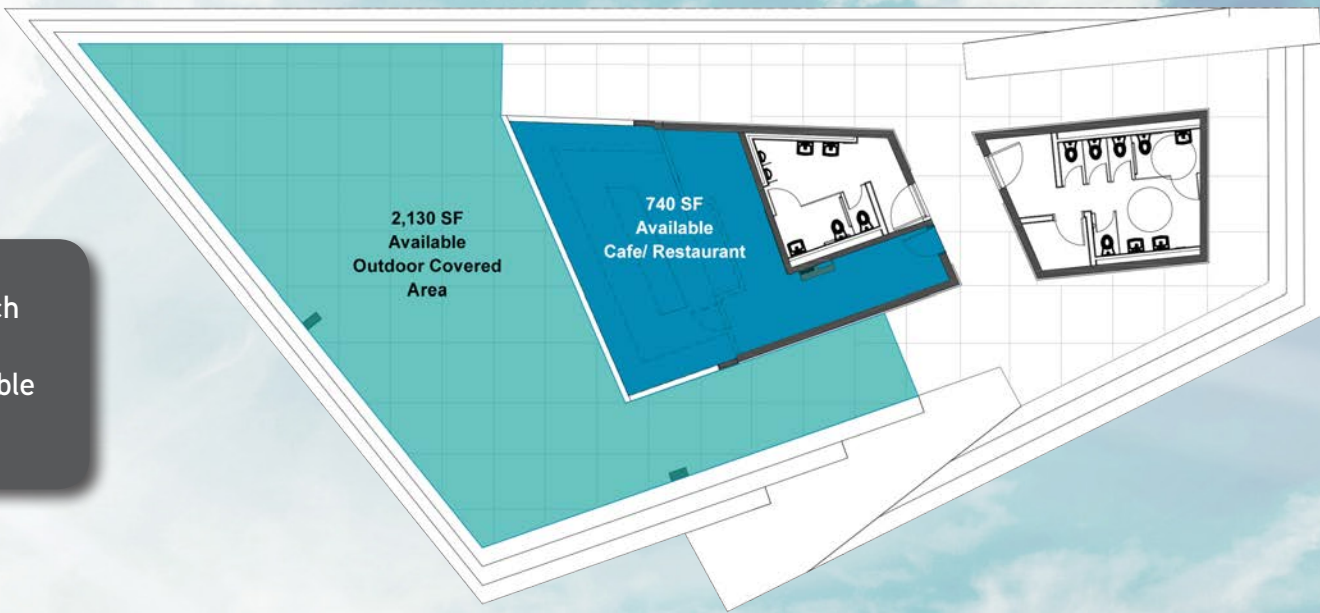

Population Summary:

	1 Mile	3 Mile	5 Mile
Total Population	13,669	83,769	209,024
Daytime Population: Workers	21,307	48,513	75,564
Daytime Population: Residents	6,792	45,579	112,841
Households	8,203	37,532	90,830
Families	2,159	18,276	49,103
Average Household Size	1.57	2.16	2.26
Median Age	49.2	42.7	43.3

Income & Households Summary:

Average Household Income	\$63,386	\$63,342	\$62,294
Median Household Income	\$35,817	\$40,159	\$41,924
Households w/ Income \$50k+	3,018	15,756	39,060

St. Petersburg/Clearwater
Visitor Statistics

Average length of stay 2015	5.6 nights
Overnight visitors 2015	6,197,500
Overnight visitors 2016	6,349,500
Economic impact of visitors 2015	\$9,253,897,100
Increase from 2015-2016	+5.2%
Economic impact of visitors 2016	\$9,733,073,100



EXISTING AND PLANNED RESIDENTIAL DEVELOPMENTS



POINTS OF INTEREST



JOHNS HOPKINS
MEDICINE
JOHNS HOPKINS
ALL CHILDREN'S HOSPITAL

RAYS

CHIHULY
COLLECTION

USFSP UNIVERSITY OF SOUTH FLORIDA
ST. PETERSBURG

ALBERT WHITTED
AIRPORT

THE DAZ
MUSEUM

The Mahaffey
Theater

ROWDIES

James
Museum of
Western &
Wildlife Art

Museum of the
American Arts &
Crafts Movement

MFA

St. Petersburg
Museum of History

Bayshore Boulevard

Beach Drive

The New
St. Pete Pier™

RENAISSANCE®
VINOY® RESORT & GOLF CLUB
ST. PETERSBURG



For Leasing, Contact:

Stephanie Addis
Director, Retail Services
813 222 0484
stephanie.addis@colliers.com

