



## VACANT LAND For Sale

TOM POSTMA  
DIR 616 355 3145  
MOB 616 283 2411  
[tom.postma@colliers.com](mailto:tom.postma@colliers.com)



COLLIERS INTERNATIONAL  
44 East 8th Street, Suite 510  
Holland, MI 49423  
+1 616 394 4500  
[www.colliersholland.com](http://www.colliersholland.com)

### Holland Avenue Holland, MI 49424

Vacant Land available for sale. 4.52 Acres for industrial use. Great location off of US-31. Beautiful corner lot located in North Holland Commerce Park. Streets have been improved with curb, gutter, overhead lighting and underground utilities. 198 tax district will significantly lower real estate taxes with no front foot water and sewer assessments.

# Holland Avenue, Holland, MI

## SITE PLAN

Seller has topographic/boundary surveys, environments, soil borings, and potential site plan available upon request. Possible build up to 55,900 SF on site (see yellow highlighted section).

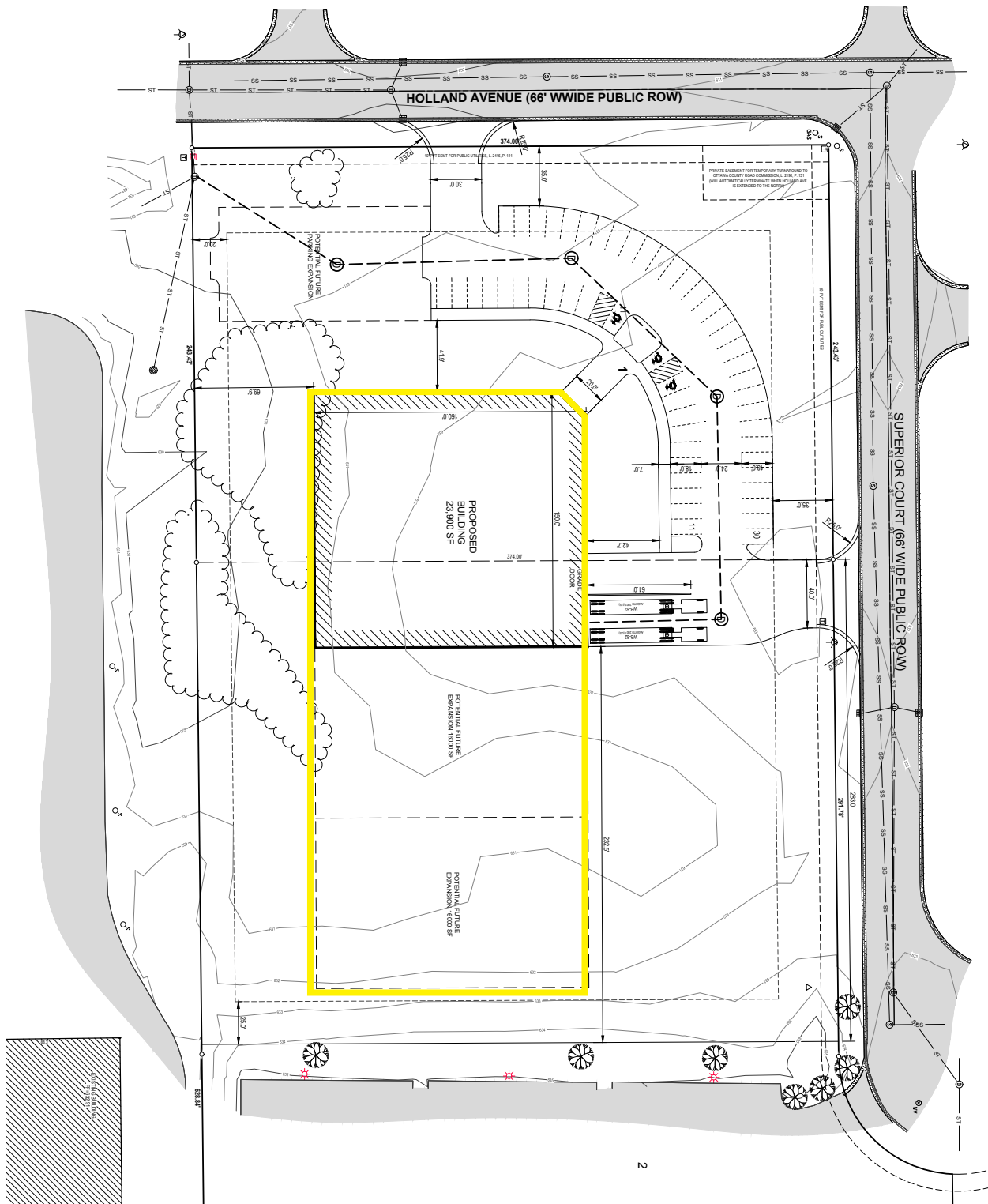

# Holland Avenue, Holland, MI

## LAND AMENITIES

- › Great access to US-31
- › Surrounding businesses include:  
Dri-Design, Intella Liftparts, Dean Transportation, JR Automation Technologies, Carlton Technologies
- › Water & Sewer: Holland BPW
- › Gas: Semco
- › Electric: Holland BPW
- › Internet & Phone: Choice
- › No assessments
- › Site plans available: topographic surveys, environmental, and soil borings

## SALE INFORMATION

- › Sale Price: \$248,600
- › Sale Price/Acre: \$55,000
- › Total Acreage: 4.52
- › Zoning: PUD - Industrial
- › 198 Tax Abatement available

## AERIAL PHOTO



This document has been prepared by Colliers International for advertising and general information only. Colliers International makes no guarantees, representations or warranties of any kind, expressed or implied, regarding the information including, but not limited to, warranties of content, accuracy and reliability. Any interested party should undertake their own inquiries as to the accuracy of the information. Colliers International excludes unequivocally all inferred or implied terms, conditions and warranties arising out of this document and excludes all liability for loss and damages arising there from. This publication is the copyrighted property of Colliers International and/or its licensor(s). ©2016. All rights reserved.

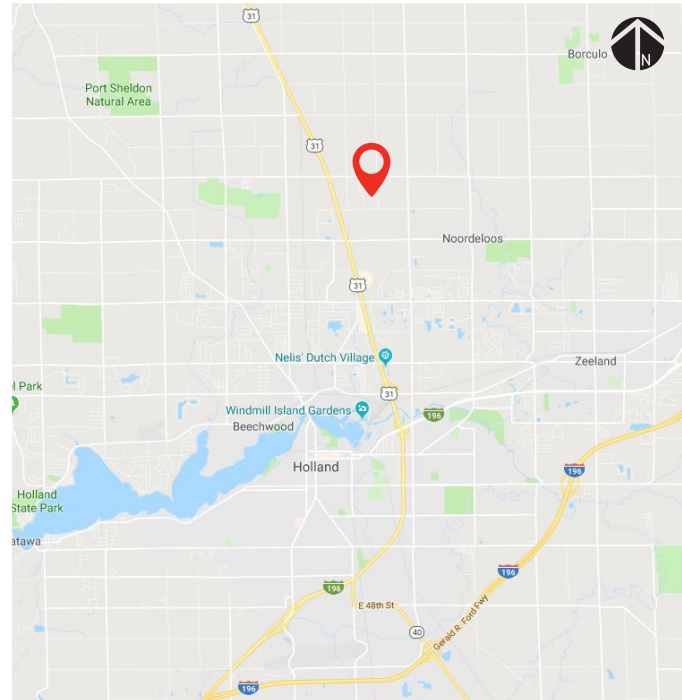

## CONTACT US

**TOM POSTMA**

DIR 616 355 3145

MOB 616 283 2411

[tom.postma@colliers.com](mailto:tom.postma@colliers.com)



**COLLIERS INTERNATIONAL**  
44 East 8th Street, Suite 510  
Holland, MI 49423  
+1 616 394 4500  
[www.colliers.com](http://www.colliers.com)