

FOR LEASE > OFFICE SPACE

ONE TURNBERRY PLACE

AVENTURA, FL 33180

19495 BISCAYNE
BOULEVARD
EXCELLENT
LOCATION WITHIN
MINUTES OF RETAIL
AND DINING



Available Spaces

Suite 403 – 1,310 sf

Suite 801– 2,533 sf

Building Features

- > Class A Trophy office building
- > City and ocean views
- > On-site bank with drive-through ATM
- > On-site café
- > On-site salon
- > Valet parking
- > 24-hour security
- > On-site management
- > On-site engineer

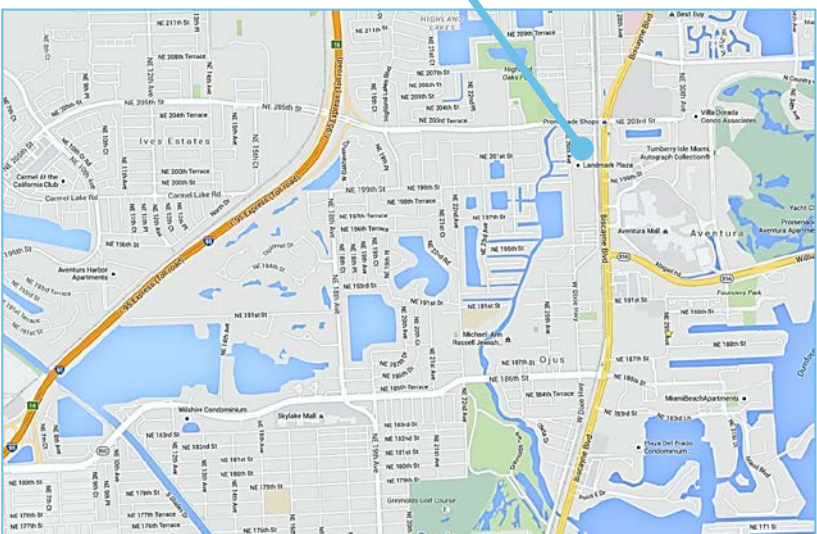

Colliers
INTERNATIONAL

COLLIERS INTERNATIONAL
SOUTH FLORIDA
200 E Broward Blvd., Suite 120
Ft. Lauderdale, FL 33301
www.colliers.com

JONATHAN KINGSLEY
+ 1 305 785 2665
jonathan.kingsley@colliers.com

www.oneturnberryaventura.com

ONE TURNBERRY PLACE

FLOOR PLAN – SUITE 403

OPPORTUNITY >

FLEXIBLE OFFICE SPACE IN AVENTURA

- ELEVATOR LOBBY EXPOSURE
- LARGE OPEN AREA
- UP TO FOUR (4) PRIVATE OFFICES

1,310 RSF

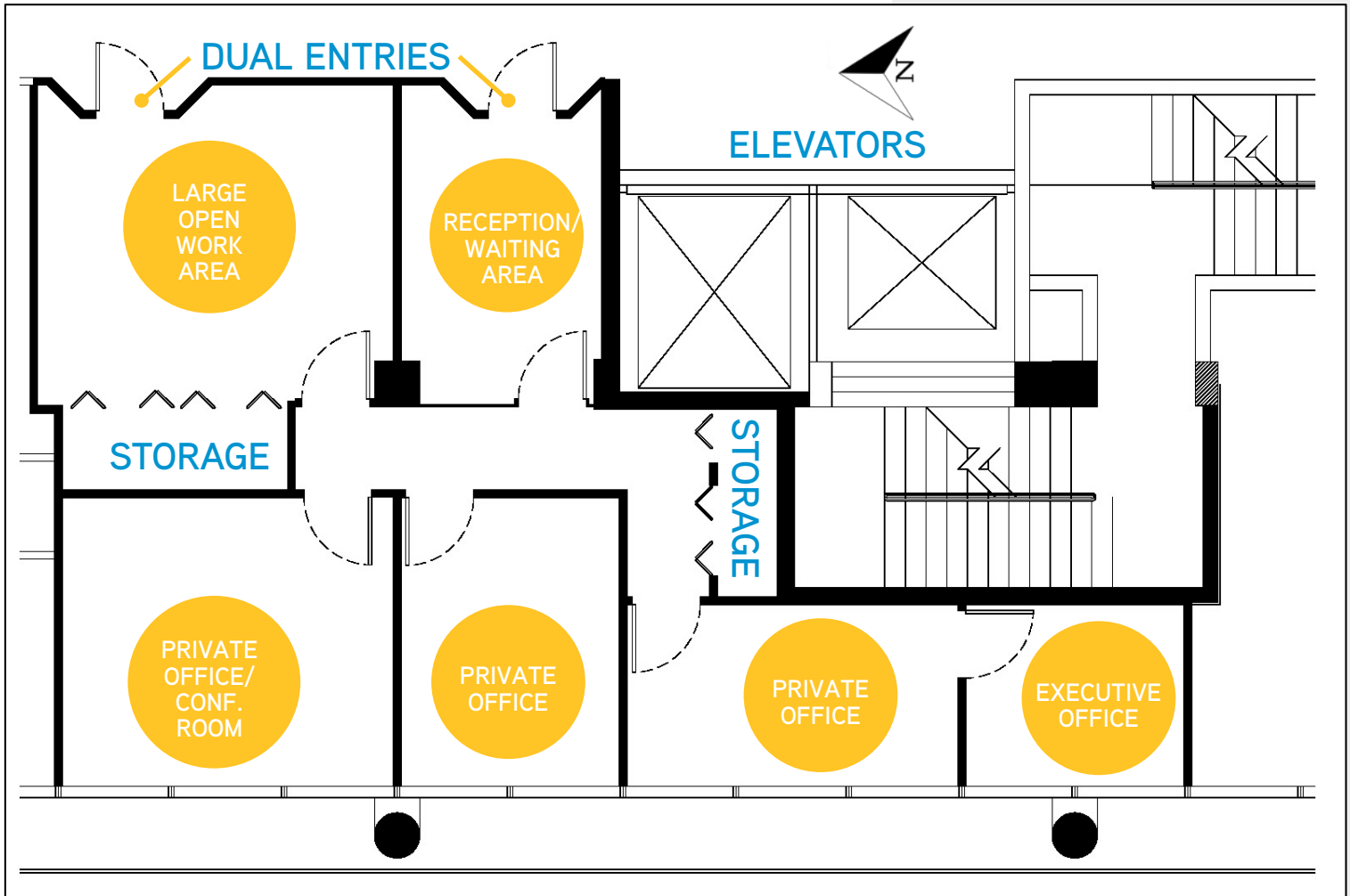

Contact

JONATHAN KINGSLEY

+ 1 305 785 2665

jonathan.kingsley@colliers.com

www.oneturnberryaventura.com



COLLIERS INTERNATIONAL
SOUTH FLORIDA, LLC
200 E Broward Blvd., Suite 120
Ft. Lauderdale, FL 33031

ONE TURNBERRY PLACE

FLOOR PLAN – SUITE 801

2,533 RSF

EXTRAORDINARY SPACE >

OUTSTANDING VIEWS, IMPRESSIVE CORNER OFFICE,
LARGE CONFERENCE ROOM, MULTIPLE EXECUTIVE
AND INTERIOR OFFICES

BREAK ROOM

RECEPTION
AREA

801

CONFERENCE
ROOM

MULTIPLE
INTERIOR
OFFICES



Contact

JONATHAN KINGSLEY

+ 1 305 785 2665

jonathan.kingsley@colliers.com

www.oneturnberryaventura.com



COLLIERS INTERNATIONAL
SOUTH FLORIDA, LLC
200 E Broward Blvd., Suite 120
Ft. Lauderdale, FL 33031