

# FOR LEASE

## 192,000 SF Industrial Space Available for Lease

**WORLD PARK BLDG 25 | 9756 International Blvd. Cincinnati | Ohio**

### FEATURES

- 192,000 total SF available
- 182,031 SF warehouse
- 9,969 SF office
- 12,800 SF Bay
- Built in 1990
- Sprinkler System - 100,000 SF ESFR
- Parking for 180+ cars
- 24' ceiling heights
- 40' x 40' column spacing
- 12.704 acres
- 1 drive-in door (10' x 14')
- 28 dock doors (16 w/levelers)
- 320' building depth
- Pre-cast concrete, conventional steel
- High pressure sodium & metal halide lighting
- HVAC (office only) & gas unit heaters

Lease Rate:

**\$3.95** / SF



### Contact us:

**John B. Gartner, III, SIOR**

Brokerage Senior Vice President

+1 513 562 2207

[john.gartner@colliers.com](mailto:john.gartner@colliers.com)

**Erin M. Casey, GA-C, MICP™**

Brokerage Senior Vice President

+1 513 562 2225

[erin.casey@colliers.com](mailto:erin.casey@colliers.com)



Colliers International  
425 Walnut Street | Suite 1200  
Cincinnati, Ohio 45202  
P: +1 513 721 4200

This document has been prepared by Colliers International for advertising and general information only. Colliers International makes no guarantees, representations or warranties of any kind, expressed or implied, regarding the information including, but not limited to, warranties of content, accuracy and reliability. Any interested party should undertake their own inquiries as to the accuracy of the information. Colliers International excludes unequivocally all inferred or implied terms, conditions and warranties arising out of this document and excludes all liability for loss and damages arising there from. This publication is the copyrighted property of Colliers International and/or its licensor(s). ©2018. All rights reserved.

## AVAILABLE

- OFFICE AREA - 9,969 S.F.
- WAREHOUSE - 182,031 S.F.
- (28) 8' x 9' DOCK DOORS  
(16) W/ LEVELERS
- (1) 10 x 14 DRIVE IN DOOR
- BAY SIZE 40'-0" x 40'-0"
- CLEAR HEIGHT 24'-0"
- EXISTING RESTROOMS
- AMPLE PARKING

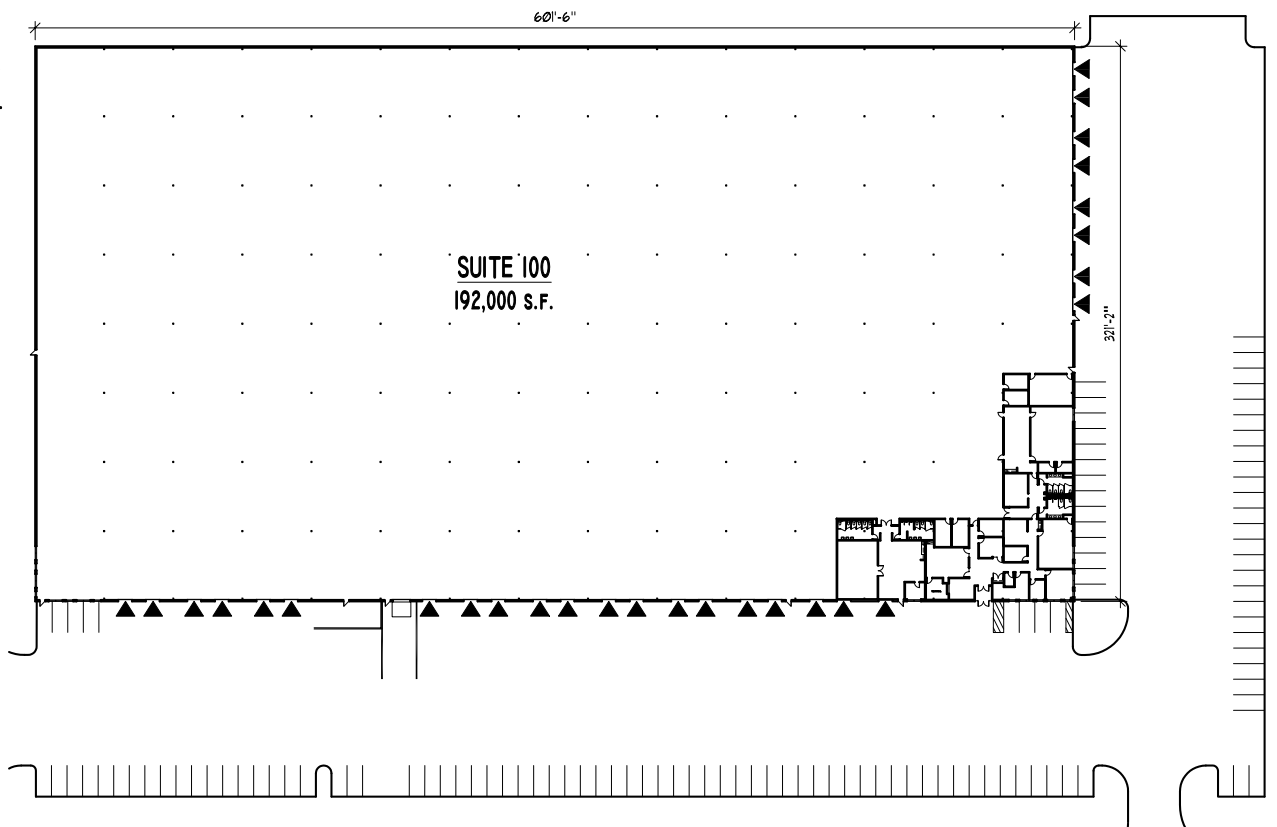

SITE PLAN



AERIAL

**John B. Gartner, III, SIOR**

Brokerage Senior Vice President  
+1 513 562 2207  
john.gartner@colliers.com

**Erin M. Casey, GA-C, MICP™**

Brokerage Senior Vice President  
+1 513 562 2225  
erin.casey@colliers.com



Accelerating success.



## Specifications

### LOCATION

|            |              |
|------------|--------------|
| City (CDP) | West Chester |
| County     | Butler       |
| Zoning     | M-2          |

### SITE

|                 |                 |
|-----------------|-----------------|
| Truck Court     | 120' Minimum    |
| Auto Parking    | 180             |
| Trailer Parking | Up to 16 spaces |

### UTILITIES

|           |                 |
|-----------|-----------------|
| Water     | Butler County   |
| Sewer     | Butler County   |
| Gas       | Duke Energy     |
| Electric  | Duke Energy     |
| Telephone | Cincinnati Bell |

### PRICING

|                    |               |
|--------------------|---------------|
| Lease Rate         | \$3.95/SF NNN |
| Operating Expenses | \$1.20/SF     |

### BUILDING

|                     |  |
|---------------------|--|
| Total Building Area | 192,000 SF   |
| Overall Dimensions  | 600' wide x 320' depth   |
| Office Area         | 9,969 +/- SF   |
| Type Construction   | Pre-Cast concrete, conventional steel  |
| Clear Height        | 24'  |
| Roof Type           | Rubber membrane with stone ballast   |
| Floor Thickness     | 7" concrete slab   |
| Floor Sealer        | Ashford Formula  |
| Bay Sizes           | 40' x 40' typical bays   |
| Dock Doors          | 28 (16 with leverlers)   |
| Drive-In Doors      | One (1) 10' x 14'  |
| Power               | 1,200 Amps/480 Volt/3 Phase (expandable)   |
| Fire Protection     | Partial ESFR System  |
| Warehouse Lighting  | T-5 Lighting   |
| Warehouse Heat      | 80/20 Rooftop Units designed for 55° indoor temperatures at 0° out door temperatures |

Contact us:

**John B. Gartner, III, SIOR**

Brokerage Senior Vice President

+1 513 562 2207

john.gartner@colliers.com

**Erin M. Casey, GA-C, MICP™**

Brokerage Senior Vice President

+1 513 562 2225

erin.casey@colliers.com



Accelerating success.



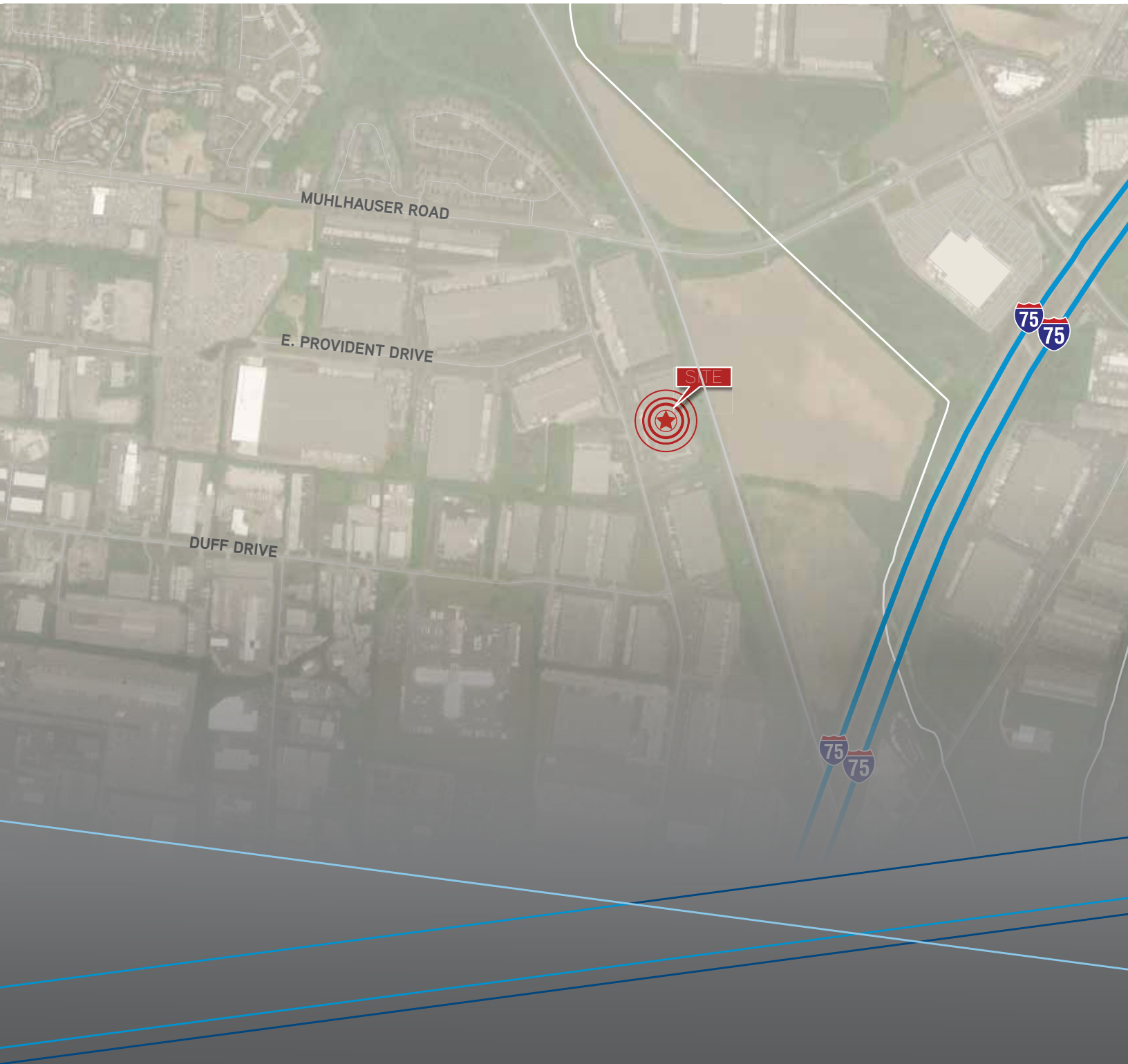

John B. Gartner, III, SIOR  
Brokerage Senior Vice President  
+1 513 562 2207  
[john.gartner@colliers.com](mailto:john.gartner@colliers.com)

Erin M. Casey, GA-C, MICP™  
Brokerage Senior Vice President  
+1 513 562 2225  
[erin.casey@colliers.com](mailto:erin.casey@colliers.com)

Colliers International  
425 Walnut Street | Suite 1200  
Cincinnati, Ohio 45202  
P: +1 513 721 4200

## Accelerating success.

This document has been prepared by Colliers International for advertising and general information only. Colliers International makes no guarantees, representations or warranties of any kind, expressed or implied, regarding the information including, but not limited to, warranties of content, accuracy and reliability. Any interested party should undertake their own inquiries as to the accuracy of the information. Colliers International excludes unequivocally all inferred or implied terms, conditions and warranties arising out of this document and excludes all liability for loss and damages arising there from. This publication is the copyrighted property of Colliers International and/or its licensor(s). ©2018. All rights reserved.