

FOR SALE OR LEASE > OFFICE

THE VILLAGE AT SWIFT CREEK

5001-5161 CRAIG RATH BOULEVARD | MIDLOTHIAN, VIRGINIA 23112



PROPERTY FEATURES

- > Owner offering aggressive sale and lease terms
- > Four contemporary one-story office buildings
- > 2,525 SF - 6,444 SF available for lease
- > Ample parking suitable for medical & office uses
- > Zoned C-3
- > Monument signage available
- > Located in high growth corridor
- > Standard finishes
- > Call agent for more information
- > **PLEASE [CLICK HERE FOR CONFIDENTIALITY AGREEMENT TO RECEIVE OFFERING MEMORANDUM](#)**



AGENT: CHRIS WALLACE
804 591 2424
RICHMOND, VA
chris.wallace@colliers.com

AGENT: ERIC WILLIFORD
804 591 2410
RICHMOND, VA
eric.williford@colliers.com

COLLIERS INTERNATIONAL
7200 Glen Forest Drive, Suite 200
Richmond, VA 23226
www.colliers.com/richmond

FOR SALE OR LEASE > OFFICE

THE VILLAGE AT SWIFT CREEK

5001-5161 CRAIG RATH BOULEVARD | MIDLOTHIAN, VIRGINIA 23112

Colliers
INTERNATIONAL



Building 1 - Floor Plan

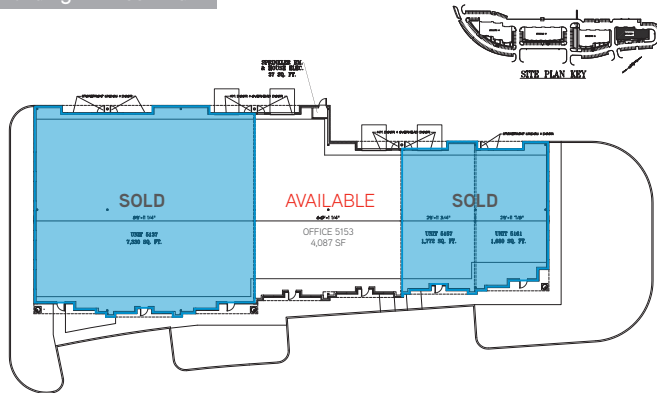

Building 2 - Floor Plan

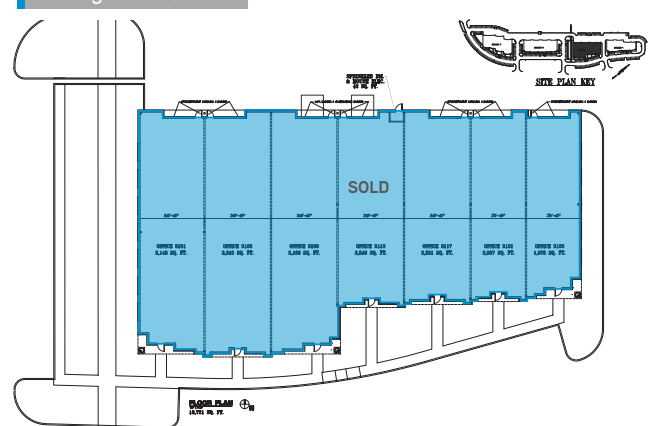

Building 3 - Floor Plan

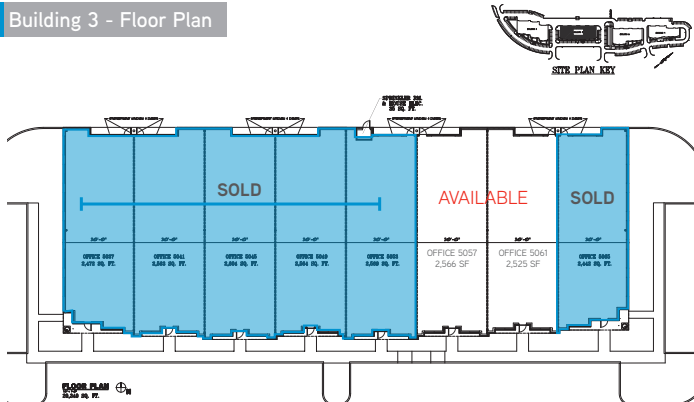

Building 4 - Floor Plan

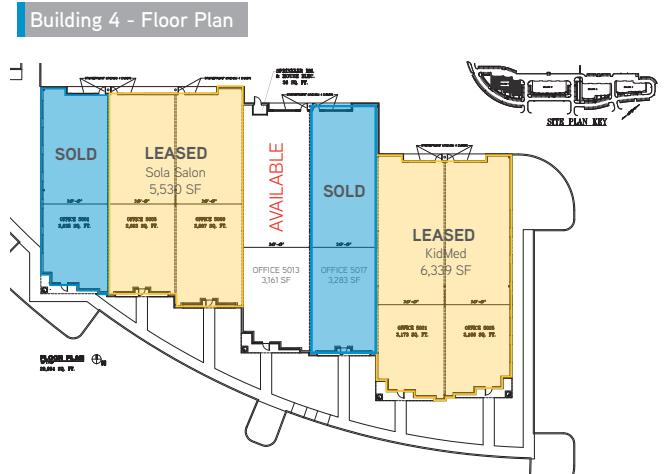

AGENT: CHRIS WALLACE
804 591 2424
RICHMOND, VA
chris.wallace@colliers.com

AGENT: ERIC WILLIFORD
804 591 2410
RICHMOND, VA
eric.williford@colliers.com

COLLIERS INTERNATIONAL
7200 Glen Forest Drive, Suite 200
Richmond, VA 23226
www.colliers.com/richmond

FOR SALE OR LEASE > OFFICE

THE VILLAGE AT SWIFT CREEK

Colliers
INTERNATIONAL

5001-5161 CRAIG RATH BOULEVARD | MIDLOTHIAN, VIRGINIA 23112

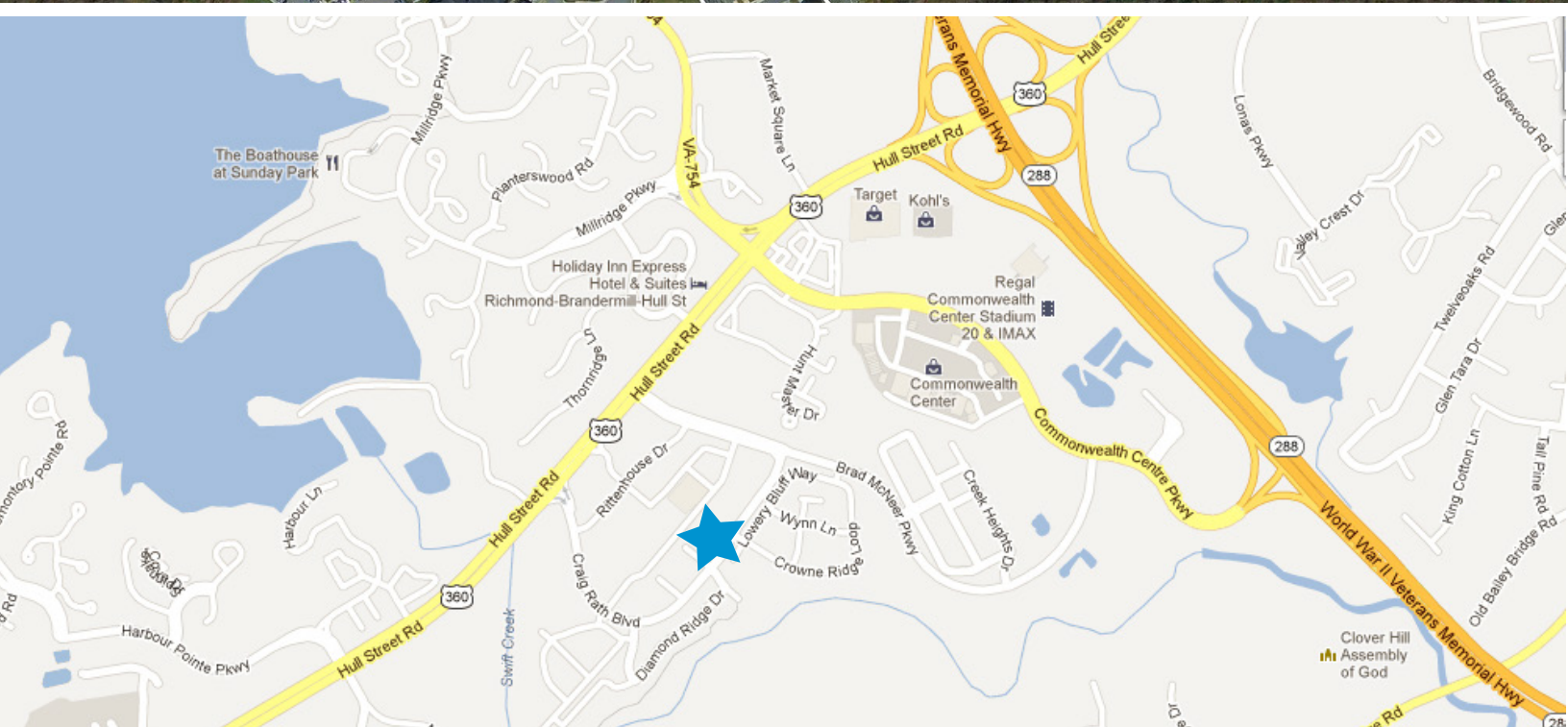

The information contained herein was obtained from sources, believed reliable, however, Colliers International makes no guarantees, warranties or representations as to the completeness or accuracy thereof. The presentation of this property is submitted subject to errors, omissions, change of price or conditions prior to sale or lease, or withdrawal without notice.
File Name: SwiftCreek_Lease rev 4-24-18