

**FOR
LEASE**

1213-1217 1ST STREET SOUTH

CORE DOWNTOWN RETAIL | NAMPA, ID



PROPERTY INFORMATION

Property Type:	Retail
Building Size:	24,000 SF
NNN's:	\$3.50 PSF
Parking:	Downtown

SPACE AVAILABLE

Suite	Size	Rate
1213	2,070 SF	\$15.00 PSF NNN
1215	2,065 SF	\$14.00 PSF NNN
1217	1,245 SF	\$15.00 PSF NNN

HIGHLIGHTS

- » Prime downtown Nampa space with exposed brick
- » Located on highly desirable stretch of 1st Street
- » Great opportunities for restaurant space
- » Join 2C Family Brewing and Labyrinth Escape Rooms
- » Basement storage possible

Colliers
INTERNATIONAL

LINCOLN HAGOOD
208 472 1667
lincoln.hagood@colliers.com

BRYANT JONES
208 472 1663
bryant.jones@colliers.com

MIKE PEÑA
208 472 1666
mike.pena@colliers.com

V021218

Colliers International Idaho | 755 West Front Street, Suite 300 Boise, Idaho 83702 | www.colliers.com/boise | 208 345 9000

This document has been prepared by Colliers International for advertising and general information only. Colliers International makes no guarantees, representations or warranties of any kind, expressed or implied, regarding the information including, but not limited to, warranties of content, accuracy and reliability. Any interested party should undertake their own inquiries as to the accuracy of the information. Colliers International excludes unequivocally all inferred or implied terms, conditions and warranties arising out of this document and excludes all liability for loss and damages arising there from. This publication is the copyrighted property of Colliers International and/or its licensor(s). ©2016. All rights reserved

1213-1217 1ST STREET SOUTH

CORE DOWNTOWN RETAIL | NAMPA, ID

Demographics	1 Mile	3 Miles	5 Miles
2017 Estimated Population	15,162	83,652	116,005
Proj. Ann. Growth 2017-2022	2.7%	2.3%	2.2%
2017 Est. Avg HH Income	\$40,697	\$52,034	\$55,840

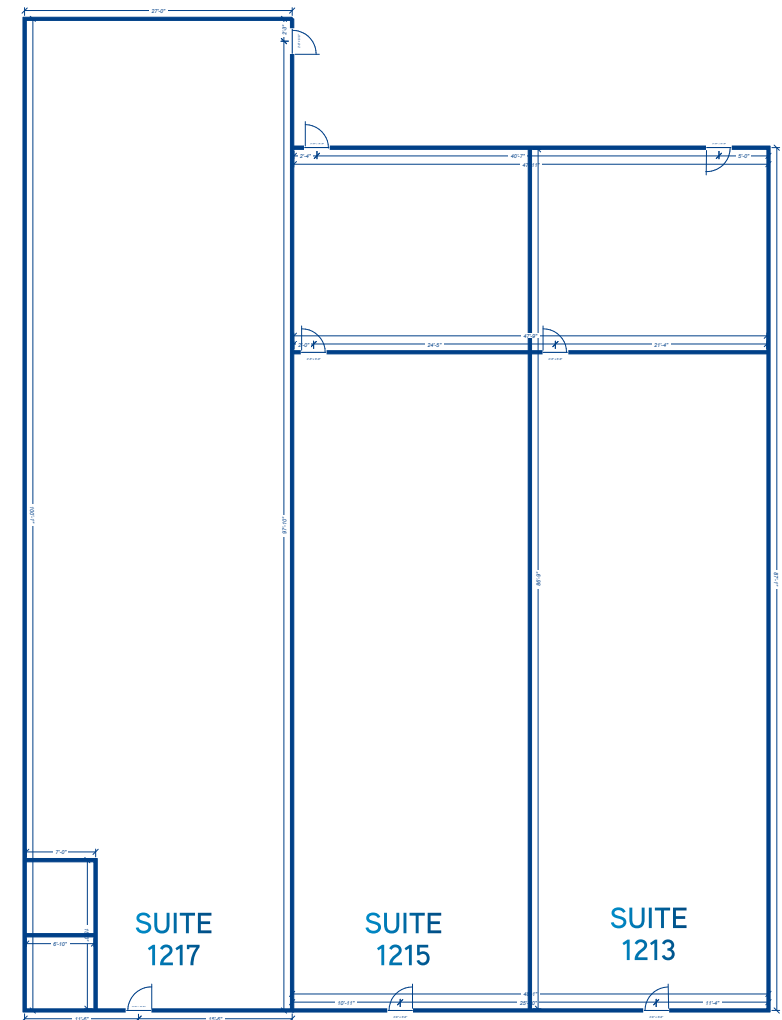

MIKE PEÑA
208 472 1666
mike.pena@colliers.com