

**FOR  
LEASE**

**1509 N 13TH STREET**

HYDE PARK—NORTH END | BOISE, ID



## PROPERTY INFORMATION

Property Type:	Retail - Restaurant
Address(s):	1310 W Alturas St., 1509 N 13th St.
Building Size:	4,224 SF
Land Size:	0.26 Acres (2 parcels)
Parking:	7 spots and additional lot
Zoning:	C-1CHD
Lease Type:	NNN
Lease Rate:	Contact Agent

## HIGHLIGHTS

- » Prime opportunity in the heart of the Hyde Park restaurant/retail neighborhood.
- » 7 parking spots along the building, with an additional lot across the alley on W. Alturas
- » Retail component has 12' ceilings with large skylights that provide lots of natural light
- » Multitude of possibilities including restaurant, retail, fitness, professional services
- » TI Allowance available
- » Contact Agent for details



**JAMIE ANDERSON**  
208 472 2842  
jamie.anderson@colliers.com

**MIKE CHRISTENSEN**  
208 472 2866  
mike.christensen@colliers.com



**FOR  
LEASE**

**1509 N 13TH STREET**  
HYDE PARK—NORTH END | BOISE, ID



Floorplans are approximate and not the result of engineering survey, for representation purposes only

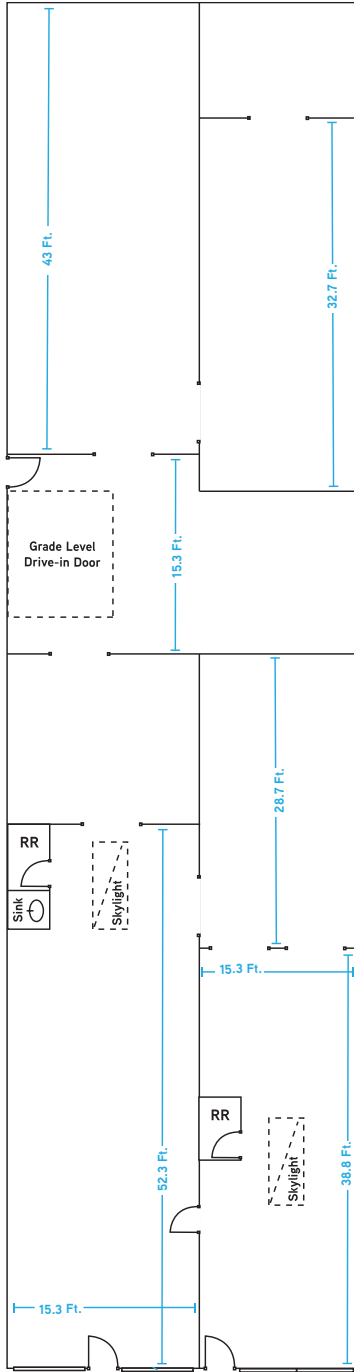

**JAMIE ANDERSON**  
208 472 2842  
jamie.anderson@colliers.com

**MIKE CHRISTENSEN**  
208 472 2866  
mike.christensen@colliers.com



**FOR  
LEASE**

**1509 N 13TH STREET**  
HYDE PARK—NORTH END | BOISE, ID

**Colliers**  
INTERNATIONAL



**JAMIE ANDERSON**  
208 472 2842  
[jamie.anderson@colliers.com](mailto:jamie.anderson@colliers.com)

**MIKE CHRISTENSEN**  
208 472 2866  
[mike.christensen@colliers.com](mailto:mike.christensen@colliers.com)



**FOR  
LEASE**

**1509 N 13TH STREET**  
HYDE PARK—NORTH END | BOISE, ID

**Colliers**  
INTERNATIONAL



**JAMIE ANDERSON**  
208 472 2842  
jamie.anderson@colliers.com

**MIKE CHRISTENSEN**  
208 472 2866  
mike.christensen@colliers.com