



For Lease

Office Space For Lease

3520 Lake Ave, Wilmette, IL 60091

\$25.00 sf MG

Introducing a prime leasing opportunity at 3520 Lake Ave, Wilmette, IL. For Lease: 1,402 sf turnkey, 2nd-floor office space available with three privates and elevator. Wilmette Center sits adjacent to Eden's Expressway with easy access heading North or South. Lake Av. sees almost 22k VPD. Retail tenants include Starbucks, Jimmy John's, and Kenny the Kleener.

Contact us:

Brad Belden

Senior Vice President

847 698 8232

Brad.Belden@colliers.com

Zach Ofner

Associate

847 444 5704

Zach.Ofner@Colliers.com

This document/email has been prepared by Colliers for advertising and general information only. Colliers makes no guarantees, representations or warranties of any kind, expressed or implied, regarding the information including, but not limited to, warranties of content, accuracy and reliability. Any interested party should undertake their own inquiries as to the accuracy of the information. Colliers excludes unequivocally all inferred or implied terms, conditions and warranties arising out of this document and excludes all liability for loss and damages arising there from. This publication is the copyrighted property of Colliers and /or its licensor(s). © 2022. All rights reserved.

Colliers

www.colliers.com/en/countries/united-states/cities/chicago/chicago-retail-sales-and-leasing-team

Executive Summary



Offering Summary

Lease Rate:	\$25.00 SF MG
Building Size:	9,302 SF
Available SF:	1,402 SF
Lot Size:	27,500 SF
Number of Units:	6
Year Built:	1980
Renovated:	2007
Zoning:	B-2
Market:	Chicago

Property Overview

Introducing a prime leasing opportunity at 3520 Lake Ave, Wilmette, IL. Turnkey, 2nd-floor office space available with 3 privates and elevator. Retail tenants include Starbucks, Jimmy John's, and Kenny the Kleener!

Property Highlights

- 1,402 sf turnkey office space
- Elevator Access
- On-site Parking
- Close Proximity to Eden's Expressway
- Over 21,700 VPD on Lake Avenue
- Average Household Income Over \$210,986 in 3-Mile Radius

Brad Belden
Senior Vice President
847 698 8232
Brad.Belden@colliers.com

Zach Ofner
Associate
847 444 5704
Zach.Ofner@Colliers.com

For Lease 3520 Lake Ave, Wilmette, IL 60091

[View Online](#)

[Take A Tour](#)

Office Photos



Brad Belden
Senior Vice President
847 698 8232
Brad.Belden@colliers.com

Zach Ofner
Associate
847 444 5704
Zach.Ofner@Colliers.com



Site Plans

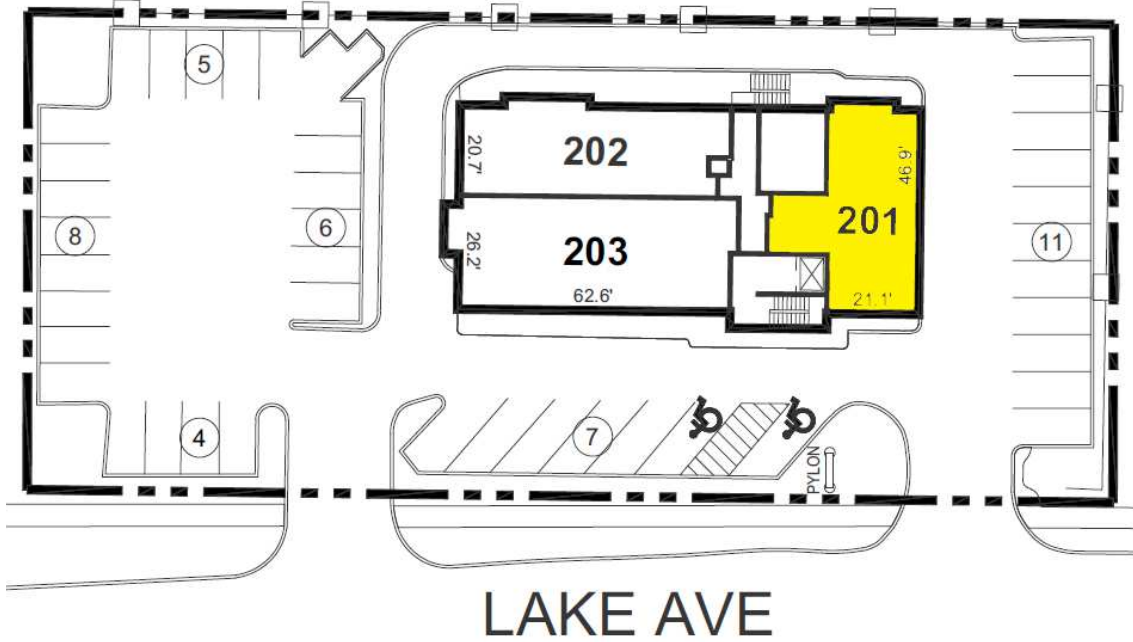

TENANT INDEX		
201	AVAILABLE	1,402
202	MA CAPITAL FUND	1,502
203	THE BOULDER GROUP	1,860

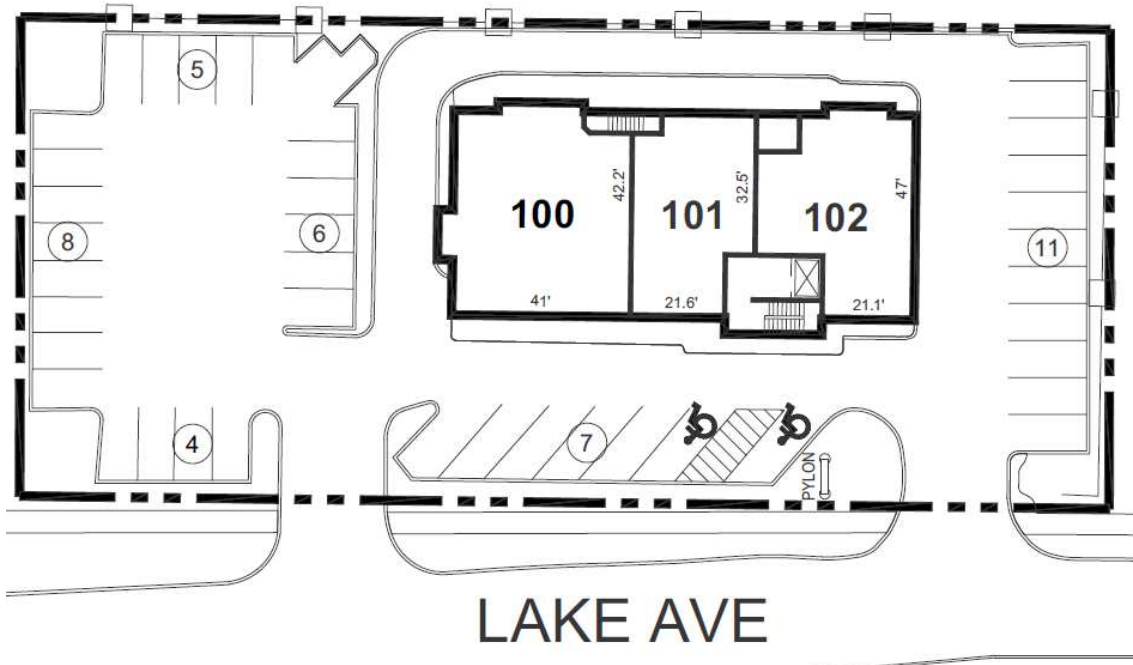

100	STARBUCKS	1,954
101	JIMMY JOHN'S	1,204
102	KENNY THE KLEENER	1,380

Brad Belden
 Senior Vice President
 847 698 8232
 Brad.Belden@colliers.com

Zach Ofner
 Associate
 847 444 5704
 Zach.Ofner@Colliers.com



Entryway / Common Area



Brad Belden
Senior Vice President
847 698 8232
Brad.Belden@colliers.com

Zach Ofner
Associate
847 444 5704
Zach.Ofner@Colliers.com

Area Tenants



Brad Belden
Senior Vice President
847 698 8232
Brad.Belden@colliers.com

Zach Ofner
Associate
847 444 5704
Zach.Ofner@Colliers.com

Location Map

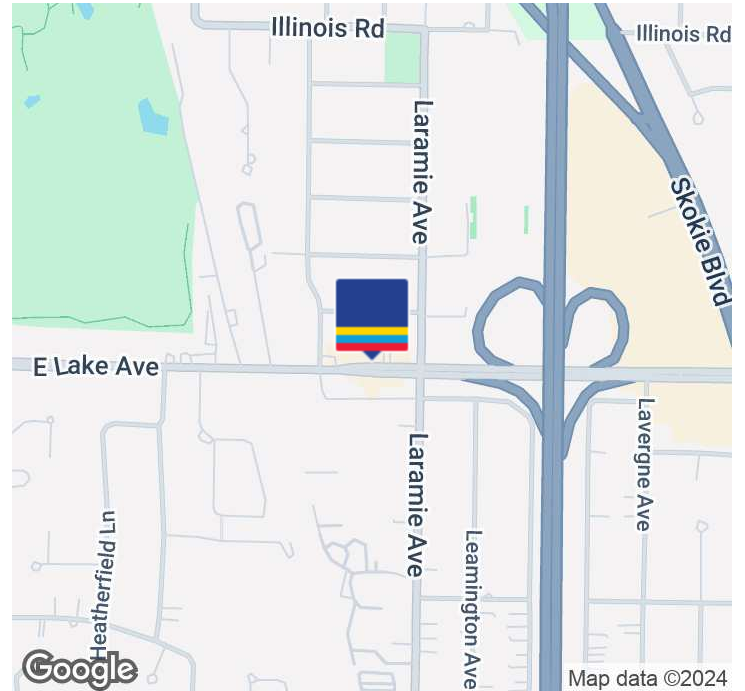
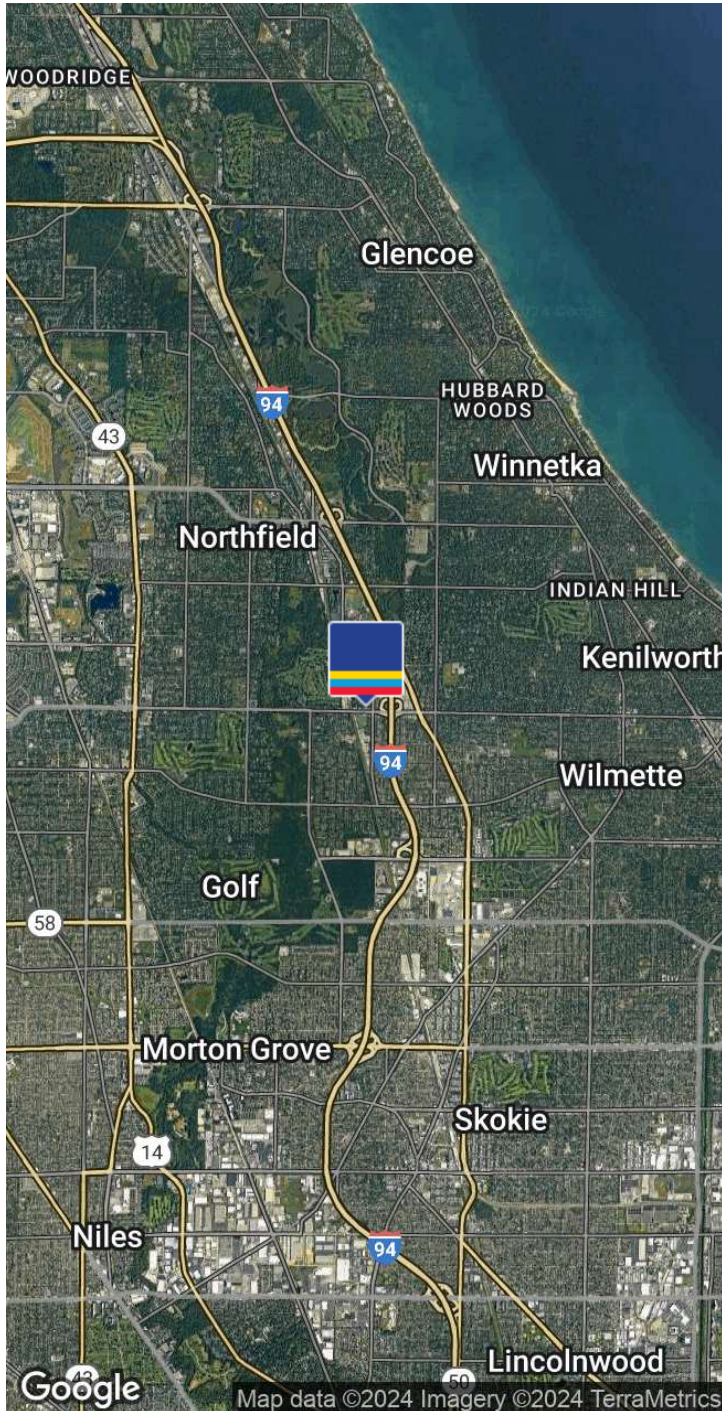

Location Overview

Wilmette, a charming village in Cook County, Illinois, is located about 14 miles north of downtown Chicago. As part of the prestigious North Shore, Wilmette features picturesque residential neighborhoods and a bustling downtown area. Known for its excellent schools and beautiful lakefront parks, Wilmette offers a blend of suburban tranquility and vibrant community life along the shores of Lake Michigan.

Brad Belden

Senior Vice President

847 698 8232

Brad.Belden@colliers.com

Zach Ofner

Associate

847 444 5704

Zach.Ofner@Colliers.com

Demographics

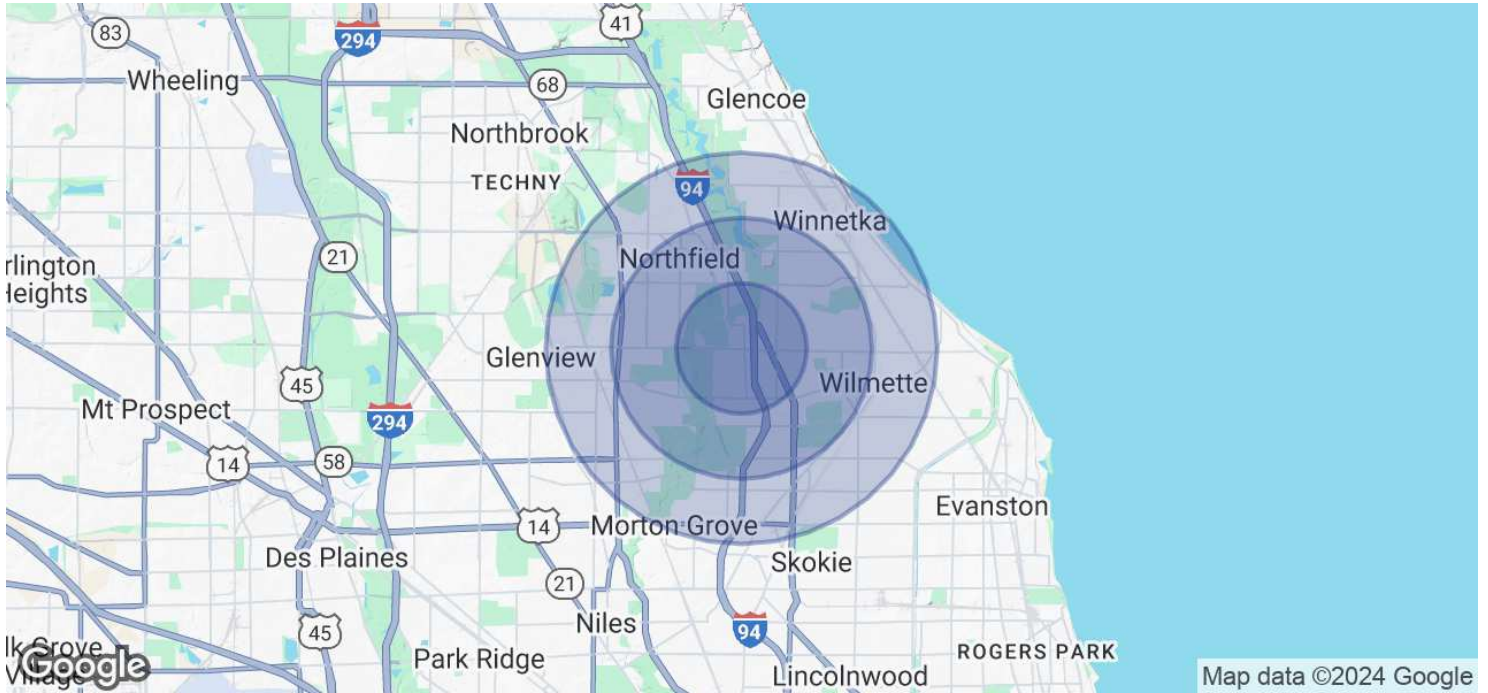

Population	1 Mile	2 Miles	3 Miles
Total Population	8,834	35,321	105,234
Average Age	44	43	43
Average Age (Male)	42	42	41
Average Age (Female)	45	44	44
Households & Income	1 Mile	2 Miles	3 Miles
Total Households	3,132	12,982	37,785
# of Persons per HH	2.8	2.7	2.8
Average HH Income	\$209,895	\$219,446	\$203,219
Average House Value	\$765,884	\$862,355	\$799,918

Demographics data derived from AlphaMap

Brad Belden
Senior Vice President
847 698 8232
Brad.Belden@colliers.com

Zach Ofner
Associate
847 444 5704
Zach.Ofner@Colliers.com