

FOR LEASE > INDUSTRIAL SPACE



3200 Haskell Lane, Suite 140

LAWRENCE, KANSAS



Property Features

Located near the signaled intersection of East 31st Street and Haskell Avenue in an industrial office area, with easy access to the South Lawrence Trafficway.

Available Suite

Suite 140

- > Suite Size: 3,520 SF
- > Lease price: \$2,500 per month, gross
- > Half office, half warehouse with 14' ceiling, drive-in door, and one dock door
- > Includes lobby/reception area, four private offices, conference room, breakroom, and restroom

KIRSTEN FLORY
+1 785 865 3821
LAWRENCE, KS
kirsten.flory@colliers.com

MARILYN BITTENBENDER SIOR, CCIM
+1 785 865 3562
LAWRENCE, KS
marilyn.bittenbender@colliers.com

COLLIERS INTERNATIONAL
805 New Hampshire, Suite C
Lawrence, KS 66044
www.colliers.com

3200 Haskell Lane > Floorplan

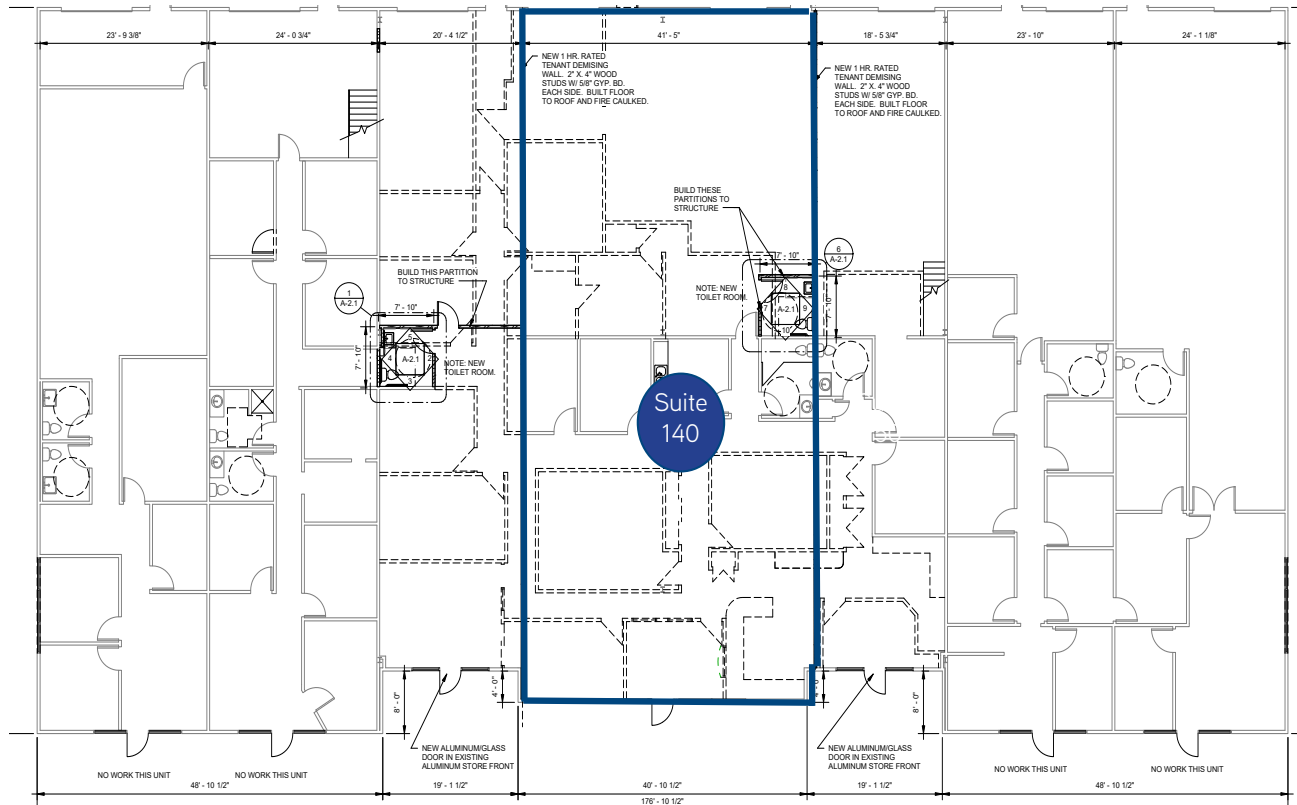

KIRSTEN FLORY
+1 785 865 3821
LAWRENCE, KS
kirsten.flory@colliers.com

MARILYN BITTENBENDER SIOR, CCIM
+1 785 865 3562
LAWRENCE, KS
marilyn.bittenbender@colliers.com

COLLIERS INTERNATIONAL
805 New Hampshire, Suite C
Lawrence, KS 66044
www.colliers.com

This document has been prepared by Colliers International for advertising and general information only. Colliers International makes no guarantees, representations or warranties of any kind, expressed or implied, regarding the information including, but not limited to, warranties of content, accuracy and reliability. Any interested party should undertake their own inquiries as to the accuracy of the information. Colliers International excludes unequivocally all inferred or implied terms, conditions and warranties arising out of this document and excludes all liability for loss and damages arising there from. This publication is the copyrighted property of Colliers International and/or its licensor(s). ©2018. All rights reserved.

