

FOR LEASE

Class A Office Building
5595 Kietzke Lane
Reno, NV 89511

Property Summary:

Executive Centre is well located in the Meadowood Submarket offering Class A office options for smaller tenants. Within close proximity to numerous retailers, eateries, and other professional office buildings. This is suitable location for a variety of professionals office users. Excellent access to I-580 at Neil Road.

Property Highlights:

- › Professional Class A work environment
- › Easily accessible location
- › Common Conference Room
- › Full Service lease rate

Reno Office Services

LANDON GONZALEZ
ASSOCIATE
DIRECT: +1 775 823 4663
CELL: +1 775 741 6397
Landon.Gonzalez@colliers.com



Colliers International
5520 Kietzke Lane, Suite 300
Reno, Nevada 89511
P: +1 775 823 9666 | F: +1 775 823 4699
www.colliers.com/reno



Available Spaces:

- **Suite 106:** \$550/Month (217 SF)
- **Suite 110C:** \$635/Month (253 SF)
- **Suite 110F:** \$415/Month (165 SF)
- **Suite 113:** \$1,750/Month (760 SF)
- **Suite 117:** \$2,750/Month (1,222 SF)

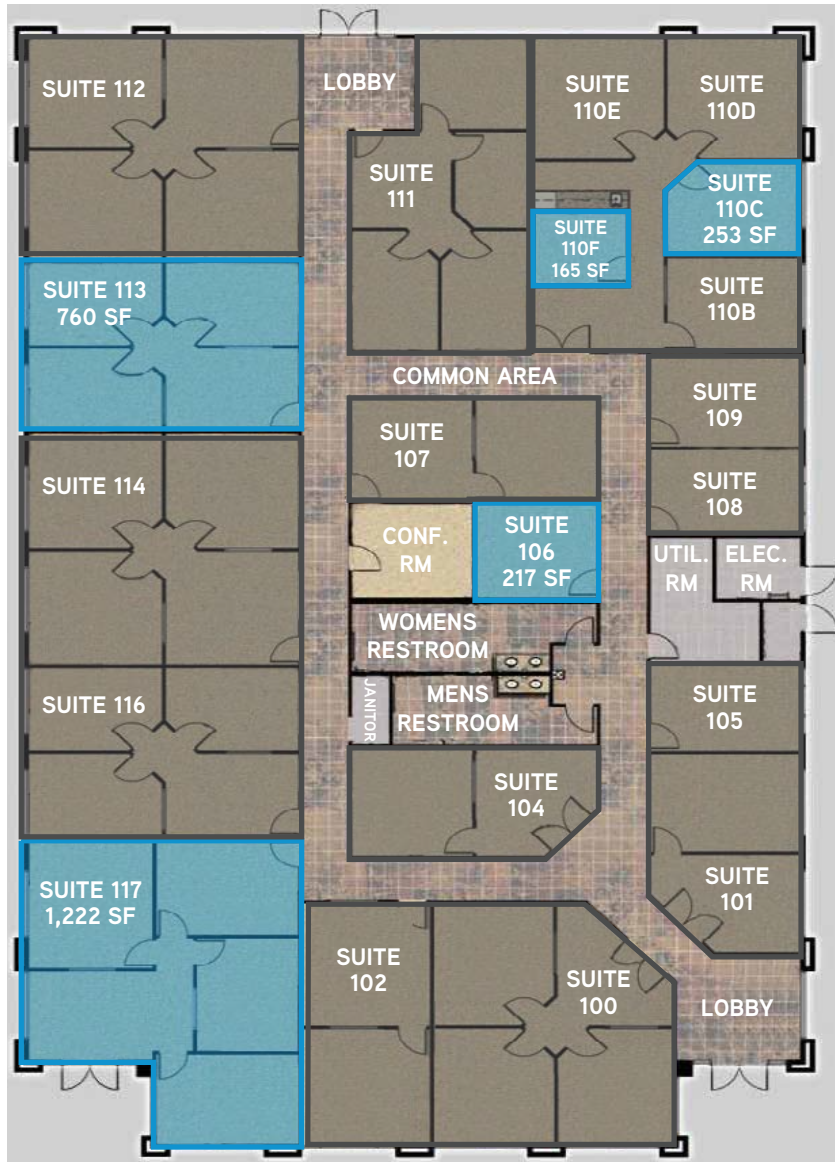

Available

Leased

