

## FOR LEASE ▶ SANTA CLARA INDUSTRIAL CENTER

### 1240 Memorex Drive, Santa Clara, CA

- 5,773 Square Feet
- ±700 SF Office
- 1 Grade Level Doors
- 19' Clear Height
- 1.5 Ton Crane
- Fire Sprinklered
- ML - Light Industrial Zoning
- Santa Clara Utilities
- \$0.11 / SF CAM
- 800 AMPS@277/480 Volt
- \$1.35 I GROSS
- Call to Tour

### OWNER WILL CONSIDER "H RATED" OCCUPANCIES

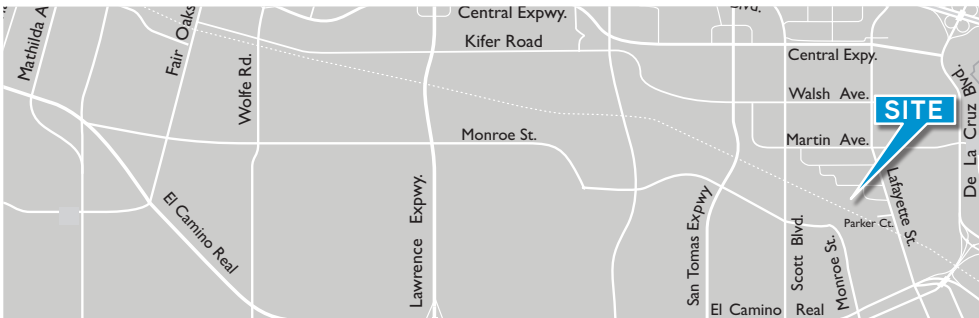

#### Steve Zamudio, ccm

Executive Vice President  
+1 408 282 3824  
steve.zamudio@colliers.com  
CA License No. 00905956

#### Dave Evans

Senior Vice President  
+1 408 282 3825  
david.evans@colliers.com  
CA License No. 00764837

Colliers International  
225 West Santa Clara Street  
10th Floor, Suite 1000  
San Jose, CA 95113  
P: +1 408 282 3800



Accelerating success.

# SANTA CLARA INDUSTRIAL CENTER 1240 Memorex Drive | Santa Clara, CA

## Floor Plan

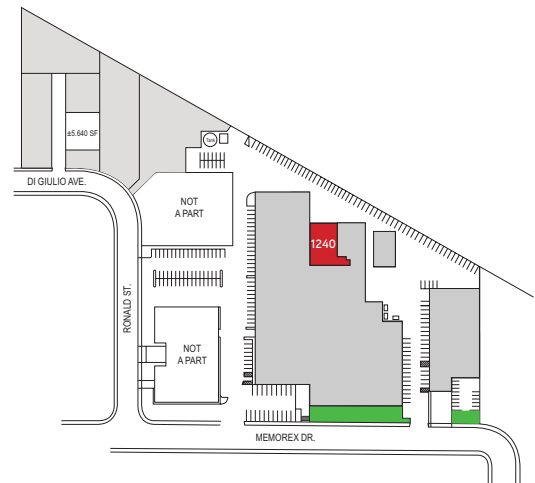
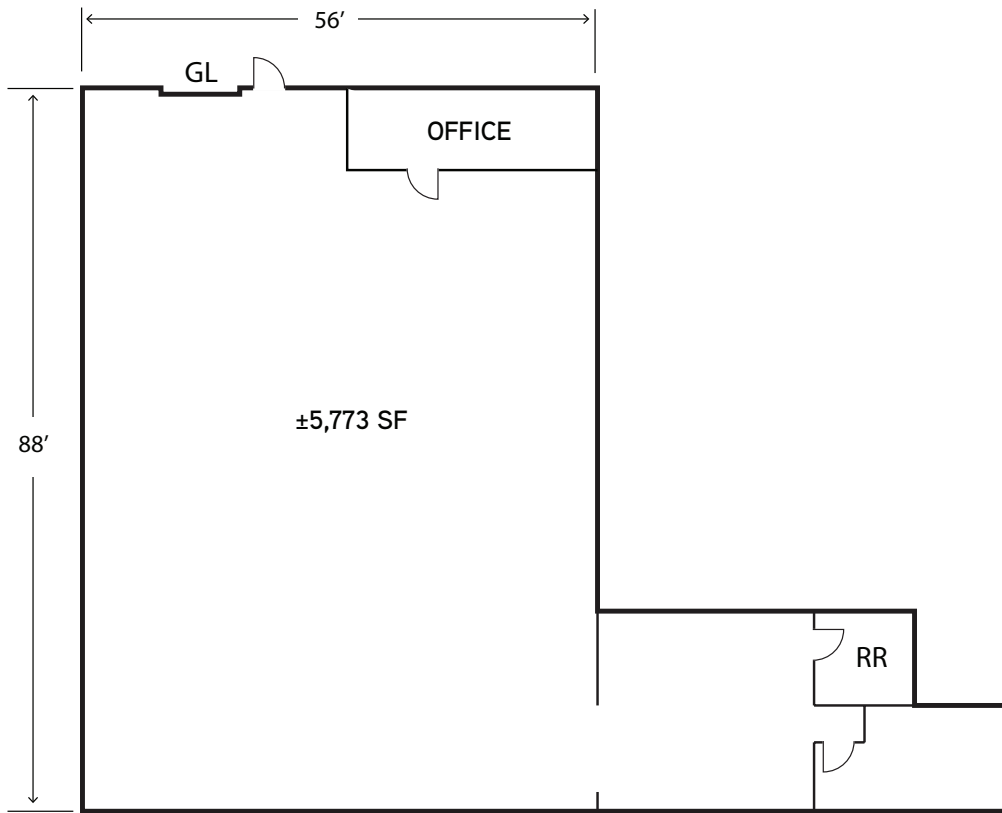

**Steve Zamudio, ccim**  
Executive Vice President  
+1 408 282 3824  
steve.zamudio@colliers.com  
CA License No. 00905956

**Dave Evans**  
Senior Vice President  
+1 408 282 3825  
david.evans@colliers.com  
CA License No. 00764837

**Colliers International**  
225 West Santa Clara Street  
10th Floor, Suite 1000  
San Jose, CA 95113  
P: +1 408 282 3800



Accelerating success.