



TALLAHASSEE

510 W VIRGINIA STREET
TALLAHASSEE, FL 32301



JASON HURST
+1 352 256 6714
jason.hurst@colliers.com

WHITNEY SPANGLER
+1 404 574 1046
whitney.spangler@colliers.com

Colliers
INTERNATIONAL

TALLAHASSEE FLORIDA

STATE CAPITAL
OF FLORIDA

\$68,943
MEDIAN FAMILY INCOME

\$14.2 B
GDP

379,627
PEOPLE IN THE
TALLAHASSEE MSA

2.4 M
ANNUAL VISITORS

23RD
MOST HIGHLY POPULATED
STATE CAPITAL IN AMERICA

DEMOGRAPHICS

	1 MILE	3 MILE	5 MILE
Total Population	18,808	103,163	173,149
Total Households	5,757	42,064	72,347
Avg HH Income	\$31,548	\$44,482	\$52,066
# of Employees	53,521	110,426	183,557
Daytime Population	92,995	214,425	304,838

FLORIDA STATE UNIVERSITY

#26
TOP PUBLIC UNIVERSITIES
IN THE UNITED STATES

\$841.3 M
TOTAL ECONOMIC IMPACT
CREATED FROM FSU VISITORS
IN FISCAL YEAR 2016
(\$95.5 MILLION DURING FOOTBALL SEASON)

\$48.8 M
IN DIRECT SPENDING FROM
OUT-OF-TOWN ATTENDEES
DURING FOOTBALL SEASON



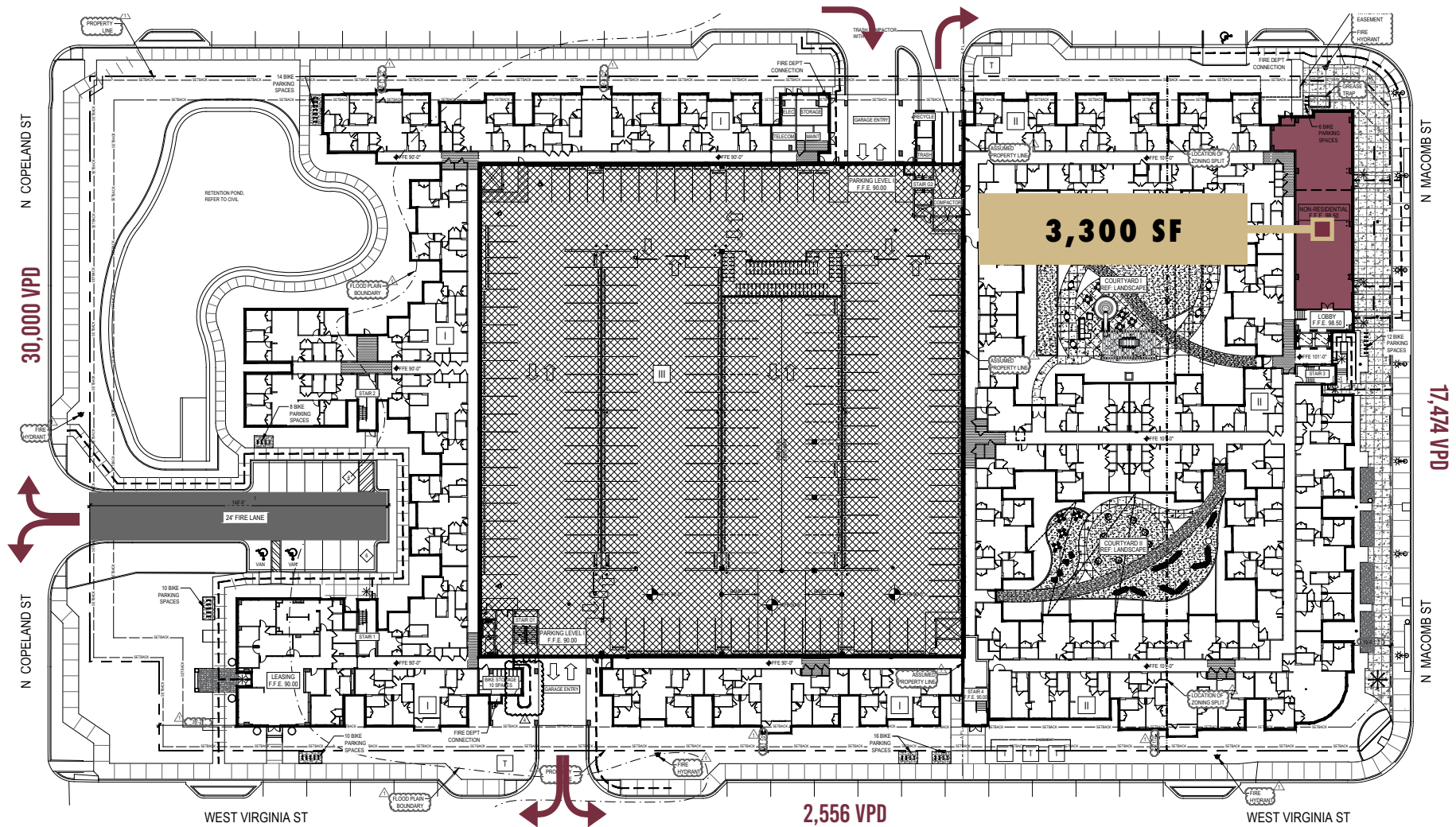

100% LEASED
FALL 2020

254 UNITS
876 BEDS

NOW PRE-LEASING
FOR FALL 2019